

**ODISHA CONSTRUCTION CORPORATION LIMITED**  
(A GOVT. OF ODISHA UNDERTAKING)  
**CENTRAL WORKSHOP, RASULGARH,**  
**BHUBANESWAR-751010 (ODISHA)**

\* \* \* \* \*

**TENDER DOCUMENT FOR**  
**“SUPPLY OF CASTING ITEMS FOR SERVICE GATE / EMERGENCY GATE FOR HR CUM DEPLETION**  
**SLUICE, 6T / 14T MOTORIZED SCREW HOIST FOR SERVICE / EMERGENCY GATE OF HR CUM**  
**DEPLETION SLUICE , TRASH RACK OF HR CUM DEPLETION SLUICE, RADIAL GATE FOR SPILLWAY AND**  
**ITS HOIST OF GHATAKESWAR MULTIPURPOSE PROJECT”**

The tender document comprises of the following:

1)	Tender call notice No. OCC/CWS/PROC/ GMP-01/ 48 /2023-24 dated.23.11.2023	01 (One) sheet
2)	Terms and conditions	04 (Four) sheets
3)	Drawings	50 ( Fifty) sheets
4)	Price schedule	05 (fIVE) sheet
----- Total :		60 (Sixty) sheets -----

**Signature of the tenderer or his/their  
power of attorney holder  
with designation & seal.**

**Senior Manager (Mech.)-I  
OCC Ltd, Central Workshop,  
Rasulgarh, Bhubaneswar-751010**

**ODISHA CONSTRUCTION CORPORATION LIMITED**  
(A GOVT. OF ODISHA UNDERTAKING)  
**CENTRAL WORKSHOP, RASULGARH,**  
**BHUBANESWAR-751010 (ODISHA)**

**TENDER CALL NOTICE No. OCC/CWS/PROC/ GMP-01 / 48 /2023-24 dated.23.11.2023**

Sealed tenders in conformity with the terms, conditions, drawing and technical specifications in tender documents are invited from reputed manufacturers / traders for **“Supply of casting items for Service gate / Emergency Gate for HR Cum depletion sluice, 6T / 14T motorized Screw Hoist for Service / Emergency gate of HR cum depletion sluice , trash rack of HR cum depletion sluice, radial gate for spillway and its hoist of Ghatakeswar Multipurpose Project”** as per details below:

Cost of tender document (Non-refundable)	Sale of tender document		Earnest money deposit (EMD) required	Receipt of tender	Opening of Technical & price bid of tender
<b>Rs. 4000/-</b> GST @ 18% <b>Rs.4720/-</b> by hand & <b>Rs.4820/-</b> by Regd. Post/ courier	From <b>24.11.2023</b>	To <b>04.12.2023</b> up to <b>1.00</b> <b>PM</b>	1(One)% of the total quoted value including GST	Up to <b>3.30 P.M.</b> on <b>04.12.2023</b>	At <b>4.00 PM</b> on <b>04.12.2023</b>

The tender document can be purchased by the interested reputed manufacturers or their authorized dealers / traders by hand from the office of the undersigned on deposit of cost of tender document i.e. **Rs.4000/-** plus GST @ 18% amounting to **Rs.4720/-** in cash or in shape of A/c. payee demand draft drawn in favour of **“Odisha Construction Corporation Limited” - Project Account** on any Nationalised Bank/ Scheduled Bank payable at Bhubaneswar (Non-refundable) and production of attested copies of the following documents and verification thereof by the undersigned. The tender document can also be obtained by the interested reputed manufacturers or their authorized dealers / traders by registered post, speed post/ courier on sending the cost of tender document i.e. **Rs.4000/-** plus GST @ 18% and postage charges of **Rs.100/-** amounting to **Rs.4820/-** in shape of A/c. payee demand draft drawn as stated above and attested copies of the following documents and verification thereof by the undersigned. The undersigned will not be responsible for any kind of delay by the postal/courier authorities.

- 1) Valid GST Registration Certificate.
- 2) PAN Card
- 3) The bidders have to submit copies of purchase orders, credentials, certificates etc. in support of supply of similar items of similar magnitude in last 5 financial years (i.e. from financial year 2018-19 to 2022-23 including current financial year 2023-24).
- 4) Tenderer should submit valid manufacturer / trader registration certificate.

The tender document can also be downloaded from our Website [www.odishaconstruction.com](http://www.odishaconstruction.com) or Govt. of Odisha website [www.odishagov.nic.in](http://www.odishagov.nic.in) to submit the tender (**Bidders are requested to visit our website regularly for any changes since it will not be published in news paper again**). However, the cost of tender document i.e **Rs.4000/-** plus GST @ 18% amounting to **Rs.4720/-** in shape of A/c payee demand draft as stated above in favour of **“Odisha Construction Corporation Limited” - Project Account** on any Nationalised Bank/ Scheduled Bank payable at Bhubaneswar (Non-refundable) along with attested photo copies of all above documents should be submitted while submitting the tender in Envelope-I. Otherwise, the offer shall not be considered and OCCL will not be responsible for missing of any page while downloading. If there will be a public holiday on the last date of sale of tender document and receipt & opening of the tender as specified above, the tender document will be sold and tender will be received & opened on the next working day at the same time and venue.

**The SSI/NSIC/MSME units participating in tender are not entitled for exemption from payment of EMD/ Security Deposits/ Tender Paper costs as communicated vide DOWR Letter No. IIM-24/2018-14318/WR dated 24.05.2018 & Head Office, OCCL Letter No.5502/OCC/ CW-02/09(Vol-V)(WE) dated 30.05.2018.**

The tenders will be opened in the presence of the tenderers or their authorised representatives. Tender through Fax/Telex/telegram/e-mail will not be accepted

The undersigned reserves the right to accept or reject any or all quotations without assigning any reason thereof

**Signature of the tenderer or his/their  
power of attorney holder  
with designation & seal.**

**Senior Manager (Mech.)-I  
OCC Ltd, Central Workshop,  
Rasulgarh, Bhubaneswar-751010**

**ODISHA CONSTRUCTION CORPORATION LIMITED**

(A GOVT. OF ODISHA UNDERTAKING)

**CENTRAL WORKSHOP, RASULGARH,**

**BHUBANESWAR-751010 (ODISHA)**

**TERMS AND CONDITIONS OF TENDER FOR**

**“SUPPLY OF CASTING ITEMS FOR SERVICE GATE / EMERGENCY GATE FOR HR CUM DEPLETION SLUICE, 6T / 14T MOTORIZED SCREW HOIST FOR SERVICE / EMERGENCY GATE OF HR CUM DEPLETION SLUICE , TRASH RACK OF HR CUM DEPLETION SLUICE, RADIAL GATE FOR SPILLWAY AND ITS HOIST OF GHATAKESWAR MULTIPURPOSE PROJECT”**

- 1) Reputed manufacturers/ traders having supplied similar item of similar magnitude earlier and satisfactorily accepted by the clients will be eligible to participate in the tender. The copies of purchase orders, credentials, certificates etc. in support of similar supply and satisfactory performance thereof will be furnished along with the tender.
- 2) Tender should be submitted in two bid system in two separate sealed covers and both will be submitted in a single sealed outer cover subscribing in bold letters as **“Supply of casting items for Service gate / Emergency Gate for HR Cum depletion sluice, 6T / 14T motorized Screw Hoist for Service / Emergency gate of HR cum depletion sluice , trash rack of HR cum depletion sluice, radial gate for spillway and its hoist of Ghatakeswar Multipurpose Project”** and also date of opening of tender. The name and address of the tenderer should not be written on outer cover. Only the name and address of the purchaser should be written on the outer cover.
- 3) The tenderer should submit Earnest Money Deposit (EMD) @ 1(One)% of the total quoted value along with the tender in shape of A/C payee Demand Draft drawn in favour of “Odisha Construction Corporation Limited” - Project Account on any Nationalised Bank / Scheduled bank payable at Bhubaneswar. The tenders received without EMD will be out rightly rejected. EMD of the unsuccessful tenderers will be released only after finalization of the tender.
- 4) i) The first envelope super scribing in bold letters as **“TECHNICAL BID”** should contain the following:
  - a. EMD of 1% as per clause- 3 above.
  - b. Attested copy of valid GST registration certificates. The tenderer will mention his GST Regn. No. in his tender clearly without which the tender will not be taken into consideration.
  - c. Attested copy of PAN Card.
  - d. The bidders have to submit copies of purchase orders, credentials, certificates etc. in support of supply of similar items of similar magnitude in last 5 financial years (i.e. from financial year 2018-19 to 2022-23 including current financial year 2023-24).
  - e. Complete tender document in original including terms and conditions but without detailed specifications and price schedule duly signed on each page by the tenderer or his/their power of attorney holder. In case of power of attorney holder, an attested copy of power of attorney should be furnished.ii) Second envelope subscribing in bold letters **“SPECIFICATION AND PRICE SCHEDULE”** should contain detailed specifications and price schedule in original only duly filled in without leaving any column and line blank and signed on each page by the tenderer or his/their power of attorney holder.
- 5) The tender document can be purchased by the interested reputed manufacturers / traders by hand from the office of the undersigned from **24.11.2023** to **04.12.2023** (up to 1.00 P.M) during office hours on deposit of cost of tender document i.e. **Rs.4000/-** plus GST @ 18% amounting to **Rs.4720/-** in cash or in shape of A/c. payee demand draft drawn in favour of “Odisha Construction Corporation Limited” – Project Account on any Nationalized Bank / Scheduled Bank payable at Bhubaneswar (non-refundable) and production of attested copies of the following documents and verification thereof by the undersigned. The tender document can also be obtained by the interested reputed manufacturers / traders by registered post/speed post/courier on sending the cost of tender document i.e. **Rs.4000/-** plus GST @ 18% and postage charges of **Rs.100/-** amounting to **Rs.4820/-** in shape of A/C. payee demand draft drawn in favour of “Odisha Construction Corporation Limited” - Project Account on any Nationalized Bank / Scheduled Bank payable at Bhubaneswar (non-refundable) and sending attested copies of the following documents and verification thereof by the undersigned.

Signature of the tenderer or his/their  
power of attorney holder  
with designation & seal.

/ 1 //

Senior Manager (Mech.)-I  
OCC Ltd, Central Workshop,  
Rasulgarh, Bhubaneswar-751010

- a. Valid GST Registration Certificate.
  - b. PAN Card
  - c. The bidders have to submit copies of purchase orders, credentials, certificates etc. in support of supply of similar items of magnitude minimum amounting to 20.00 lakh in last 5 financial years (i.e. from financial year 2018-19 to 2022-23 including current financial year 2023-24).
  - d. Tenderer should submit valid manufacturer / trader registration certificate
- 6) The tender document can also be downloaded from our Website [www.odishaconstruction.com](http://www.odishaconstruction.com) or Govt. of Odisha website [www.odishagov.nic.in](http://www.odishagov.nic.in) to submit the tender (**Bidders are requested to visit our website regularly for any changes since it will not be published in news paper again**). However, the cost of tender document i.e. **Rs.4000/-** plus GST @ 18% amounting to **Rs.4720/-** in shape of A/C. payee demand draft, as stated above in favour of "Odisha Construction Corporation Limited" - Project Account on any Nationalized Bank/ Scheduled Bank payable at Bhubaneswar (non-refundable) along with attested photo copies of all above documents should be submitted, while submitting tender in Envelope-I, otherwise, the tender will be cancelled. OCCL will not be responsible for missing of any page while downloading.
- 7) The tenders will be received up to **3.30 PM** on **04.12.2023** and same will be opened in the office of the undersigned on the same day at **4.00 PM** in presence of the tenderers or their authorized representatives, if they so desire. If there will be a public holiday on the last date of sale of tender document and receipt & opening of the tenders as specified above, the tender document will be sold and tenders will be received & opened on the next working day at the same time and venue.
- 8) The undersigned will not be responsible for any kind of delay in receipt of tenders by the postal/courier authorities.
- 9) The **PRICE SCHEDULE BID & TECHNICAL BID** will be opened on **04.12.2023 at 4.00 PM**. Then the documents in the first envelope submitted by the tenderers will be scrutinized preliminarily on the spot. The second envelope of the valid eligible tenders after preliminary scrutiny of the documents in the first envelope will be opened on the same day immediately subject to fulfilling the requirements mentioned in the tender schedule.
- 10) The materials should be supplied in finished / fully machined conditions by successful tenderer / supplier as per required dia, length and quantity and should strictly conform to relevant standards of Bureau of Indian Standard (BIS) as mentioned in detailed specification and price schedule.
- 11) The original test certificate of materials from a Govt./Govt. approved testing laboratory will be provided by the successful tenderer/ supplier along with supply of materials. The manufacturer's test certificate will have to be also furnished by the successful tenderer/ supplier. The purchaser is having the option to test the materials in any laboratory at the cost of the supplier and if the materials are not found in accordance with the specifications and grade in relevant Indian Standards, the materials will be rejected.
- 12) The materials will be guaranteed by the supplier against any defect for a period of 18 months from the date of supply or 12 months from the date of use, whichever is earlier. Guarantee certificate in this regard will accompany with supply of materials. If any defect is found in the materials within the guarantee period, the same will have to be replaced free of cost by the supplier.

**Signature of the tenderer or his/their  
power of attorney holder  
with designation & seal.**

**Senior Manager (Mech.)-I  
OCC Ltd, Central Workshop,  
Rasulgarh, Bhubaneswar-751010**

- 13) The rate of materials should be quoted by the tenderer on unit basis only. The same should be supplied by the successful supplier as per required dia, length and quantity in numbers as mentioned in detail specification and Price Schedule.
- 14) The tenderer will quote their rates F.O.R. OCCL Store, Central Workshop, Rasulgarh, Bhubaneswar-10 (Odisha) indicating separately the basic price, packing, forwarding, transportation, transit insurance, handling charges, taxes, duties, levies etc. strictly in the specifications and price schedule format in original. All columns and lines of the specification and price schedule should be filled in properly without leaving any thing blank. The details and rates of duties, taxes etc. should be indicated clearly in the specification and price schedule.
- 15) The tenderer should quote appropriate taxes with the offer.
- 16) Pre-delivery inspection (P.D.I) before despatch of the materials will be made at the manufacturer's works by the authorized representative of the purchaser / client / third party for which the manufacturer should intimate in writing for P.D.I. 10 days in advance regarding readiness for P.D.I.
- 17) The rates and amounts should be quoted both in figures and words in the price schedule. Any correction or overwriting in the specification and price schedule should be duly certified by the tenderer or his power of attorney holder. In case of any mismatch in figures and words, the rates in words will be considered. In case of any mismatch in rates and amount, the rate will be considered.
- 18) 90% payment will be made within 30 days of receipt, verification and acceptance of the complete materials along with bill, test certificate, guarantee certificate and other documents. Balance 10% will be released after 18 months of supply or 12 months from the date of commissioning whichever is earlier. However if a performance bank guarantee is received for 10% of the value of materials, the same will be released within 60 days from the date of receipt of materials.
- 19) The purchaser reserves the right to forfeit and encash the performance bank guarantee / EMD in full in case any casting is found defective and not replaced by the tenderer/supplier within a suitable time fixed by the corporation. Any repair to the casting shall be made only after approval of the purchaser. In this connection, the decision of the purchaser is final and binding on the tenderer/supplier.
- 20) Price escalation will not be allowed under any circumstances. The quoted rates will remain firm till execution of the work order.
- 21) The validity of the offer should be for a period of 120 (One hundred twenty) days from the date of opening of the tender.
- 22) The complete ordered quantity shall be supplied by the successful tenderer within 90 (Ninety) days from the date of issue of purchase order failing which the order is liable for cancellation without assigning any reason thereof by the purchaser. In case of cancellation of the order the EMD will be forfeited. In case of any delay in supply of material beyond the delivery schedule whatever may be the reason, supplier shall be liable to pay L.D. @ 0.5% (Half percent) of the total order value per week of delay or part thereof subject to a maximum of 5% (Five percent) of the total order value.

**Signature of the tenderer or his/their  
power of attorney holder  
with designation & seal.**

// 3 //

**Senior Manager (Mech.)-I  
OCC Ltd, Central Workshop,  
Rasulgarh, Bhubaneswar-751010**

- 23) After submission of tender and before placing order, the bidder may be asked by the undersigned to attend techno-commercial discussions and reply to queries within a specified period. If the bidder fail to do so, the tender submitted by the bidder is liable to be cancelled.
- 24) Conditional offers with deviations will not be accepted. Those, who do not agree to the terms and conditions regarding payments, delivery and others, need not quote.
- 25) The authority reserves the right to accept/reject any or all tenders without assigning any reason thereof. The required quantity of materials can be splitted among the two or more tenderers. In this connection, the decision of purchaser is final and binding on the tenderer.
- 26) The duplicate copy of the order shall be signed by the supplier on each page with his seal as acceptance of the order and shall be returned to the purchaser within 07 (Seven) days of receipt of this order failing which the order is liable for cancellation.
- 27) Tender through fax/telex/telegram/e-mail will not be accepted.
- 28) Any dispute arising out of this tender or order thereof is to be settled in proper court under the jurisdiction of Odisha High Court at Cuttack or courts under the jurisdiction of Odisha High Court at Bhubaneswar only.

**Signature of the tenderer or his/their  
power of attorney holder  
with desianation & seal.**

**Senior Manager (Mech.)-I  
OCC Ltd, Central Workshop,  
Rasulgarh, Bhubaneswar-751010**

**ODISHA CONSTRUCTION CORPORATION LIMITED  
(A GOVT. OF ODISHA UNDERTAKING)  
CENTRAL WORKSHOP, RASULGARH,  
BHUBANESWAR-751010 (ODISHA).**

**DETAILED SPECIFICATION AND PRICE SCHEDULE FOR  
"SUPPLY OF CASTING ITEMS FOR SERVICE GATE / EMERGENCY GATE FOR HR CUM DEPLETION SLUICE, 6T / 14T MOTORIZED SCREW HOIST  
FOR SERVICE / EMERGENCY GATE OF HR CUM DEPLETION SLUICE , TRASH RACK OF HR CUM DEPLETION SLUICE, RADIAL GATE FOR SPILLWAY  
AND ITS HOIST OF GHATAKESWAR MULTIPURPOSE PROJECT"  
VIDE TCN No.OCC/CWS/PROC/GMP-01 / 48 /2023-24 DATED 23.11.2023 DUE DATE OF OPENING ON DATED 07.12.2023**

Sl. No.	Part No	Description of Item	Unit	Qty. Reqd. in unit	Rate per unit in Rs.					Total amount in Rs. for full materials	
					Basic Price per unit	Packing, forwarding, transportation, transit insurance, handling charges, incidental charges etc.	GST as applicable	Total in figures	Total in words	In figure	In words

<b>1200MM X 600 MM EMERGENCY GATE FOR HEAD REGULATOR-CUM-DEPLETION SLUICE GHATAKESWAR MULTIPURPOSE PROJECT</b>											
1	6-1	Ø220 WHEEL 45C8 OF IS : 2004 -AS PER DRAWING IN ANNEXURE –I (FORGED STEEL OF 45C8 OF IS:2004 )	4	NOS.							
2	6-8	WHEEL PIN X20CR13 OF IS:1570(P5) -AS PER DRAWING IN ANNEXURE –II (STAINLESS STEEL OF X20Cr13 OF IS:1570(PART-5)-1985)	4	NOS.							
<b>1200MM X 600 MM SERVICE GATE FOR HEAD REGULATOR-CUM-DEPLETION SLUICE OF GHATAKESWAR MULTIPURPOSE PROJECT.</b>											
3	6-1	Ø180 WHEEL GR.-2 C.S.700 OF IS:2644 -AS PER DRAWING IN ANNEXURE –III (CAST STEEL OF GR.-2 C.S.700 OF IS:2644-1994)	4	NOS.							

Signature of the tenderer or his/their  
power of attorney holder  
with designation & seal.

Senior Manager (Mech.)-I  
OCC Ltd, Central Workshop,  
Rasulgarh, Bhubaneswar-751010

4	6-8	WHEEL PIN X20CR13 OF IS:1570(P5) -AS PER DRAWING IN ANNEXURE –IV (STAINLESS STEEL OF X20Cr13 OF IS:1570(PART-5)-1985)	4	NOS.							
<b>6T. MOTORISED SCREW HOIST FOR 1200MM X 600 MM SERVICE GATE FOR HEAD REGULATOR-CUM-DEPLETION SLUICE OF GHATAKESWAR MULTIPURPOSE PROJECT.</b>											
5	1-4	GEAR CS 280-520 W OF IS: 1030-1989-AS PER DRAWING IN ANNEXURE –V	1	NOS.							
6	1-5	PINION 45C8 OF IS : 2004 -1991 -AS PER DRAWING IN ANNEXURE –VI	1	NOS.							
7	1-6	NUT SAND CAST PHOSPHER BRONZE (GR-4 OF IS.28 ) -AS PER DRAWING IN ANNEXURE –VII TO BE SQUARE THREADED	1	NOS.							
8	3-6	SPLIT BUSH LTB-1 (AS PER DRAWING IN ANNEXURE –VIII)	16	NOS.							
9	3-7	BUSHING CLAMP STR STEEL( AS PER DRAWING IN ANNEXURE –IX )	16	NOS.							
10	4-4	DOG CLUTCH STR STEEL ( SLIDING ) ( AS PER DRAWING IN ANNEXURE –X)	1	NOS.							
11	4-5	DOG CLUTCH STR STEEL(FIXED ) ( AS PER DRAWING IN ANNEXURE –X)	1	NOS.							
12	4-6	SLIDER BUSH BRASS ( AS PER DRAWING IN ANNEXURE –XI )	2	NOS.							
13	4-13	CHAIN SPROCKET STR STEEL ( DRIVEN ) ( AS PER DRAWING IN ANNEXURE –XII )	1	NOS.							
14	4-14	CHAIN WHEEL STR STEEL ( DRIVING ) ( AS PER DRAWING IN ANNEXURE –XIII )	1	NOS.							
15	5-19	Ø50MM PULLEY WITH PIN SUITABLE FOR Ø4MM WIRE ROPE STD.	2	NOS.							
16	6-1	DIAL PLATE - 3.15MM TH. BRASS IS : 410 ( AS PER DRAWING IN ANNEXURE –XIV )	1	NOS.							
17	6-2	WORM WHEEL 200 -400 W OF IS : 1030 ( AS PER DRAWING IN ANNEXURE –XV )	1	NOS.							
18	6-3	WORM 45 C 8 OF IS : 2004 ( AS PER DRAWING IN ANNEXURE –XVI )	1	NOS.							
19	6-5	BEVEL GEAR WHEEL 200 - 400 W OF IS : 1030 ( AS PER DRAWING IN ANNEXURE –XVII )	1	NOS.							
20	6-6	BEVEL PINION 45 C 8 OF IS : 2004 ( AS PER DRAWING IN ANNEXURE –XVIII )	1	NOS.							

**Signature of the tenderer or his/their  
power of attorney holder  
with designation & seal.**

**Senior Manager (Mech.)-I  
OCC Ltd, Central Workshop,  
Rasulgarh, Bhubaneswar-751010**



21	6-9	BUSH LTB -1 OF IS : 318 ( AS PER DRAWING IN ANNEXURE –XIX )	4	NOS.								
22	6-10	INDICATOR NIDDLE STR STEEL ( CHROME PLATED ) ( AS PER DRAWING IN ANNEXURE –XX )	1	NOS.								
<b>14T. MOTORISED SCREW HOIST FOR 1200MM X 600 MM EMERGENCY GATE FOR HEAD REGULATOR-CUM-DEPLETION SLUICE OF GHATAKESWAR MULTIPURPOSE PROJECT.</b>												
23	1-4	GEAR CS 280-520 W OF IS: 1030-1989 -( AS PER DRAWING IN ANNEXURE –XXI )	1	NOS.								
24	1-5	PINION 45C8 OF IS : 2004 -1991 -( AS PER DRAWING IN ANNEXURE –XXII )	1	NOS.								
25	1-6	NUT SAND CAST PHOSPHER BRONZE (GR-4 OF IS.28 ) -( AS PER DRAWING IN ANNEXURE –XXIII ) TO BE SQUARE THREADED	1	NOS.								
26	3-5	BUSHING CLAMP STR STEEL (AS SHOWN) ( AS PER DRAWING IN ANNEXURE –XXIV )	10	NOS.								
27	3-5(A)	BUSHING CLAMP STR STEEL (AS SHOWN) ( AS PER DRAWING IN ANNEXURE –XXV )	2	NOS.								
28	3-6	SPLIT BUSH LTB -1 OF IS : 318 (AS SHOWN) ( AS PER DRAWING IN ANNEXURE –XXVI )	10	NOS.								
29	3-6(A)	SPLIT BUSH LTB -1 OF IS : 318 (AS SHOWN) ( AS PER DRAWING IN ANNEXURE –XXVII )	2	NOS.								
30	4-4	DOG CLUTCH STR STEEL ( SLIDING ) ( AS PER DRAWING IN ANNEXURE –XXVIII )	1	NOS.								
31	4-5	DOG CLUTCH STR STEEL ( FIXED ) ( AS PER DRAWING IN ANNEXURE –XXVIII )	1	NOS.								
32	4-6	SLIDER BUSH BRASS ( AS PER DRAWING IN ANNEXURE –XXIX )	2	NOS.								
33	4-13	CHAIN WHEEL STR STEEL ( DRIVEN ) ( AS PER DRAWING IN ANNEXURE –XXX )	1	NOS.								
34	4-14	CHAIN SPROCKET STR STEEL ( DRIVING ) ( AS PER DRAWING IN ANNEXURE –XXXI )	1	NOS.								
35	5-19	Ø50MM PULLEY WITH PIN SUITABLE FOR Ø4MM WIRE ROPE STD. )	2	NOS.								
36	6-1	DIAL PLATE - 3.15MM TH. BRASS IS : 410 ( AS PER DRAWING IN ANNEXURE –XXXII )	1	NOS.								
37	6-2	WORM WHEEL 200 -400 W OF IS : 1030 ( AS PER DRAWING IN ANNEXURE –XXXIII )	1	NOS.								

Signature of the tenderer or his/their  
power of attorney holder  
with designation & seal.

38	6-3	WORM 45 C 8 OF IS : 2004( AS PER DRAWING IN ANNEXURE –XXXIV )	1	NOS.							
39	6-5	BEVEL GEAR WHEEL 200 - 400 W OF IS : 1030 ( AS PER DRAWING IN ANNEXURE –XXXV )	1	NOS.							
40	6-6	BEVEL PINION 45 C 8 OF IS : 2004 ( AS PER DRAWING IN ANNEXURE –XXXVI)	1	NOS.							
41	6-9	BUSH LTB -1 OF IS : 318 ( AS PER DRAWING IN ANNEXURE –XXXVII)	4	NOS.							
42	6-10	INDICATOR NIDDLE STR STEEL ( CHROME PLATED ) ( AS PER DRAWING IN ANNEXURE – XXXVIII)	1	NOS.							
<b>1600mm X 1270mm TRASH RACK FOR HEAD REGULATOR CUM DEPLETION SLUICE OF GHATAKESWAR MULTIPURPOSE PROJECT</b>											
43	2-6	60X40X10 TH. THRUST PAD LTB-1 OF IS:318 ( AS PER DRAWING IN ANNEXURE –XXXIX)	240	NOS.							
<b>10000MM X 6430MM RADIAL GATE FOR SPILLWAY OF GHATAKESWAR MULTIPURPOSE PROJECT</b>											
44	6-1	ROLLER PIN-( AS PER DRAWING IN ANNEXURE – XL) ( STAINLESS STEEL OF XO4Cr19Ni9 OF IS:1570(P-5) )	12	NOS.							
45	6-3	GUIDE ROLLER BUSH -( AS PER DRAWING IN ANNEXURE –XLI)	24	NOS.							
46	6-4	GUIDE ROLLER - ( AS PER DRAWING IN ANNEXURE –XLII) (Gr.-1 OF CAST STEEL 640 OF IS:2644-1994)	12	NOS.							
<b>35T. ROPE DRUM HOIST(POSITION INDICATOR &amp; HAND DRIVE) OF GHATAKESWAR MULTIPURPOSE PROJECT.</b>											
47	8-1	DIAL PLATE -3.15MM THICK BRASS OF IS:410 ( AS PER DRAWING IN ANNEXURE –XLIII)	3	NOS.							
48	8-4	BUSH LTB-1 OF IS:318 ( AS PER DRAWING IN ANNEXURE –XLIV)	18	NOS.							
49	8-10	INDICATOR NEEDLE STR STEEL ( AS PER DRAWING IN ANNEXURE –XLV)	3	NOS.							
50	8-20	JAW CLUTCH STR STEEL ( AS PER DRAWING IN ANNEXURE –XLVI)	3	NOS.							

Signature of the tenderer or his/their  
power of attorney holder  
with designation & seal.

51	10-4	DOG CLUTCH (SLIDING) STR STEEL ( AS PER DRAWING IN ANNEXURE –XLVII)	3	NOS.							
52	10-5	DOG CLUTCH (FIXED) STR STEEL ( AS PER DRAWING IN ANNEXURE –XLVII)	3	NOS.							
53	10-6	SLIDER BUSH BRASS ( AS PER DRAWING IN ANNEXURE –XLVIII)	6	NOS.							
54	10-13	CHAIN SPROCKET STR STEEL (DRIVING) ( AS PER DRAWING IN ANNEXURE –XLIX)	3	NOS.							
55	10-14	CHAIN WHEEL STR STEEL (DRIVEN)	3	NOS.							
56	11-11	Ø50MM PULLEY WITH PIN SUITABLE FOR Ø4MM WIRE ROPE STD.	6	NOS.							

**Signature of the tenderer or his/their  
power of attorney holder  
with designation & seal.**

Page 5

**Senior Manager (Mech.)-I  
OCC Ltd, Central Workshop,  
Rasulgarh, Bhubaneswar-751010**

Annexure - I

EMERGENCY GATE FOR HR CUM DEPLETION SLUICE OF GHATAKESWAR MULTIPURPOSE PROJECT, O.C.C.L.

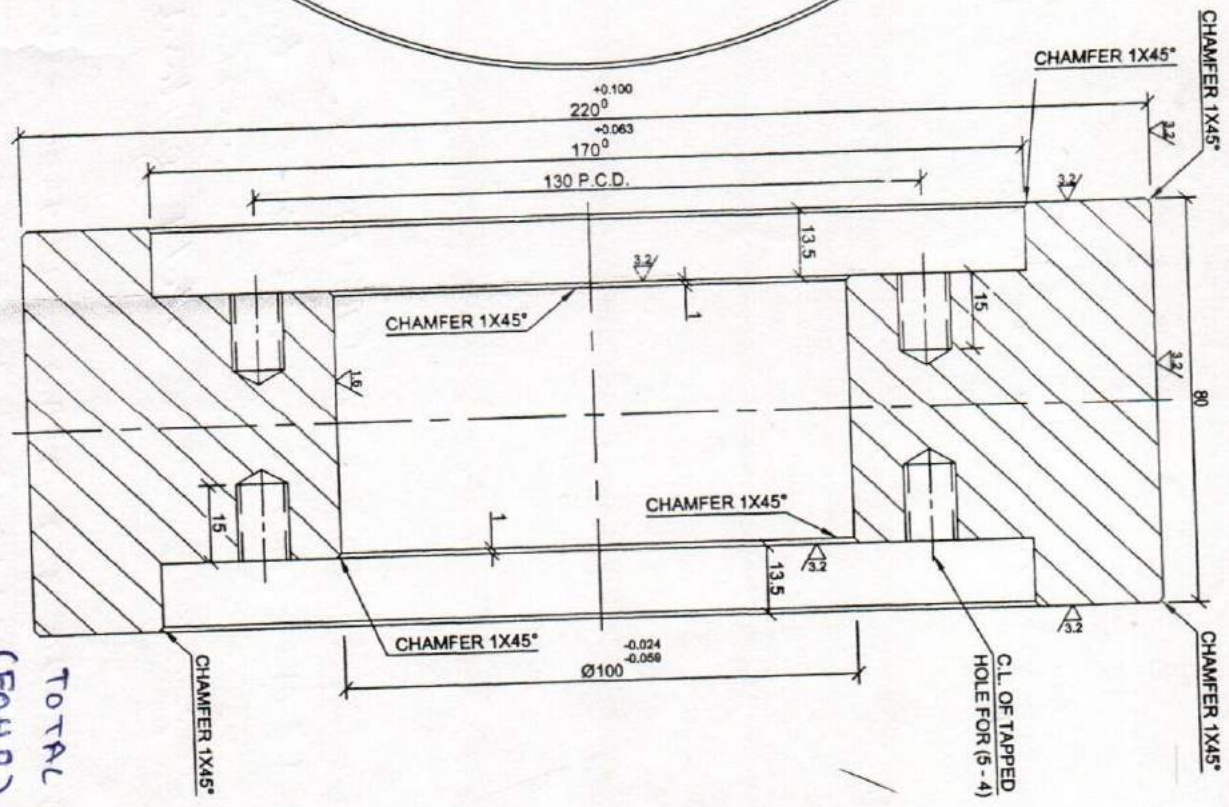
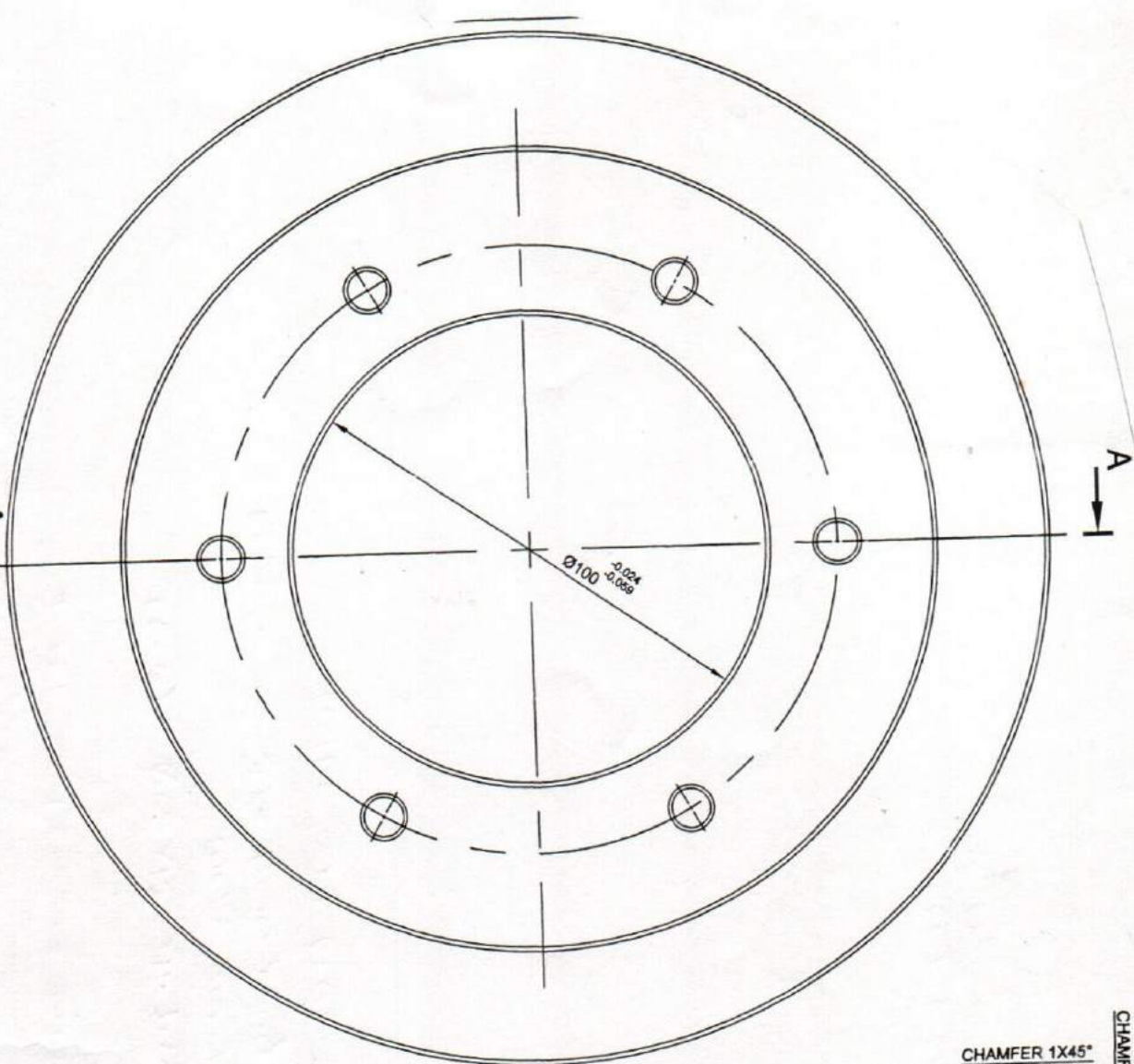

SECTION - AA

MATERIAL - FORGED STEEL OF USC8 OF IS: 2004  
WHEEL (6-1)

TOTAL QTY REQD = 04  
(FOUR) NOS.  
Notes - (G-4) - Roundness  
as per MIDX30 IS: 1365-4.8











1  
 Annexure - 2

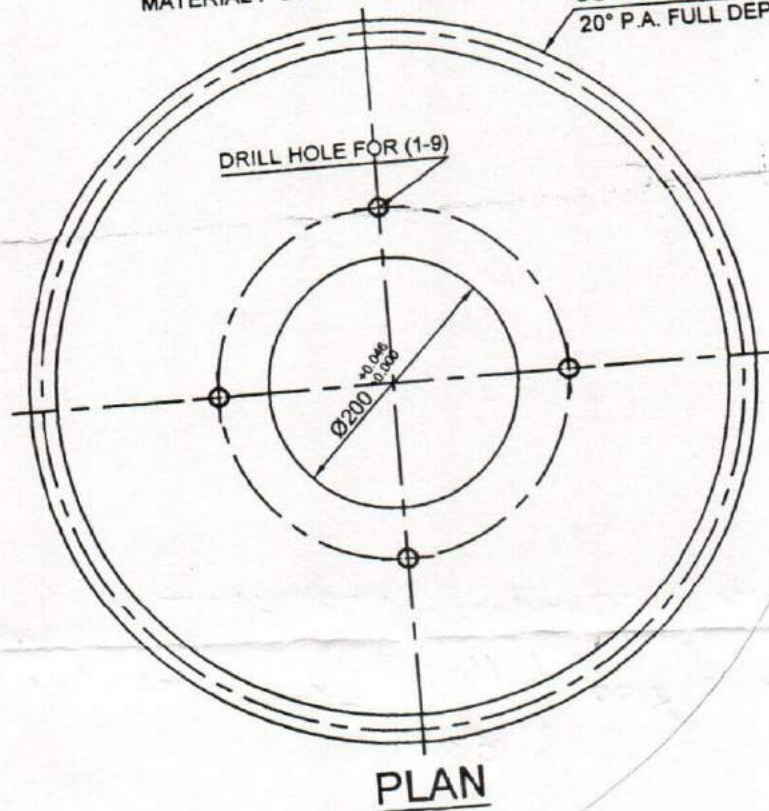
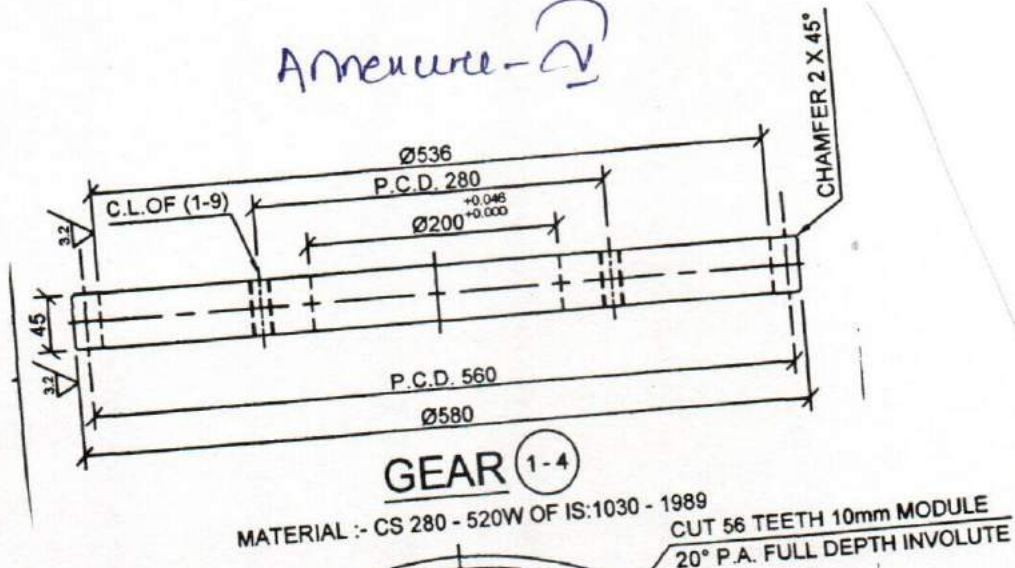

TOTAL QTY REQD. = 01 (ONE) NOS.

Note: - (1-a) - Hex. head screw IS: 1364 (P-2)  
 M16 X 80 - 8.8 with washer.

OT Motorised screw hoist  
 for service gate for HR COM  
 Depletion sluice of Ghatakeswar  
 Multi purpose Project. ORCL.



Annexure - VI

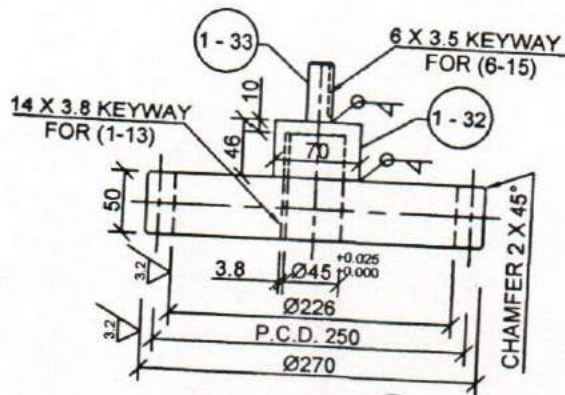

**PINION** (1-5)

MATERIAL :- 45C8 OF IS:2004 - 1991

CUT 25 TEETH 10mm MODULE  
20° P.A. FULL DEPTH INVOLUTE

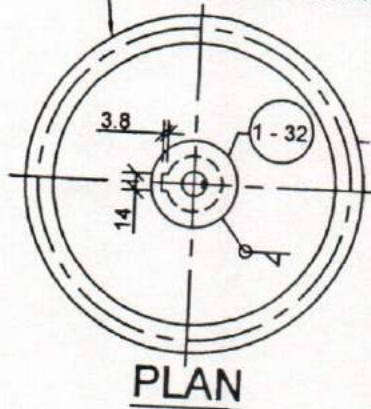

**PLAN**

TOTAL QTY REQD = 01 (ONE) NOS.

Note:- (6-15) - Parallel key A6 X 6 X 45 of IS: 2048-1983

6T MOTORIZED SCREW NOIST FOR.  
SERVICE GATE FOR NR.COM  
DEPLETION SLUICE OF GHATAKESWAR  
MULTIPURPOSE PROJECT.  
OCLL.

Annexure-VII

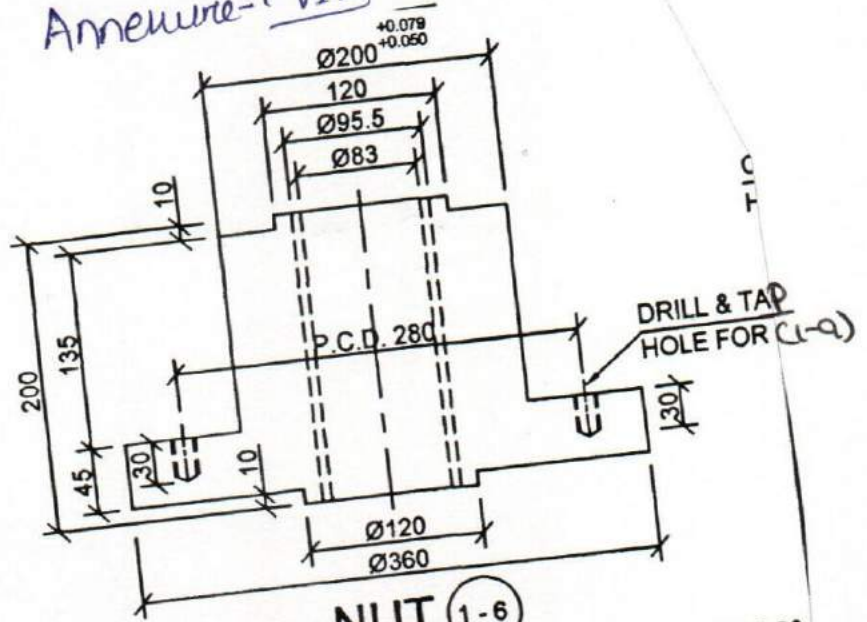

**NUT (1-6)**

MATERIAL :- SAND CAST PHOSPHOR BRONZE GR. - 4 OF IS:28

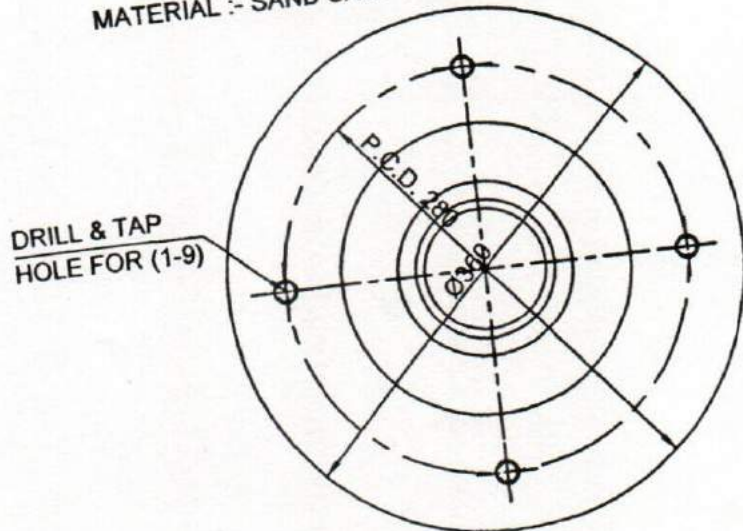

**PLAN**

TOTAL QTY REQD. = 01 (ONE) NOS.

Note: (1-a) - Hex. head screw IS: 1364 (P-2)  
M 16x80-8.8 with washer.

GT MOTORIZED SCREW HOIST FOR  
SERVICE GATE FOR NR CUM  
DEPLETION SLUICE OF  
GHATAKESWAR MULTIPURPOSE  
PROJECT. OCCL.



Appendix - VIII

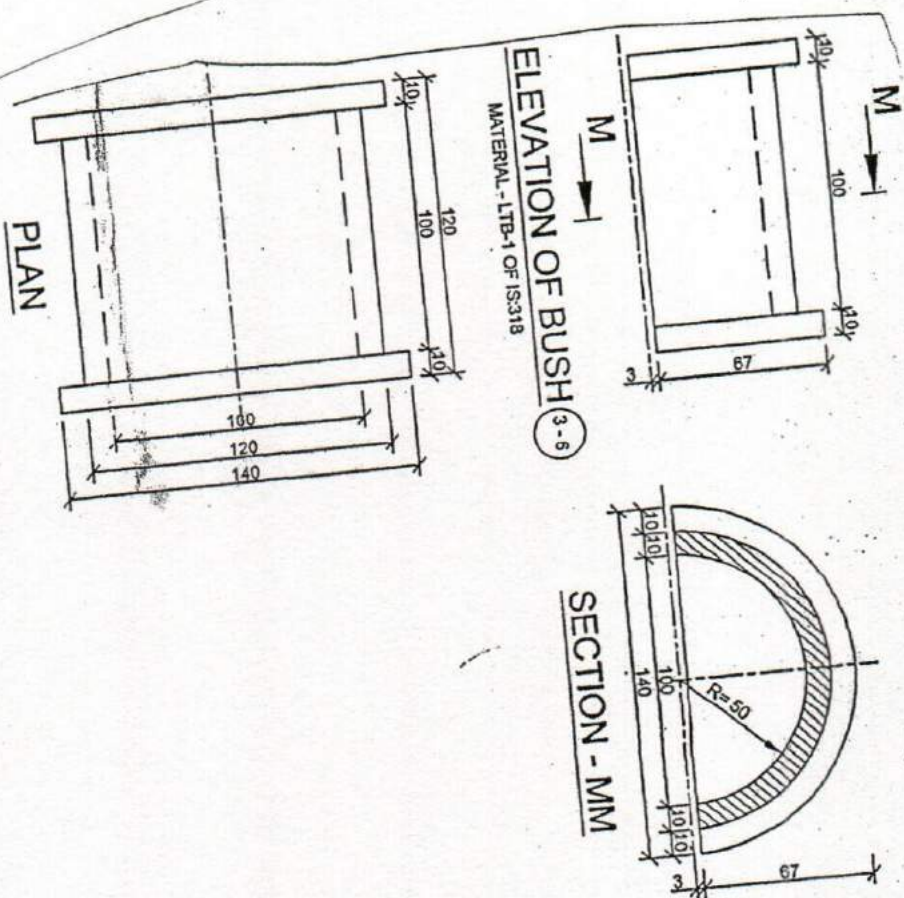

TOTAL QTY REQD. = 16 (SIXTEEN) NOS.

6T MOTORIZED SCREW HOIST FOR SERVICE  
GATE FOR HR-CUM-DEPLETION SLICE OF  
GHATAKESWAR MULTIPURPOSE PROJECT.  
OCCL.

Annexure - IX

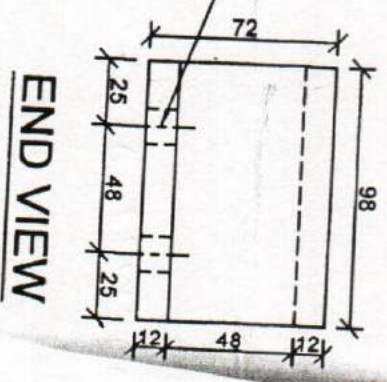
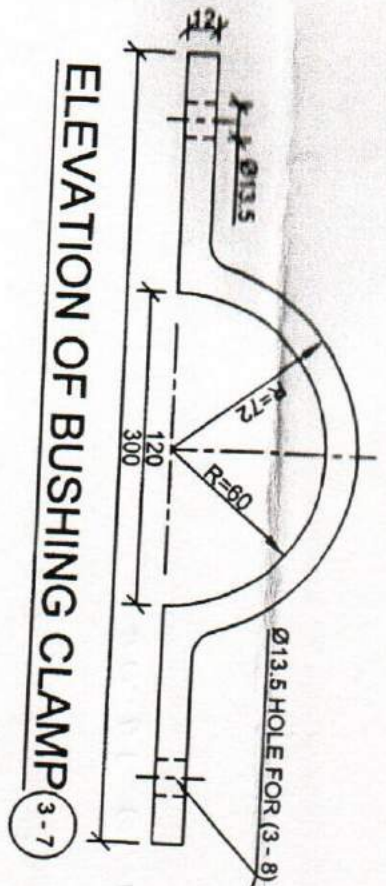
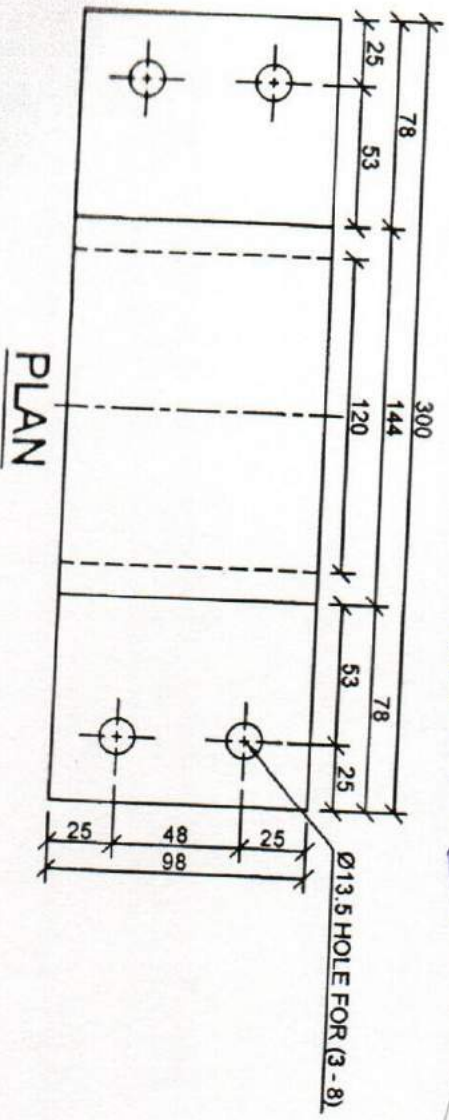

TOTAL QTY REQD. = 16 (SIXTEEN) NOS.  
 Note: (3-8) - Hex bolt M12 X 50 N 8.8 IS: 1364 with washers.

GT MOTORIZED SCREW HOIST FOR SERVICE GATE FOR HR-COM - DEPLETION SLICE OF GHATAKESWAR MULTI PURPOSE PROJECT DCCL.



# Annexure - 2

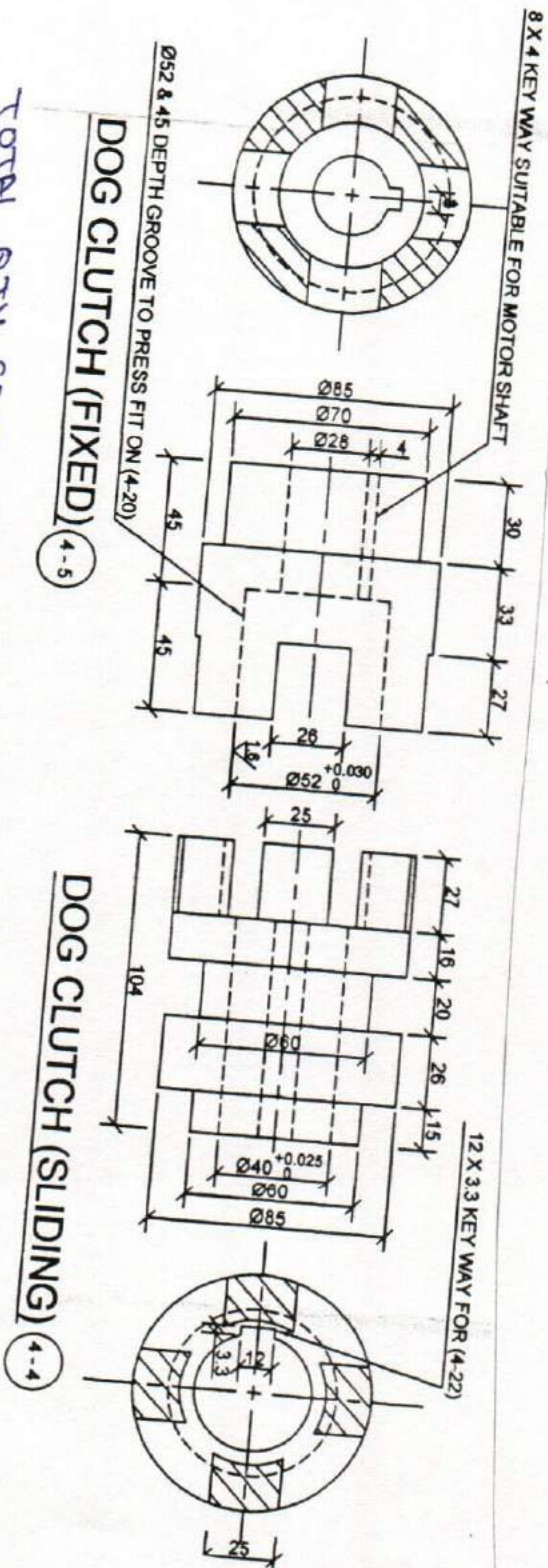

TOTAL QTY REQD. = 01 (ONE) NOS.

Note - (4-20) - Self aligning ball bearing SKF 2205-2RS1 OR EQUIVALENT  
 (4-22) - 12 X 8 - 220 long square key

TOTAL QTY REQD. = 01 (ONE) NOS.

6T MOTORIZED SCREEN HOIST FOR SERVICE GATE FOR HR. COM DEPLETION SLUCE OF GHATAKESWAR MULTIPURPOSE PROJECT.

Annexure XI

GT MOTORIZED SCREW HOIST FOR SERVICE GATE FOR URUM DEPLETION SLICE OF GHATAKESWAR MULTIRIVER PROJECT. DCLL.

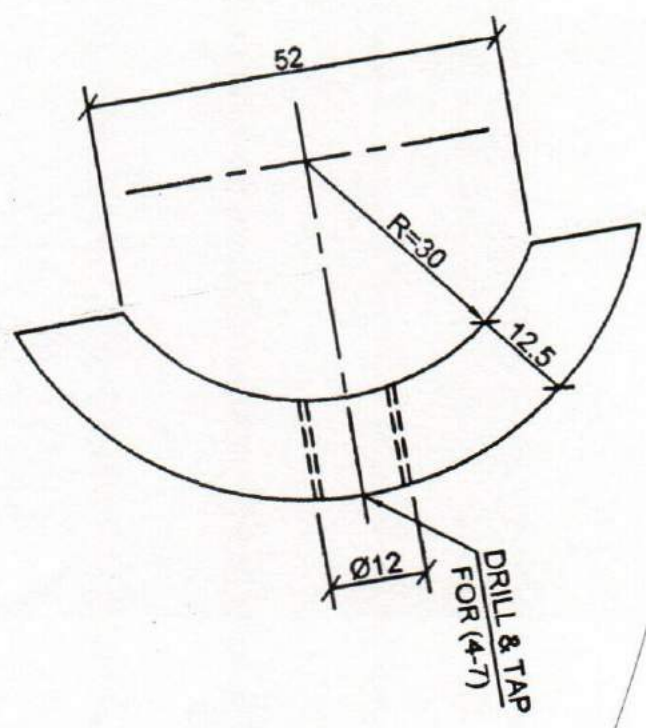
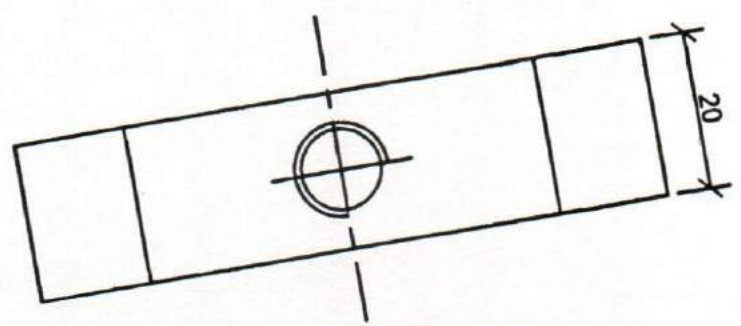

**SLIDER BUSH** 4-6  
MATERIAL - BRASS

TOTAL Qty REQD. = 02 (Two) NOS.  
Notes - (4-7) - Rim for slider bush



Annexure - XII

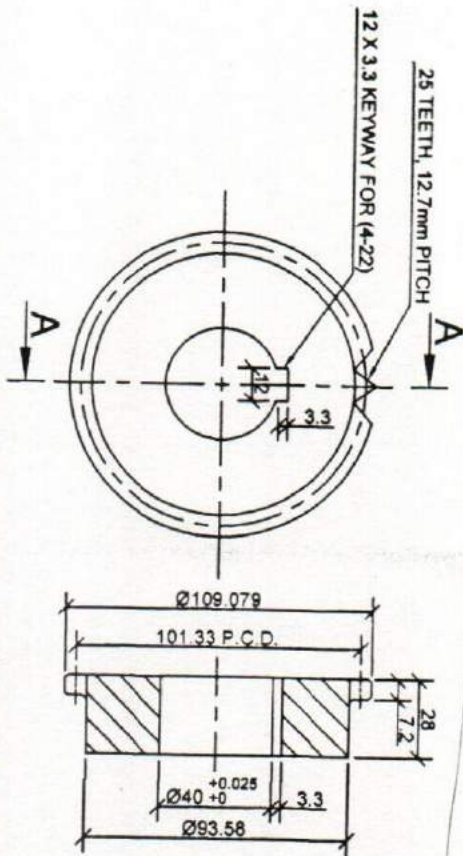

**CHAIN SPROCKET (DRIVEN) (4-13)**

SPECIFICATION:-  
MATERIAL - CAST STEEL/STR STEEL  
PITCH - 12.7 FOR CHAIN 082-1 OF IS:2403  
NOS. OF TEETH = 25

TOTAL Qty. REQD. = 01 (ONE) NOS.

No. of - (4-22) - 12x8 - 220 long square bar

GT MOTORAISED SCREW HOIST FOR SERVICE  
GATE FOR HR COM DEPLETION SLUICE  
OF GHATAKESWAR MULTI PURPOSE PROJECT  
OCLL.

Annexure - XIII

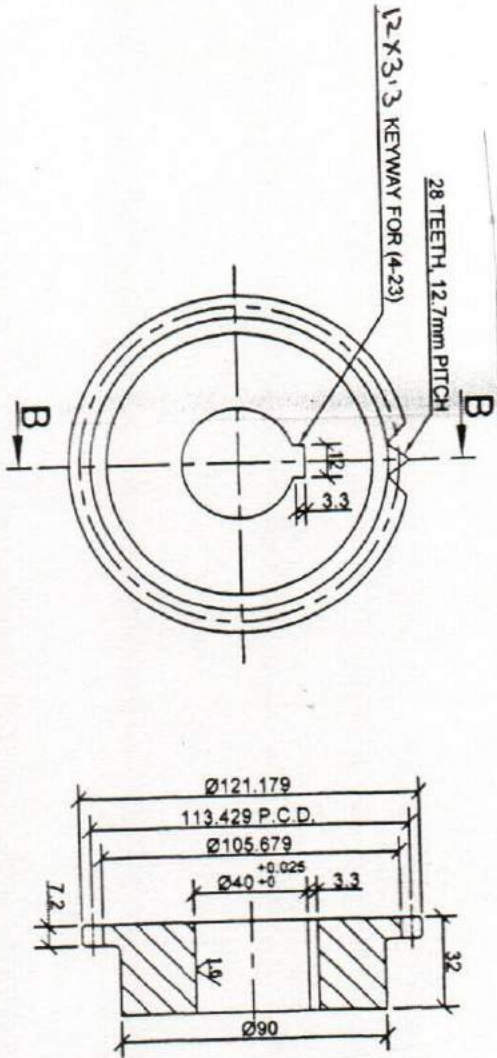

**CHAIN WHEEL (DRIVING) 4-14**

**SECTION - BB**

SPECIFICATION :-  
 MATERIAL - CAST STEEL/STR. STEEL  
 PITCH - 12.7 FOR CHAIN 082-1 OF IS:2403  
 NOS. OF TEETH = 28

TOTAL QTY REQD. = 01 (ONE) NOS.  
 Nos 00 - (4-23) - 12x8 - 32 long square key

6T MOTORIZED SCREW HOIST FOR  
 SERVICE GATE FOR HR COMPLETION  
 SLICE OF GHATKES WAR  
 MULTIPURPOSE PROJECT. OCCL.



Annexure - XII

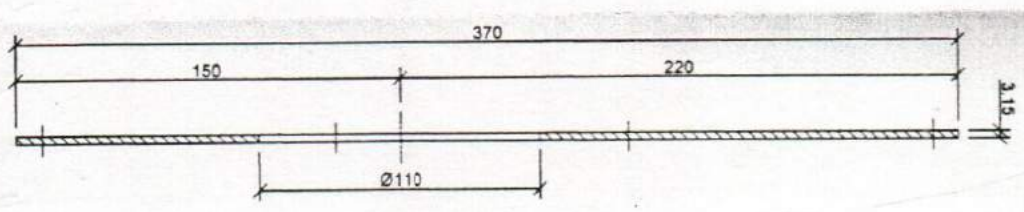
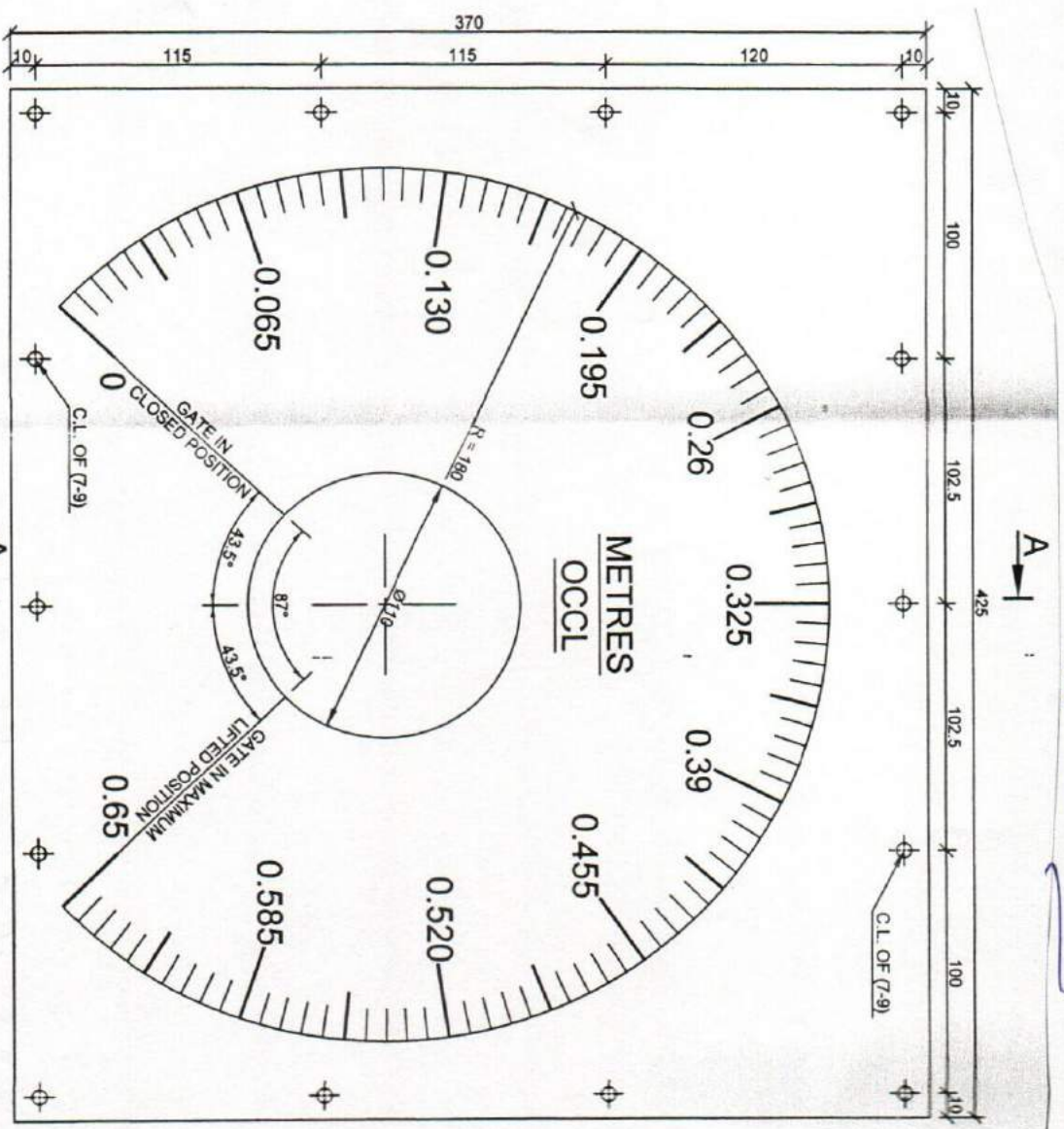

DIAL PLATE (6-1)

SECTION - AA

NO. OF GATES REQUIRED = 01 (ONE) NOS.  
 NO. OF GATES - (7-9) - C.B. SURENDRA M S X 10 IS: 1363

6T MOTORIZED SCREW HOIST FOR SERVICE GATE FOR THE COM DELETION SERVICE OF GATE KEYS AND MOTORHOIST PROVED - 001

Appendix - XI

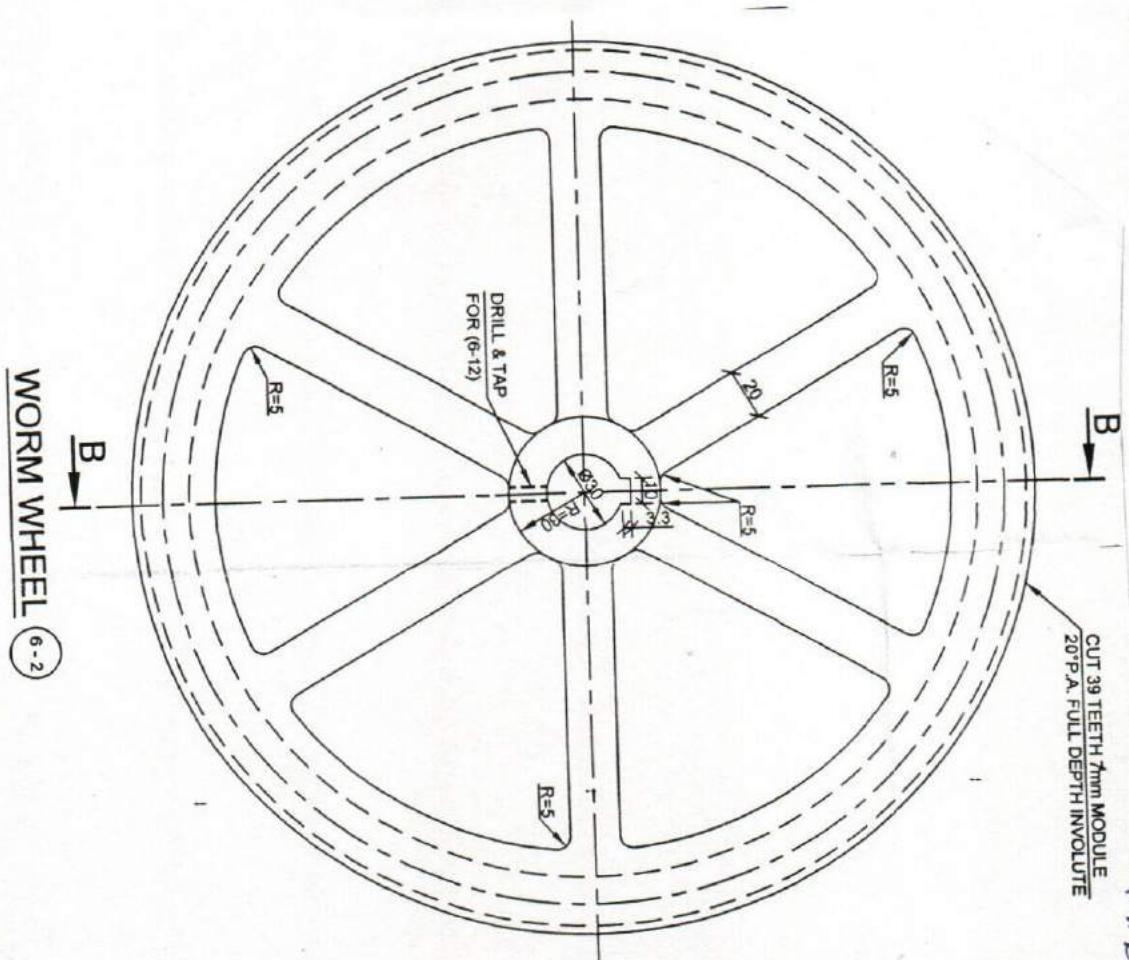

WORM WHEEL (6-2)

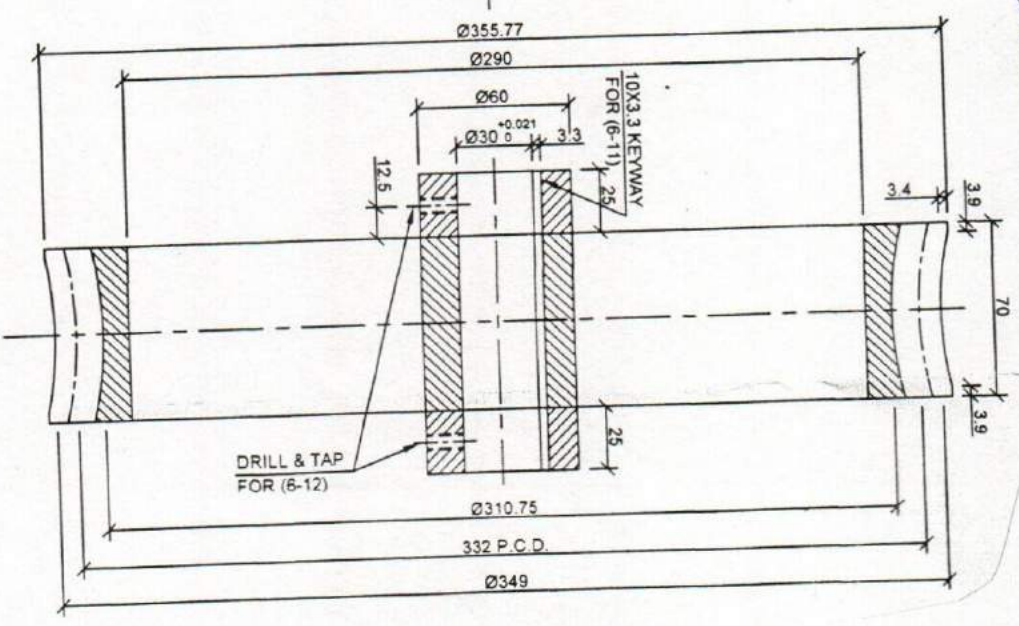

SECTION - BB

TOTAL QTY REQD. = 01 (ONE) NOS.

Note: - (6-12) - Grub screw M6X16 IS; 6094-10.9

(6-11) - Parallel key A10X8X120 of IS; 2048-1983

GT MOTORIZED SCREEN HOIST FOR SERVICE GATE FOR NR CUM DEPLETION SLUCE OF GHATAKESWAR MULTIPURPOSE PROJECT.



Annexure - XVI

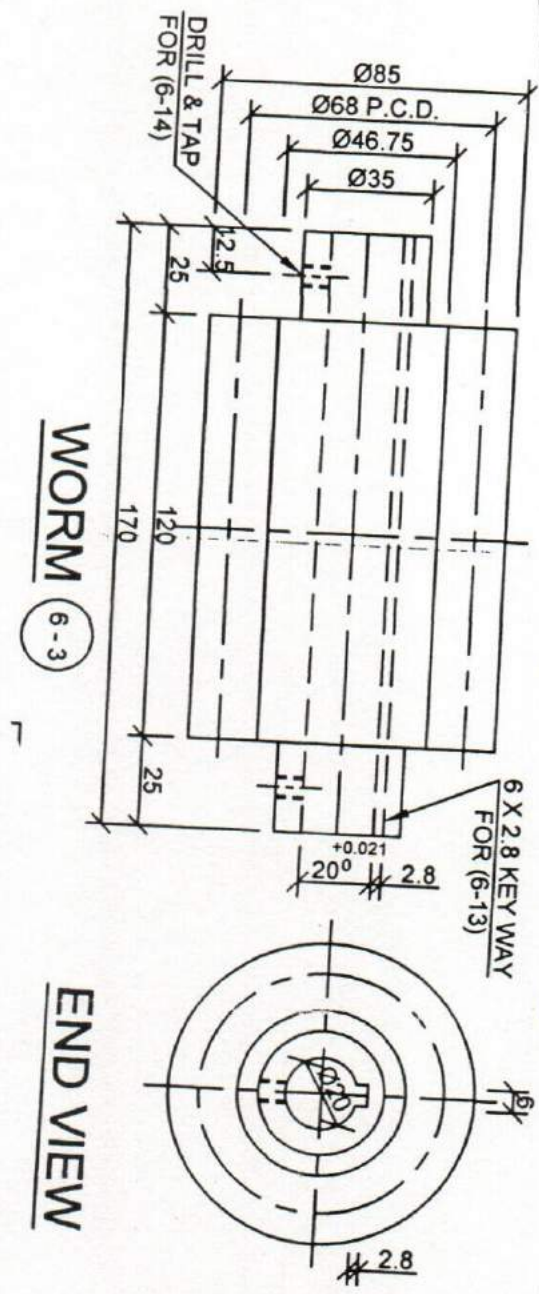

TOTAL QTY REQD. = 01 (ONE) NOS.

Note: (6-14) - Grub screws cm 6x8 IS; 6024-10.9  
 (6-13) - Rasolled key 6x6x50 of IS; 2028-1983

GT MOTORIZED SCREW HOIST FOR  
 SERVICE GATE FOR NR COM DELETION  
 SLICE OF GHATAKESWAR MULTIPURPOSE  
 PROJECT.  
 OACL.

Appendure - XVII

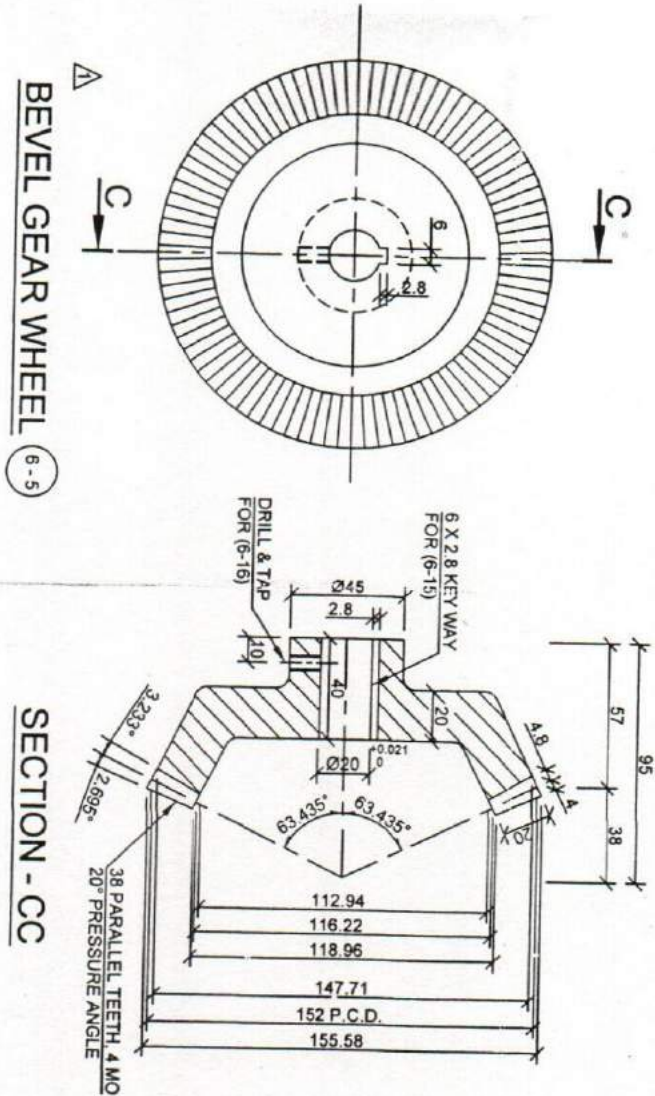

BEVEL GEAR WHEEL (6-5)

SECTION - CC

TOTAL GRY REAR = 01 (ONE) NOS.

Note:- (6-15) - Parallel key 6x6x45 of IS: 2048-1983  
 (6-16) - Grub screws M6x12 IS: 6094-10.9

GT MOTORIZED SCREW HOIST FOR  
 SERVICE GATE FOR HR COM DEPLETION  
 SLICE OF GANTAKESWAR MULTIPURPOSE  
 PROJECT. DCCL.



Annexure - XVII

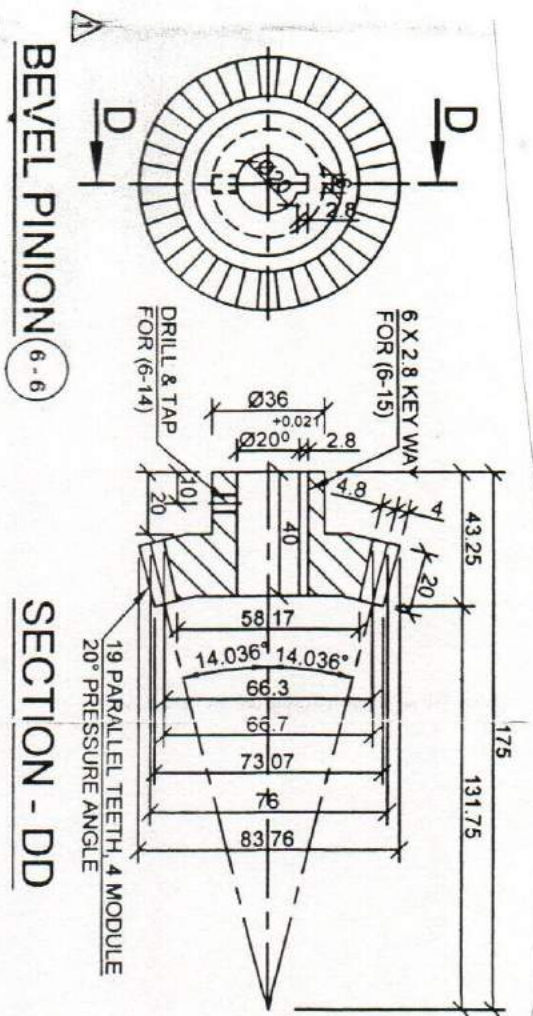

TOTAL QTY READ = 01 (ONE) NOS.

Note: (6-15) - Parallel key 16 X 6 X 45 of IS: 2048-1983  
(6-14) - Grub screws M6 X 8 IS: 6094 - 10.9

1 SET MOTORIZED SCREW HOIST FOR SERVICE GATE FOR RR CUM DEPLETION SLICE OF GHATAKESWAR MULTIPURPOSE PROJECT. DCCL.

Appendure - XIX

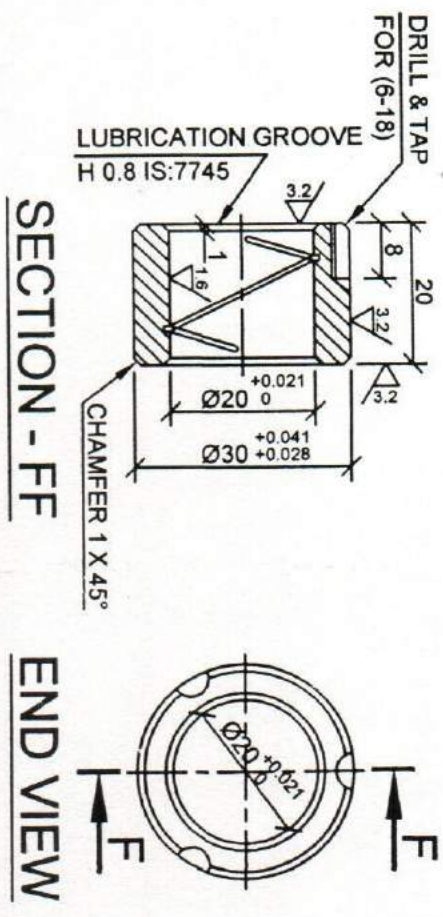

BUSH (6-9)

TOTAL QTY REQS. = 04 (FOUR) NOS.

Note: - (6-18) - Grub screws CM 5 X 8 IS: 6094-10.9

GT MOTORISED SCREW HOIST FOR SERVICE  
 GATE FOR RR COM DEPLETION SLUCE OF  
 GWATAKES WAR MULTI PURPOSE PROJECT.  
 OCLL'



Annexure - XX

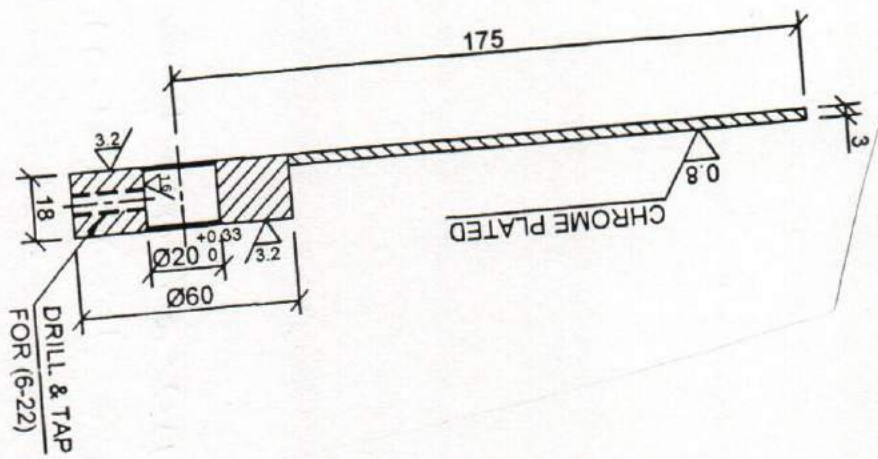
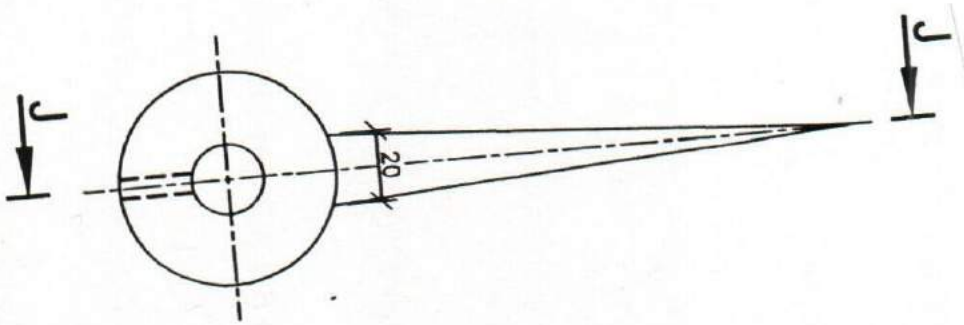

**INDICATOR NIDDLE** (6-10)

**SECTION - JJ**

TOTAL QTY REQS. = 01 (ONE) NOS.

Note: - (6-22) - Grub screws CM 6 X 20 IS: 6004 - (0.9

GT MOTORISED SCREW HOIST FOR  
SERVICE GATE FOR MR CM DEPLETION  
SERVICE OF GHATAKESWAR MULTI PURPOSE PROJECT.

14T MOTORISED SCREW HOIST FOR  
 EMERGENCY GATE FOR NR COM  
 DEPLETION SLUICE OF GNATAKESWAR  
 MULTI PURPOSE PROJECT.  
 OCCL.

Annexure - XIXI

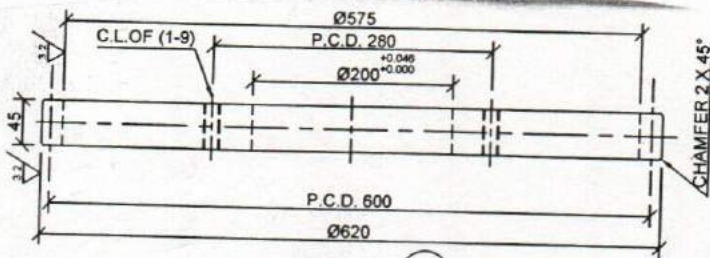

GEAR (1-4)

MATERIAL :- CS 280 - 520W OF IS:1030 - 1989

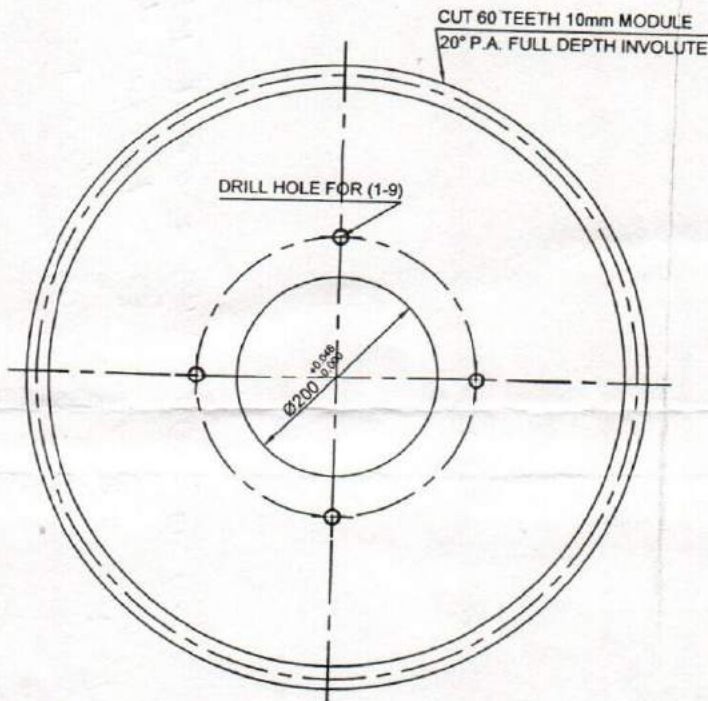

PLAN

TOTAL QTY REQD. = 01 (ONE) NOS.

Note:- (1-9) - Hex. head screws IS: 1364 (F-2) M16X80  
 8.8 with washer



Annexure - XXII

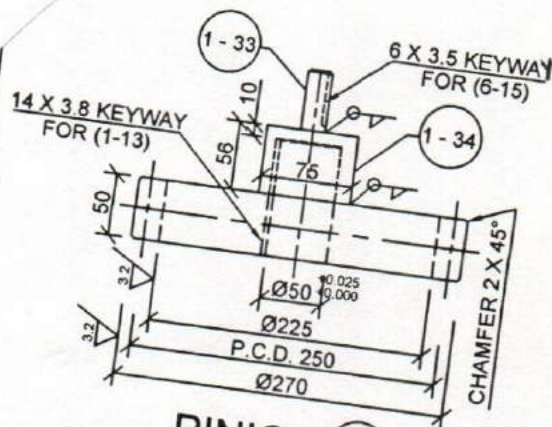

**PINION** (1-5)

MATERIAL :- 45C8 OF IS:2004 - 1991

CUT 25 TEETH 10mm MODULE  
20° P.A. FULL DEPTH INVOLUTE

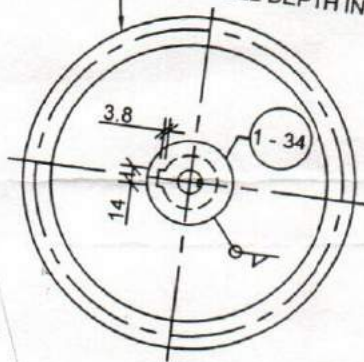

**PLAN**

TOTAL QTY REQD. = 01 (ONE) NOS.

Note :- (1-13) - Parallel Key A14 X 9 - 50 LONG, IS: 2048  
(6-15) - Parallel Key A6 X 6 X 4.5 of IS: 2048 - 1983

14T MOTORISED SCREW HOIST FOR  
EMERGENCY GATE OF NR COM  
DEPLETION SLICE OF GNATAKESWAR PROSE  
OCC.

Annexure XIII

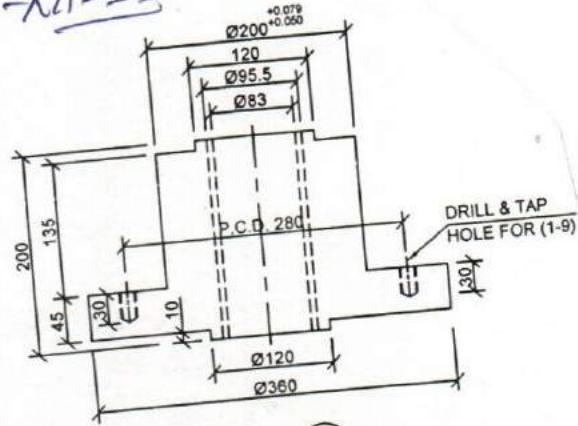

NUT (1-6)

MATERIAL :- SAND CAST PHOSPHOR BRONZE GR. - 4 OF IS 28

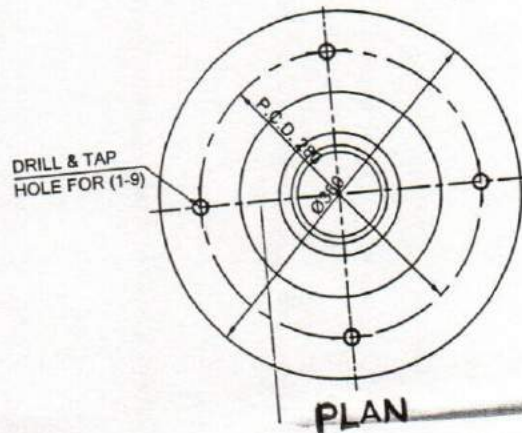

TOTAL QTY REQD. = 01 (ONE) NOS.

Note:- (1-9) - Hex. head screw IS: 1364 (P-2)  
M16X80-8.8 with washer.

14T MOTORISED SCREW HOIST FOR  
EMERGENCY GATE FOR NR COM  
DEPLETION SLUICE OF GNATAKESWAR  
MULTI PURPOSE PROJECT.

OCCL.



Annexure - XXIV

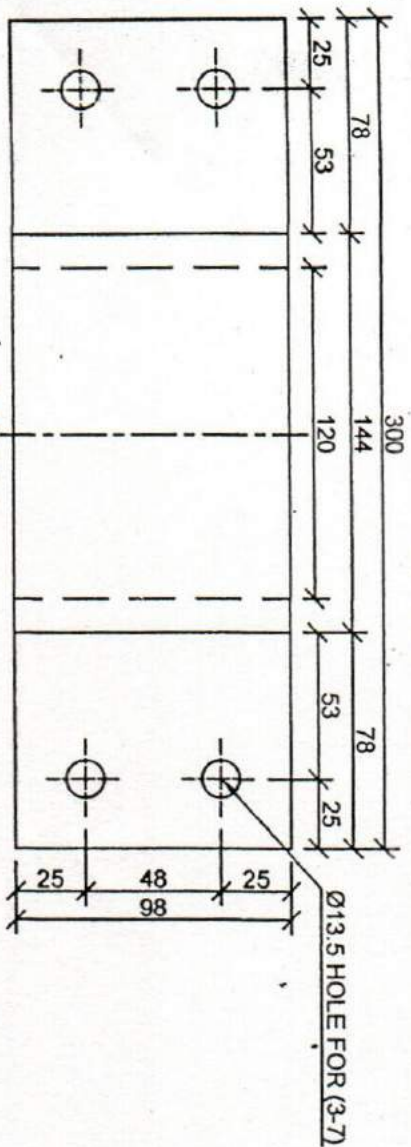

PLAN

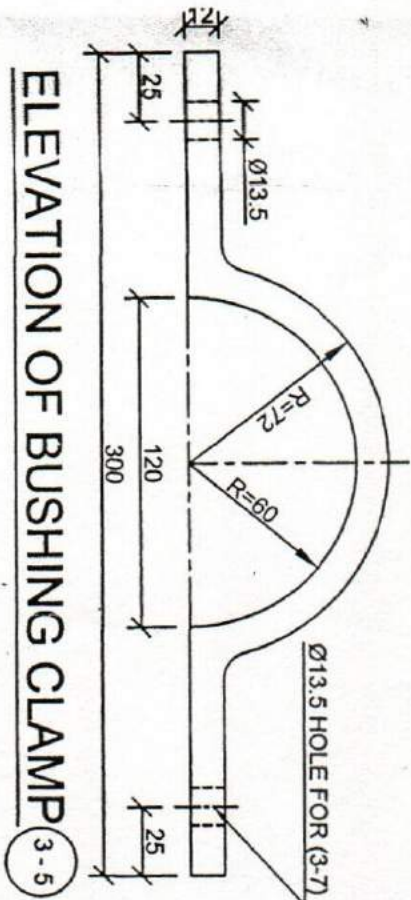

ELEVATION OF BUSHING CLAMP (3-5)

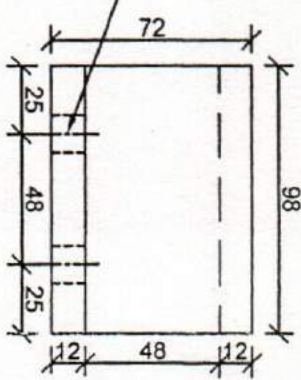

END VIEW

TOTAL QTY. REQD. = 10 (TEN) NOS.

Note :- (3-7) - Here, bolt M12 X 50 N 8.8 IS: 1364 with washer.

14T MOTORIZED SCREEN HOIST FOR EMERGENCY GATE FOR MR COM DEPLETION SLUCE OF GHATAKESWAR MULTI PURPOSE PROJECT. OCC.

Annexure - 2

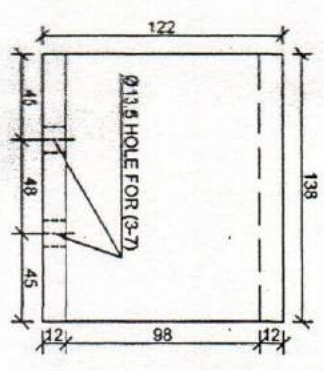
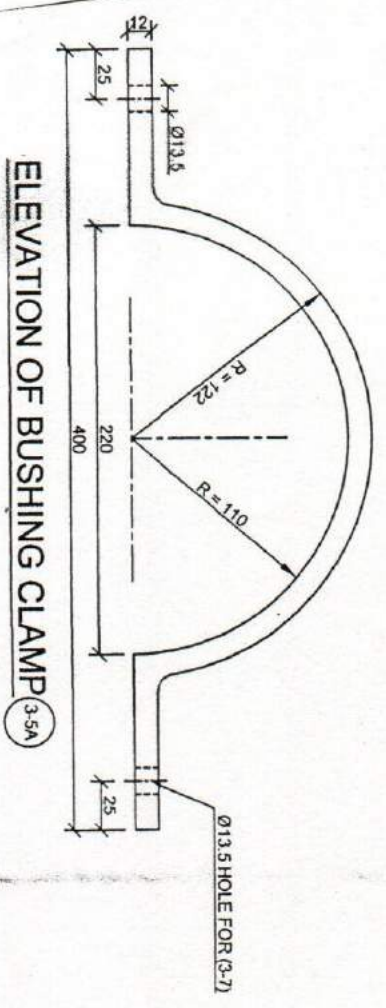
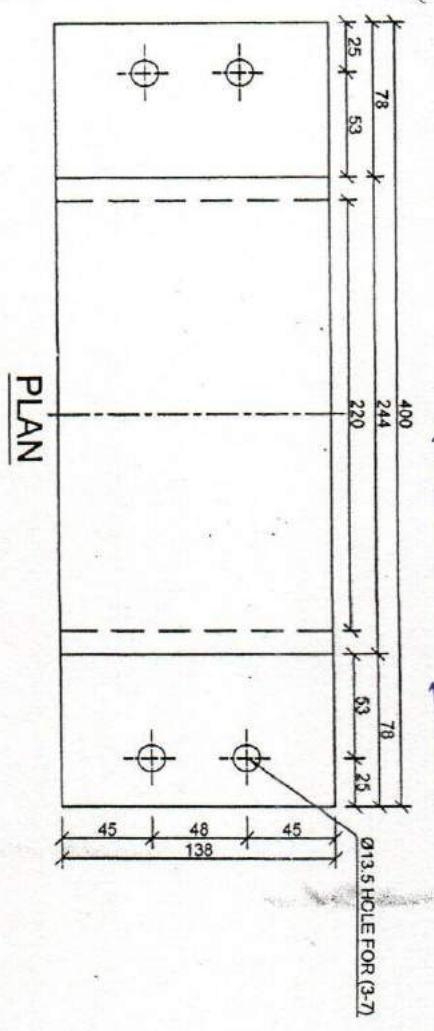

TOTAL QTY REQD. = 02 (TWO) NOS.

Note: - (3-7) - Hex. Bolt M12x50 N 8.8 IS: 1364 with washer.

14T MOTORIZED SCREW HOIST FOR EMERGENCY GATE FOR HR CUM DEPLETION SLUCE OF GHATAKES WAR MULTIPURPOSE PROJECT. O.C.C.L.



Annexure - XXVI

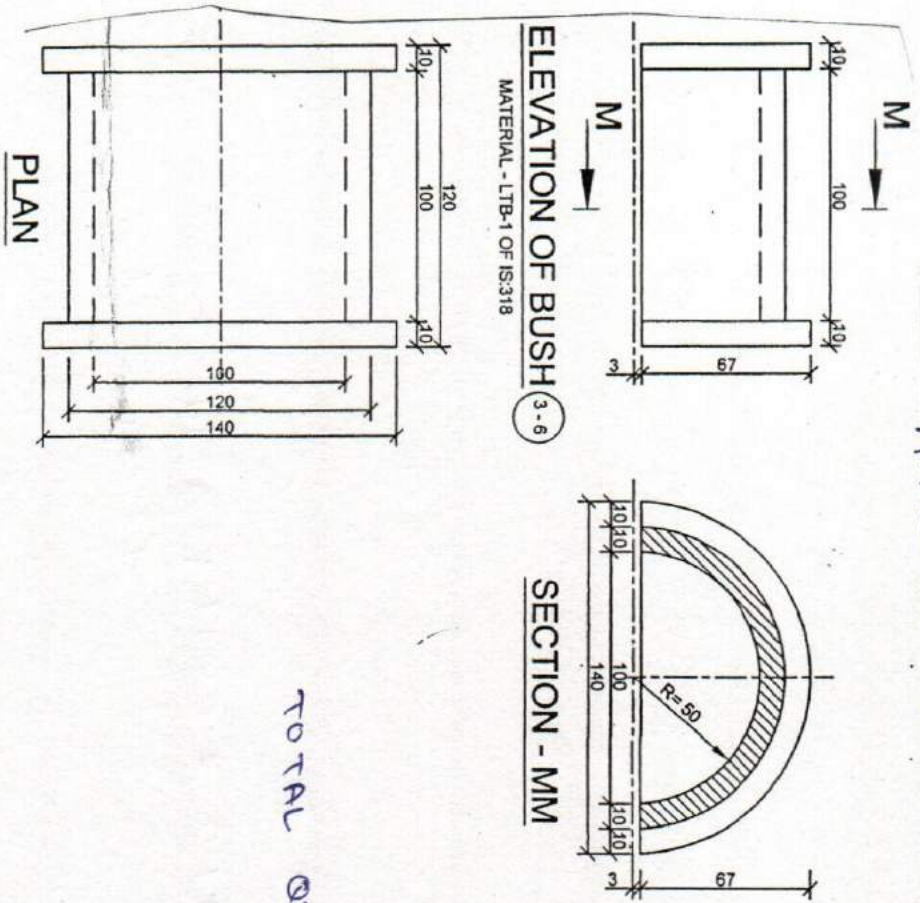

TOTAL QTY REQD. = (10 CTEN) NOS.

IHT MOTORIZED SCREEN HOIST FOR  
EMERGENCY GATE FOR HR CUM  
DEPLETION SLVICE OF GHATAKESWAR  
MULTI PURPOSE PROJECT.  
OCCV.

Annexure - XXVII

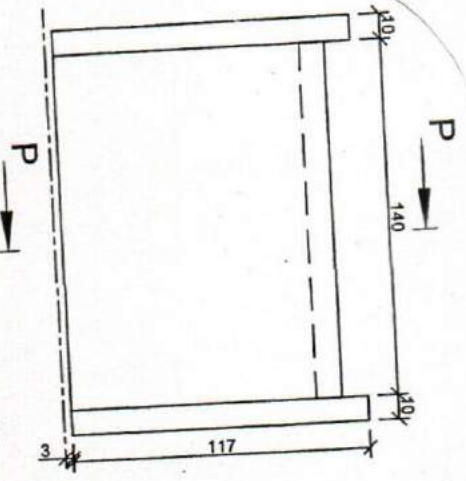

ELEVATION OF BUSH  
MATERIAL - LTB-1 OF IS:318  
35A

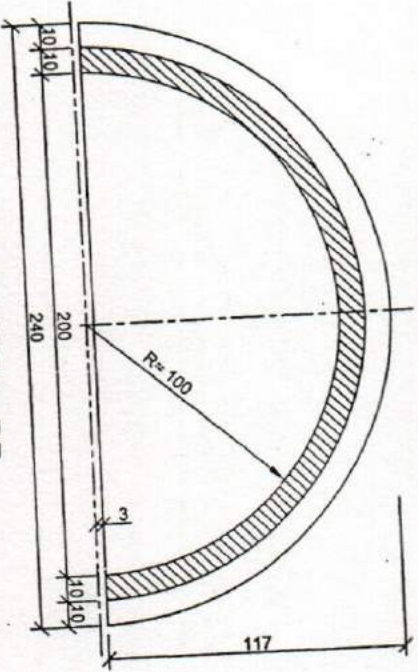

SECTION - PP

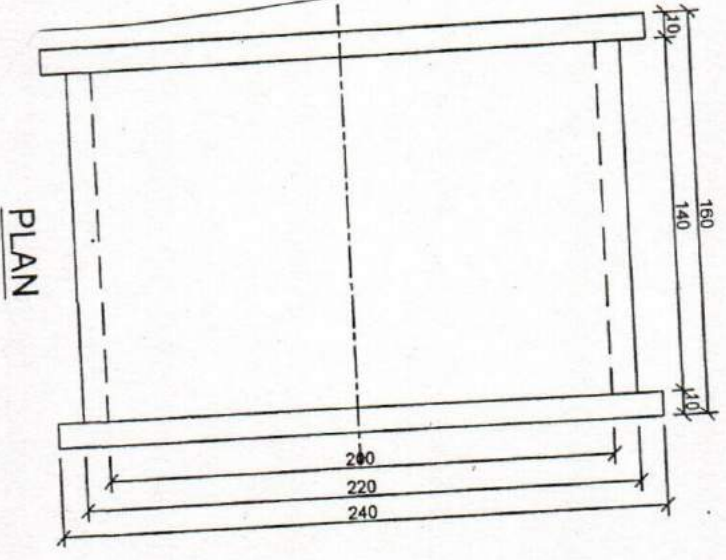

PLAN

TOTAL QTY. REQD. = 02 (TWO) NOS.

14T MOTORIZED SCREEN HOIST FOR  
EMERGENCY GATE FOR MR CUM  
DEPLETION SLUCE OF GHATAKESWAR  
MULTI PURPOSE PROJECT.  
OCLL.



Annexure - XVII

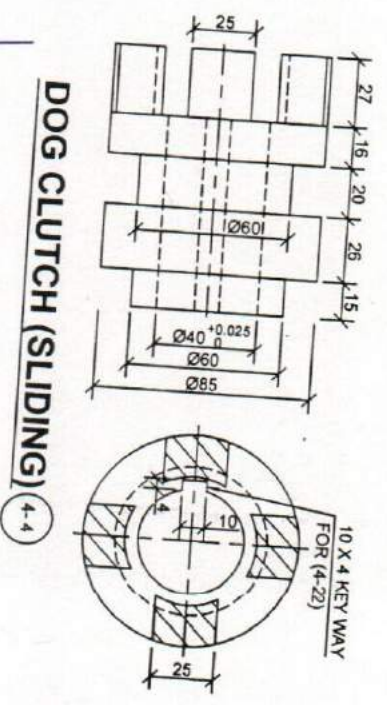
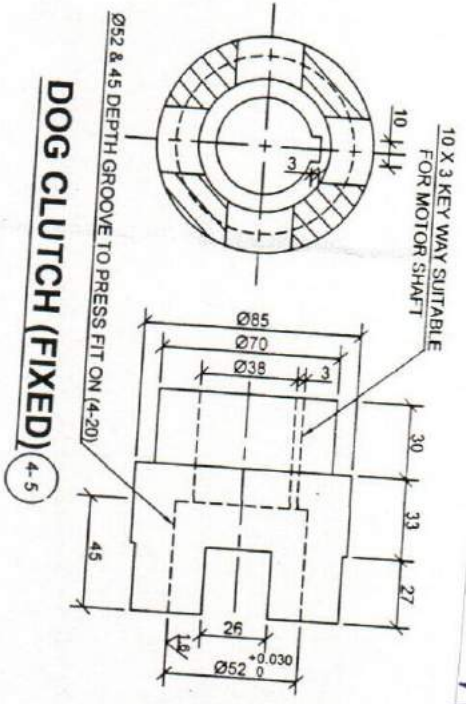

TOTAL QTY REQD. = 01 (ONE) NOS.

TOTAL QTY REQD. = 01 (ONE) NOS.

Note: - (4-22) - 10 X 10 - 220 Long square key

1) IT MOTORIZED SCREW HOIST FOR EMERGENCY GATE FOR NR CUM DEPLETION SLUCE OF BHATAKESWAR MULTIPURPOSE PROJECT.  
 DCCL.

Annexure - 2XIX

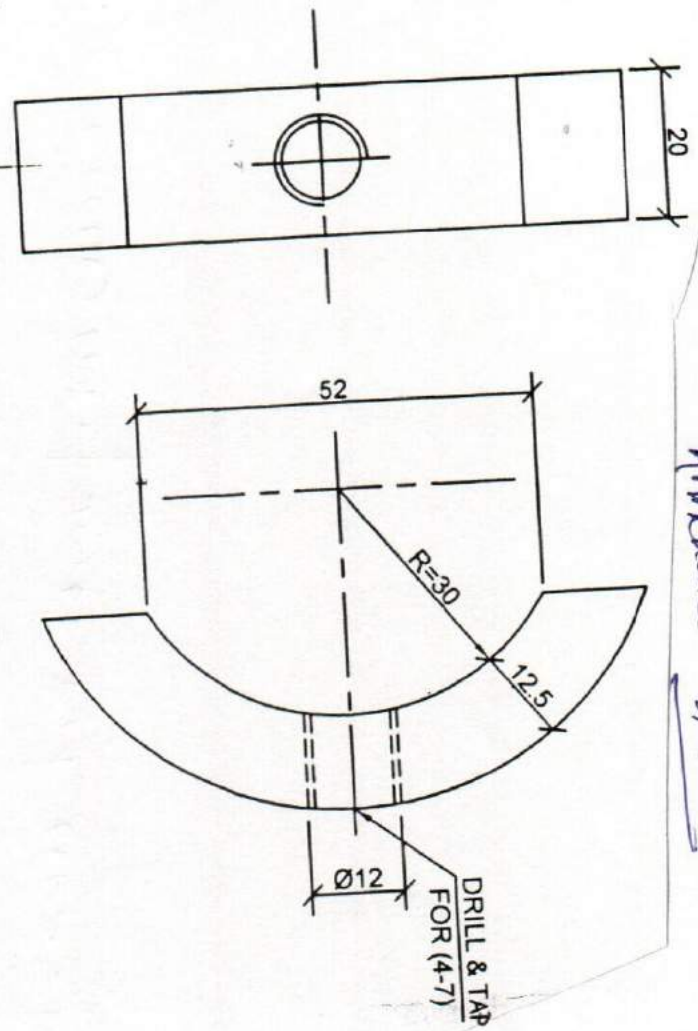

**SLIDER BUSH** (4-6)

MATERIAL - BRASS

TOTAL QTY. REQD. = 02 (TWO) NOS.

Note: (4-7) - Rim for slides bush.

14T MOTORIZED SCREW HOIST FOR  
EMERGENCY GATE FOR HR COM DEPLETION  
PROJECT.  
DR. G. N. S. RAO  
MULTI PURPOSE  
OCC.



A measure - XXX

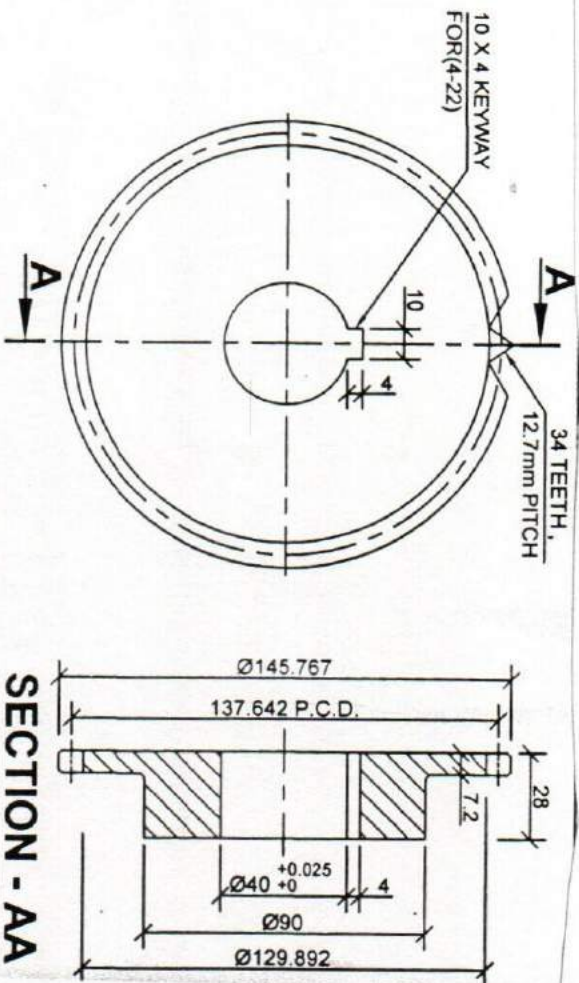

**CHAIN WHEEL (DRIVEN)** (4-13)

SPECIFICATION :-  
 MATERIAL - CAST STEEL/STR STEEL  
 PITCH - 12.7 FOR CHAIN 083-1 OF IS:2403  
 NOS. OF TEETH = 34

TOTAL QTY REQD. = 01 (ONE) NOS.

Note :- (4-22) - 10x10 - 220 long square key

1st motorised screw hoist for  
 emergency gate for HR COM DEPLETION  
 PROJECT.  
 PROJECT.  
 PROJECT.

Annexure - XXI

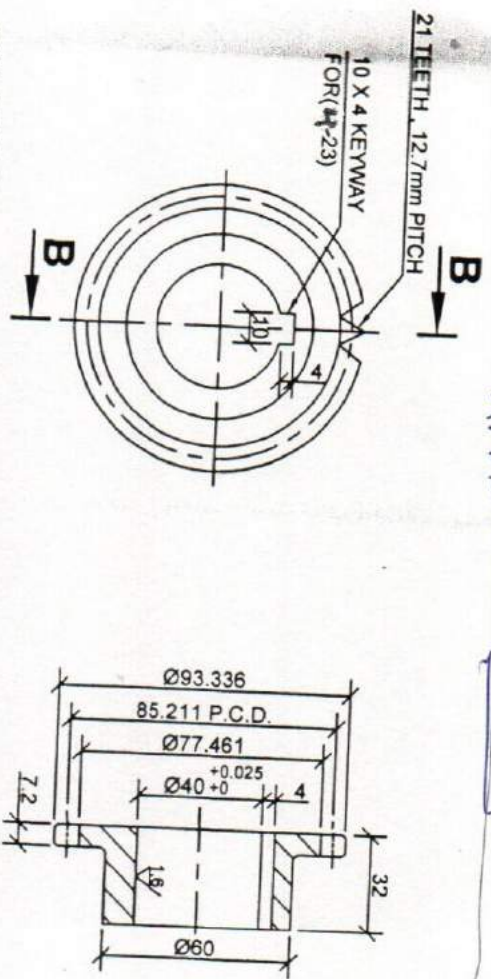

**CHAIN SPROCKET (DRIVING) (4-14) SECTION - BB**

SPECIFICATION :-  
MATERIAL - CAST STEEL/STR. STEEL  
PITCH - 12.7 FOR CHAIN 083-1 OF IS:2403  
NOS. OF TEETH = 21

TOTAL QTY REQD. = 01 (ONE) NOS.  
NO. 8 - (4-23) - 10 X 10 - 32 long square key.

1. 14T MOTORIZED SCREW HOIST FOR  
EMERGENCY GATE FOR NR COM DEPLETION  
SLICE OF GHATAKESWAR MULTIPURPOSE  
PROJECT.  
CCCL.



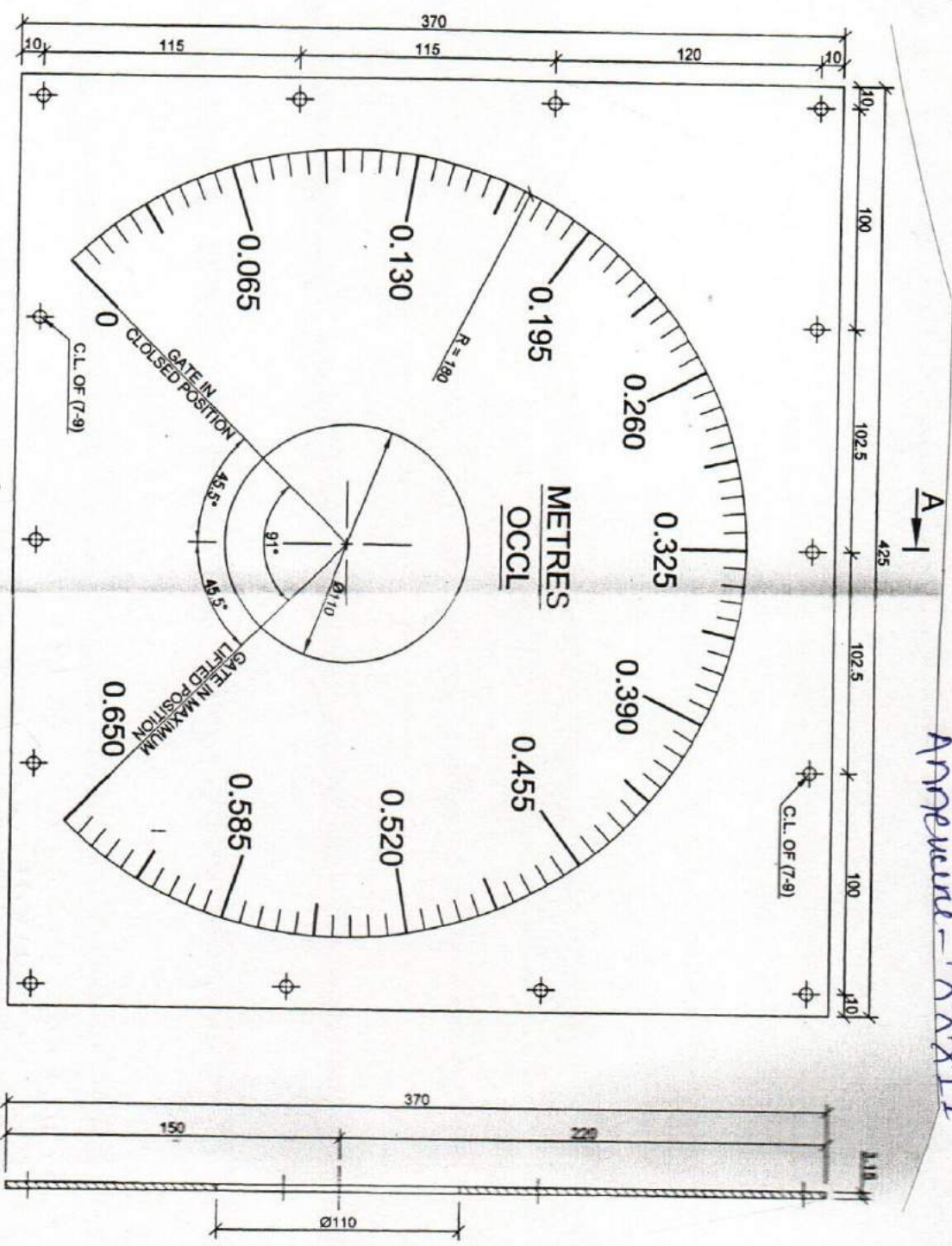

DIAL PLATE (6-1)

SECTION-AA

TOTAL QTY READ = 01 (ONE) NOS.

Nos 00 - (7-9) - 28. SERVO MSX10 IS: 1363

14T. MOTORIZED SCREW HOIST FOR EMERGENCY GATE FOR BR CON DEPLETION SWICE OF GHATAKESWAR MULTI PURPOSE PROJECT



Anexura - XXXIII

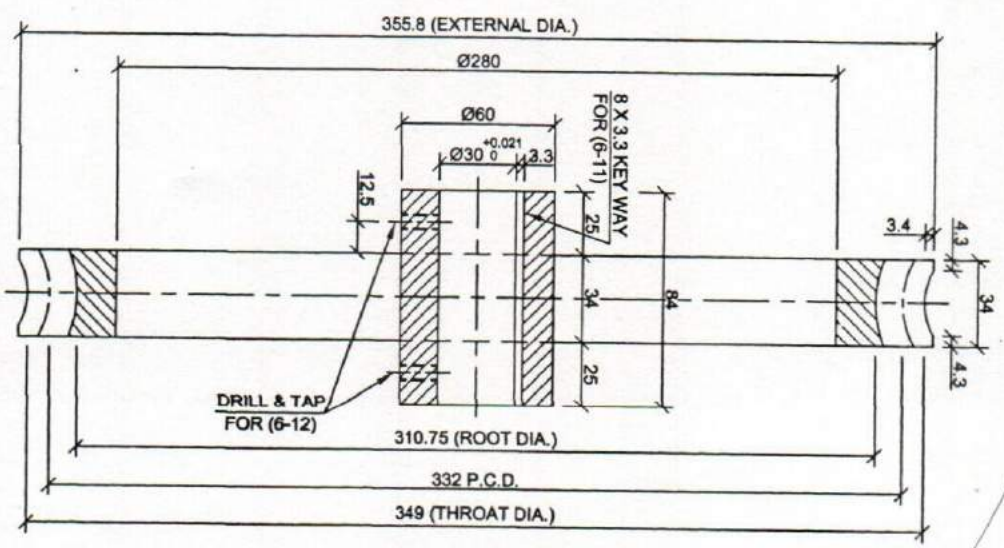
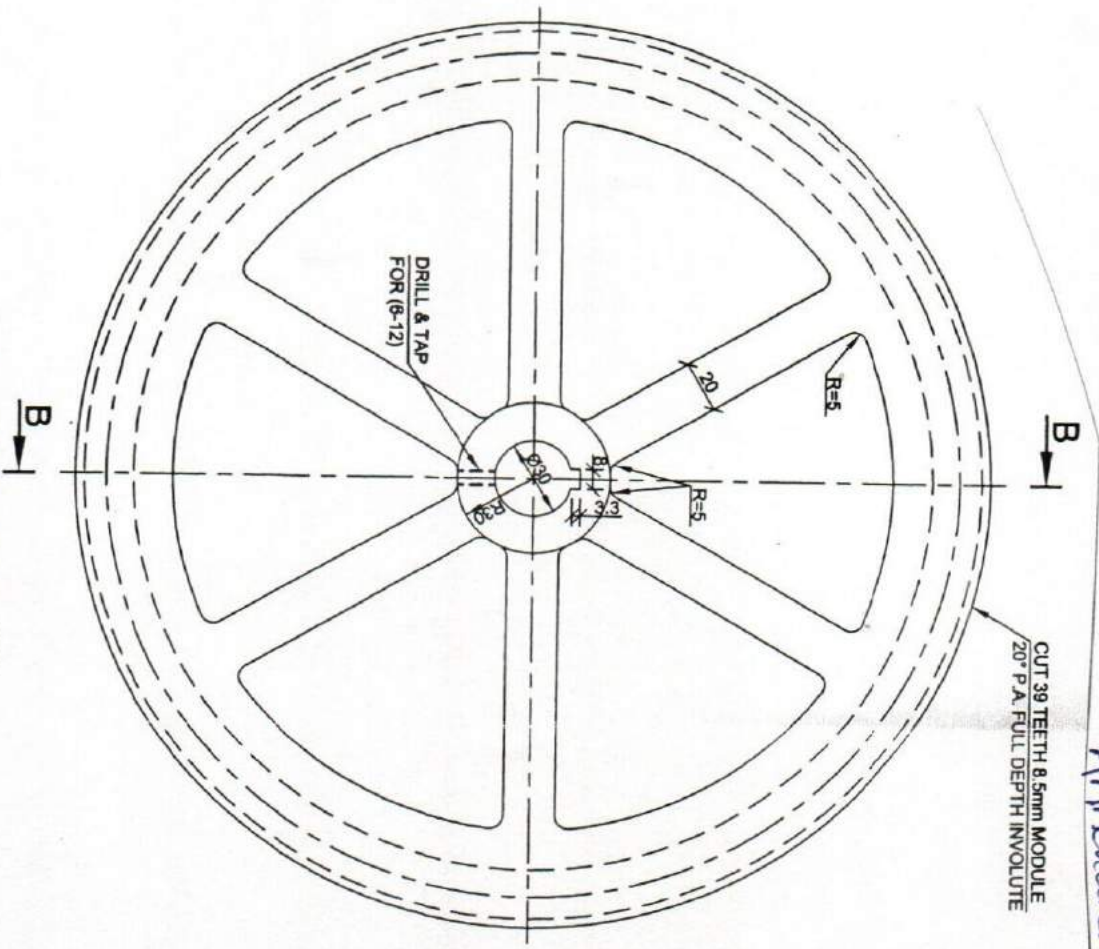

WORM WHEEL (6-2)

SECTION - BB

R1139/818.5-200MM OF IS: 3734-1983  
MATERIAL - CAST STEEL GR.200-400 W OF IS:1030  
TOTAL QTY REQD. = 01 (ONE) NOS.

14 T MOTORISED SCREW HOIST FOR  
EMERGENCY GATE FOR BR. COM  
DETECTION SLUICE OF GHATAKESWAR  
MULTY PURPOSE PROJECT. OSSL.

Appendure XXIX

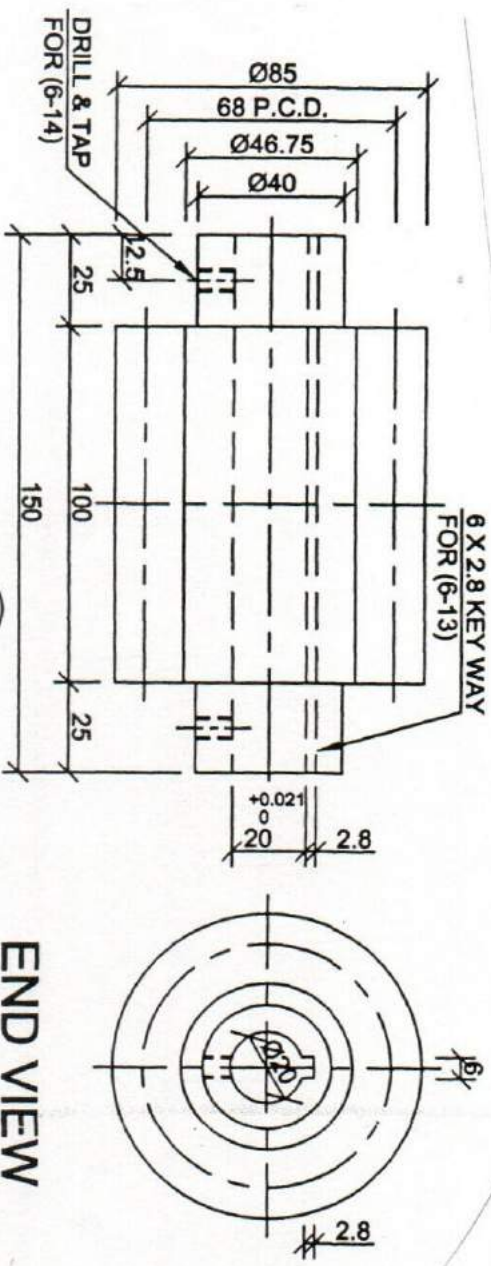

R1/39/8/8.5 - 200mm OF IS:3734 - 1983  
 MATERIAL :- CARBON STEEL 45C8 OF IS:2004

**WORM** (6-3)

**END VIEW**

TOTAL QTY REQD. = 01 (ONE) NOS.

Note 8 - (6-14) - Grub screw CM 6X10 IS: 6094 - (0.19 (6-13) - Rosalloy key A6X6X50 of IS: 2048 - (1983.

14T MOTORISED SCREW HOIST FOR EMERGENCY GATE FOR WA COM DEPLETION SLICE OF GHATKESWAR MULTI PURPOSE PROJECT, Occl,



Ameyuro - XXXIV

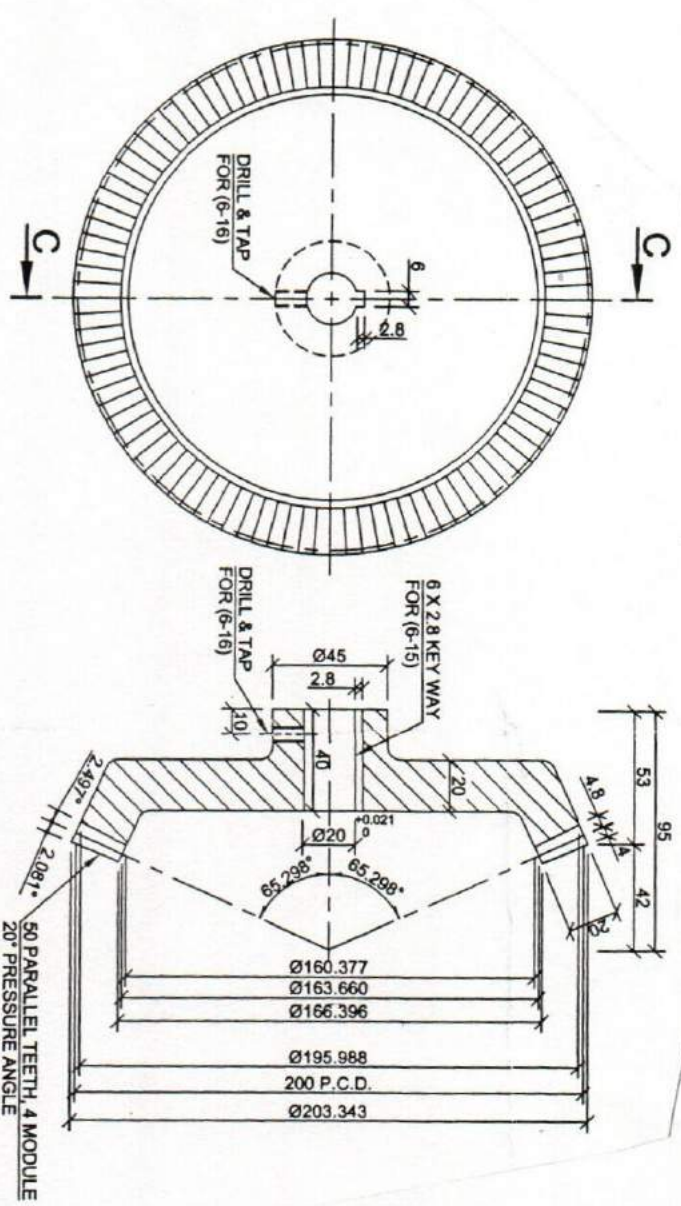

**BEVEL GEAR WHEEL** (6-5)

MATERIAL :- CAST STEEL GR. 200 - 400W OF IS: 1030

**SECTION - CC**

TOTAL QTY. REQD. = 01 (ONE) NOS.  
 Note :- (6-16) - Grab access CM 6x12 IS: 6094-10.9  
 (6-15) - Parallel key A6 x 6 x 4.5 of IS: 2048-1983.

1MT MOTORIZED SCREW HOIST FOR  
 EMERGENCY GATE FOR HR COM  
 DEPLETION SLUCE OF GHATAKESWAR  
 MULTI PURPOSE PROJECT.  
 Oct.



Annexure - XXXXVI

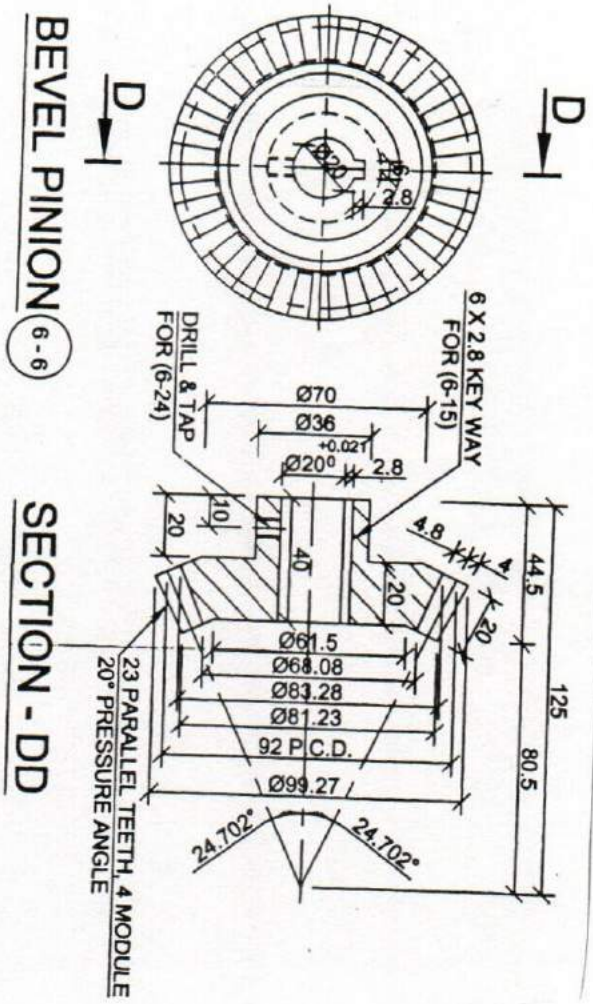

TOTAL QTY REQD. = 01 (ONE) NOS.

No. of - (6-15) - Parallel key 6x6x45 of IS: 2048 - 1983  
 (6-24) - Grob screw M6x8 IS: 6094 - 10.9

14T MOTORIZED SCREW HOIST FOR  
 EMERGENCY GATE FOR HR COM  
 DELETION SLICE OF GHATAKESWAR  
 MULTIPURPOSE PROJECT. DCLL.

Annexure - XXXVII

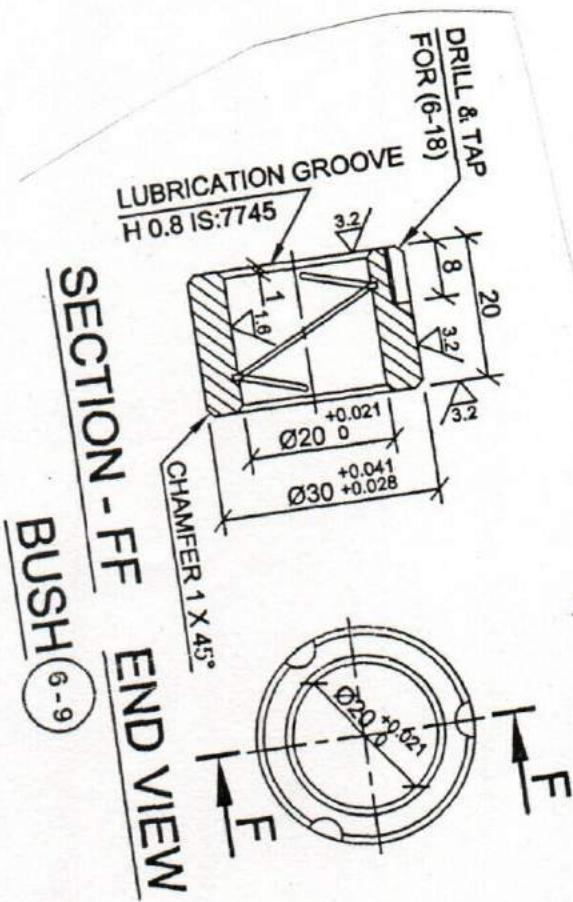

TOTAL QTY REQD. = 04 (FOUR) NOS.  
Note: (6-18) - Grub screw CM 5 X 8 IS: 6094 - 10.9.

14T MOTORIZED SCREW HOIST FOR  
EMERGENCY GATE FOR HR COM  
DEPLETION SLUCE OF GHATAKESWAR  
MULTIPURPOSE PROJECT.  
OCLL.



Annexure - XXXVII

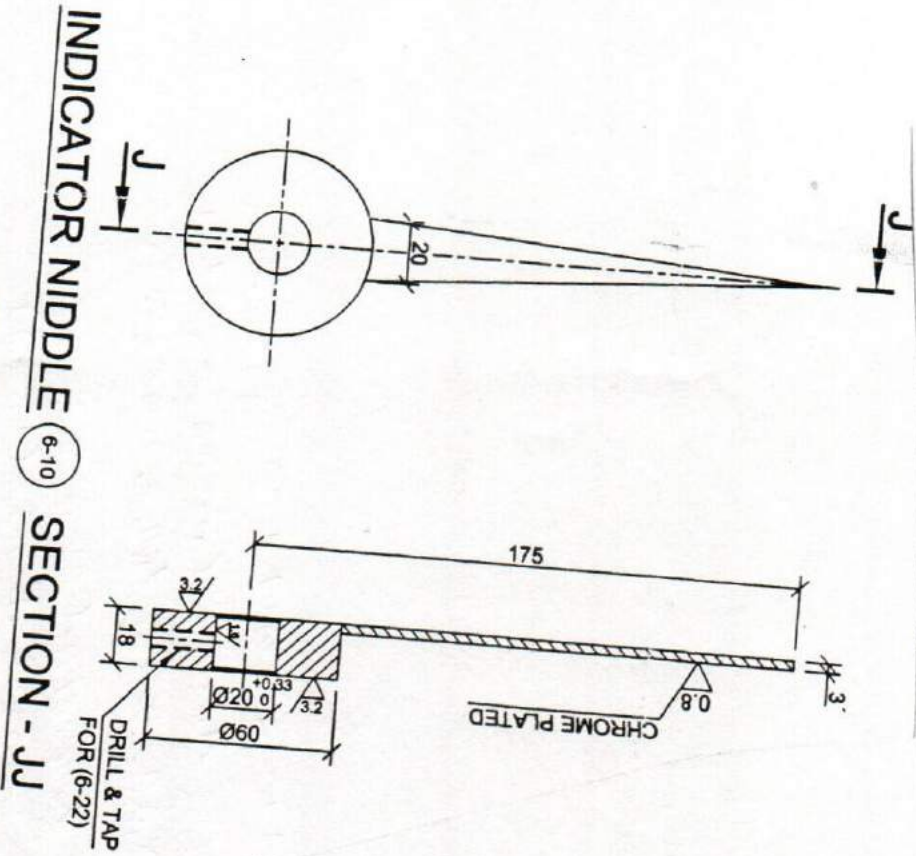

TOTAL QTY REQD. 7 (ONE) NOS.

Note:- (6-22) - Grub screws CM 6 X 20 IS: 6094 - (0.9

HT MOTORAISED SCREWS HOIST FOR  
EMERGENCY GATE FOR HR COM DEVIATION  
SERVICE OF GHATAKESWAR MULTIPURPOSE PROJECT.



Annexure - XXXIX

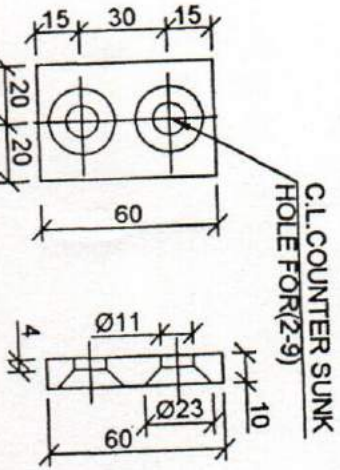

**ELEVATION END VIEW**

**BRONZE PAD (2-6)**

MATERIAL - LTB - 1 OF IS: 318-1981

TOTAL QTY REQD. = 240 (TWO HUNDRED FORTY) NOS.

Note: - (2-a) - countersunk screws M10x25 of IS: 1365-5.5

TRASH RACK FOR HEAD REGULATOR  
CUM DEPLETION SLUCE OF  
GHATAKESWAR MULTI PURPOSE PROJECT  
OCLL.

Appendure - 22

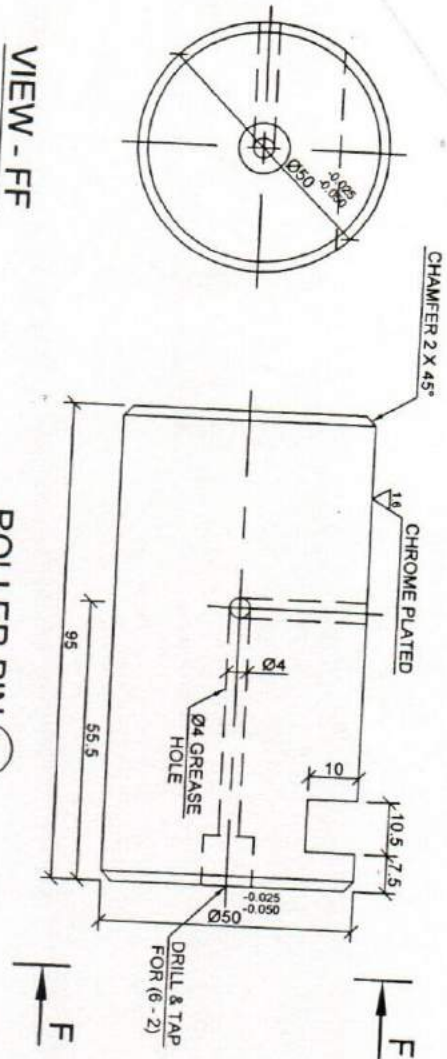

VIEW - FF

ROLLER PIN (6-1)

MATERIAL :- X04Cr.19Ni9 OF IS:1570 (PART-5)

TOTAL QTY REQS. = 12 (TWELVE) NOS.

Note:- (6-2) - conical head grease nipple AM 10X1 IS:4009 (Part-1)

REPAIR GATE FOR SILLCOAT OF  
GHATAKESWAR MULTIRRROS E PROJECT.  
OCLL.



Answer - 711

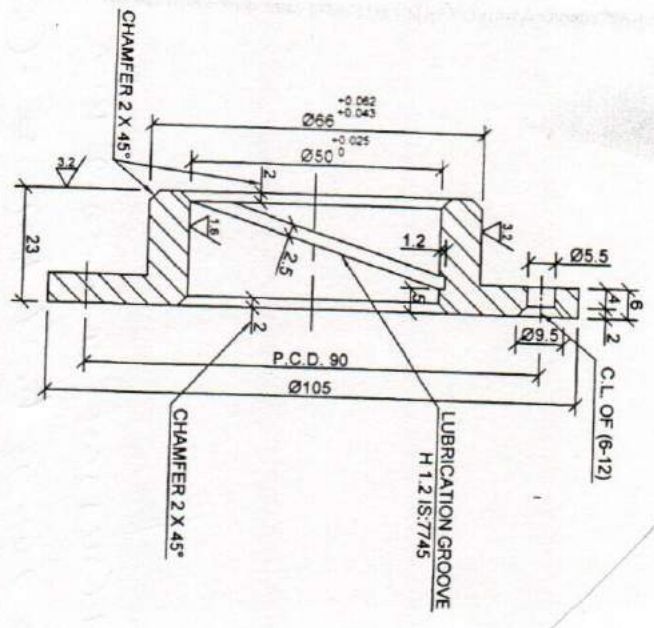
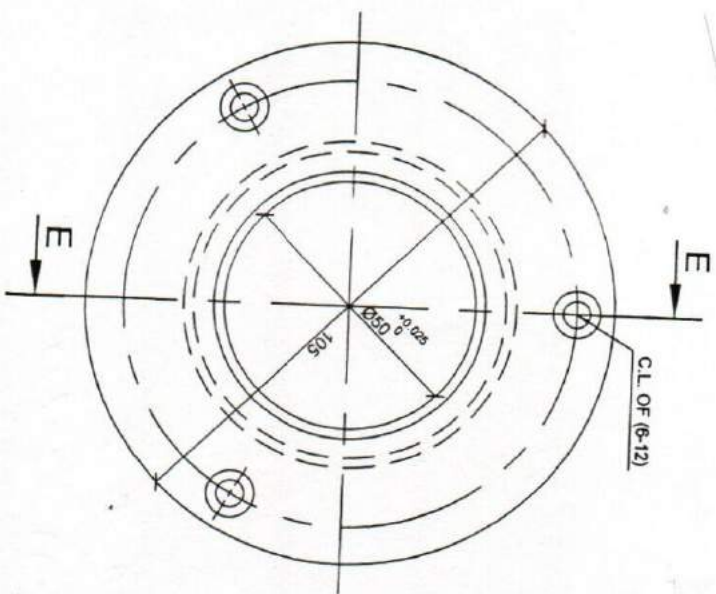

GUIDE ROLLER BUSH (6-3)

MATERIAL - LTB-1 OF IS: 318

SECTION - EE

TOTAL QTY REQD. = 24 (TWENTY FOUR) NOS.

Note: - (6-12) - counter sunk screws MS X 20 IS: 1365-4.8

RADIAL GATE FOR SPILLWAY OF  
GHATAKESWAR MULTIPURPOSE PROJECT  
DCLL.



Annexure - 8 L.I.I

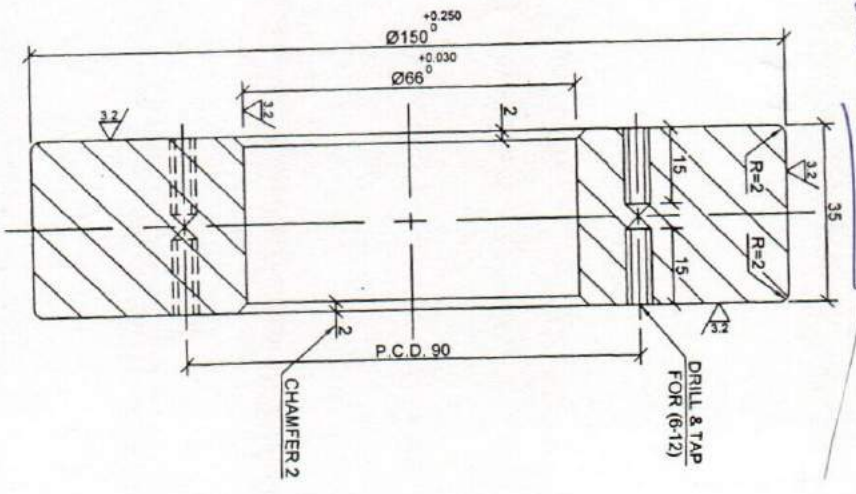
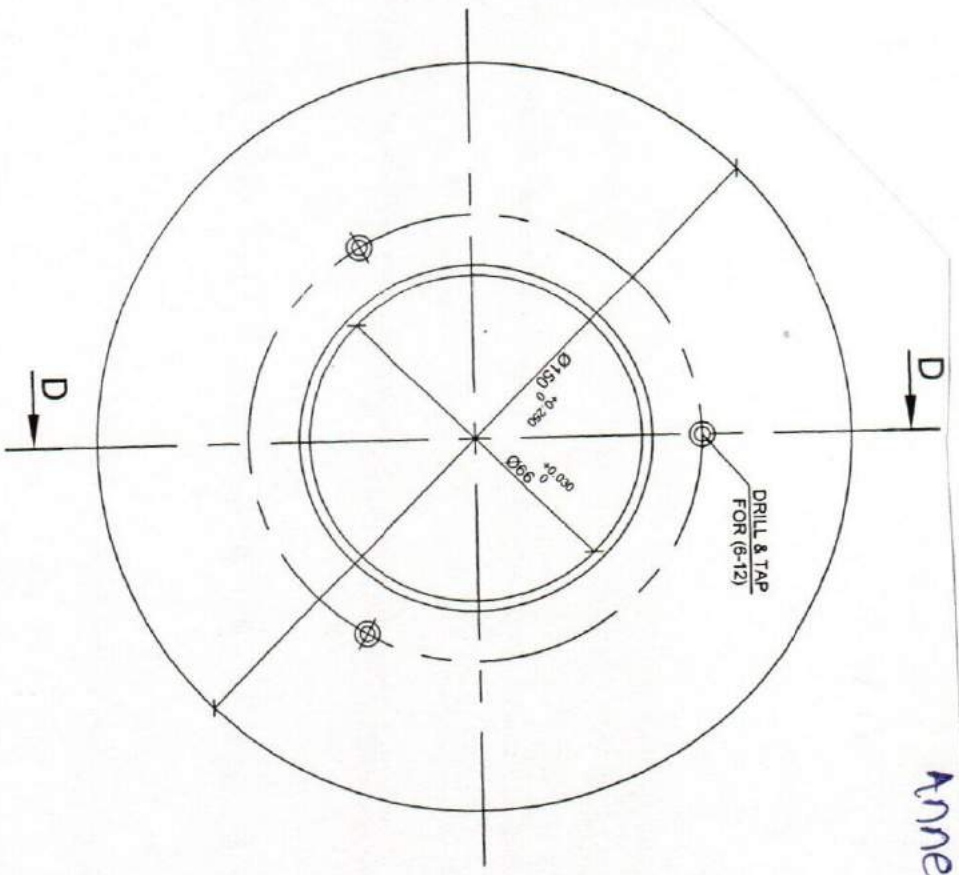

**GUIDE ROLLER (6-4)**

MATERIAL :- GR. 1 OF C.S. 640 OF IS:2044 - 1994

**SECTION - DD**

TOTAL Qty REQD. = 12 (TWELVE) NOS.

Note:- (6-12) - countersunk screws M5 X 20 IS:1365-4.8

RADIAL GATE FOR SUPPLY OF GHATAKESWAR MULTIPURPOSE PROJECT.

O.C.L.

ANNEXURE - GLIIT

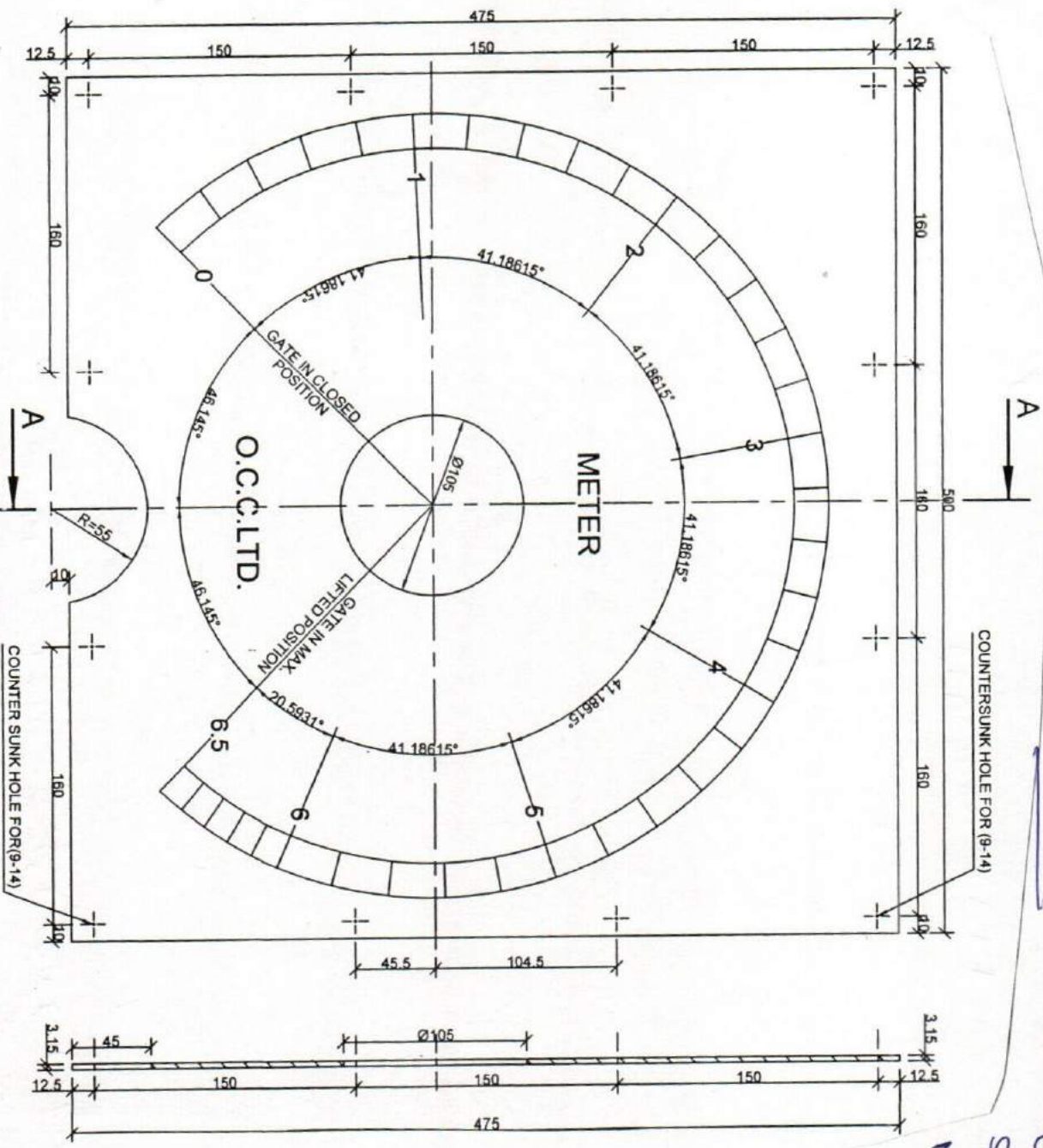

DIAL PLATE (8-1)  
 MATERIAL - BRASS CONFORMING TO IS:410

SECTION - AA

NOTE: TOTAL QTY READ. = 03 (THREE) NOS.  
 Note: (9-14) - counter sunk screws MSK10 IS: 1365 - 4.8

BST ROPE DOWN HOIST TO OPERATE RADIAL GATE FOR SPILLWAY OF GHATAKESWAR MULTI PURPOSE PROJECT.  
 O.C.C.L.



Measurement - 21.25

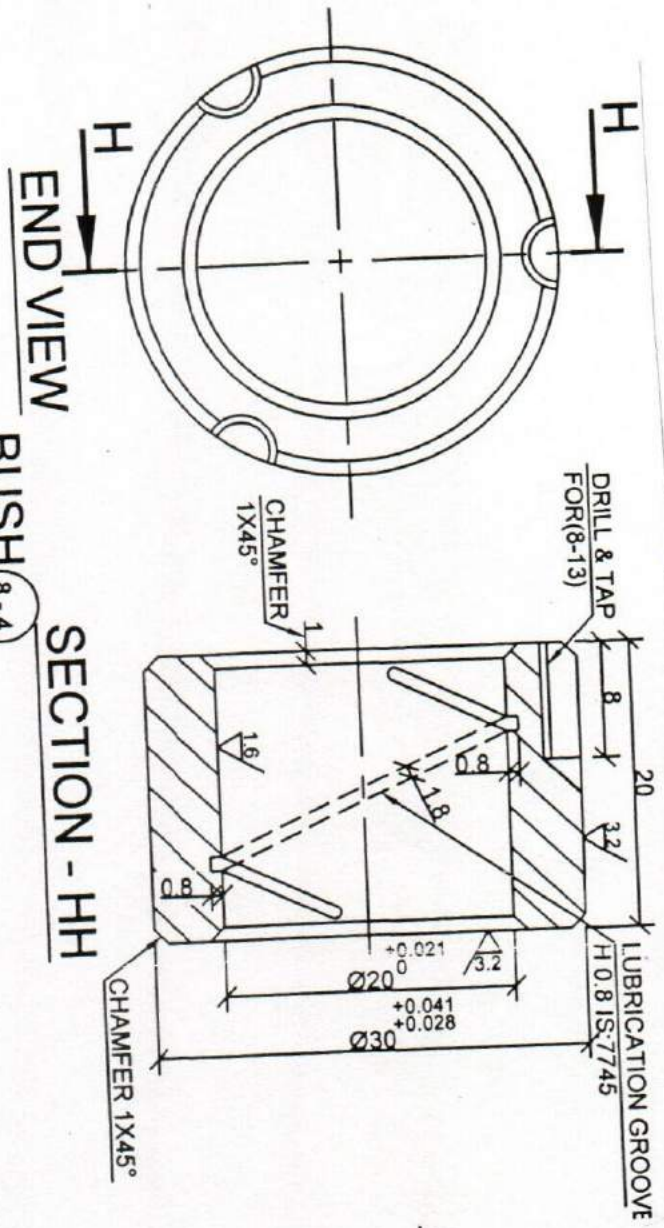

**BUSH** (8-4)  
MATERIAL :- LTB - 1 OF IS: 318

TOTAL QTY REQD. = 18 (EIGHTEEN) NOS.  
Note :- (8-13) - Grub screws CM 5 X 8 IS: 6094 - 10.9

35T ROPE FROM HOIST TO OPERATE RADIAL GATE FOR SILLCOBY OF GHATAKESWAR MULTI PURPOSE PROJECT.  
© CCL



Andhruro - 7 LCV

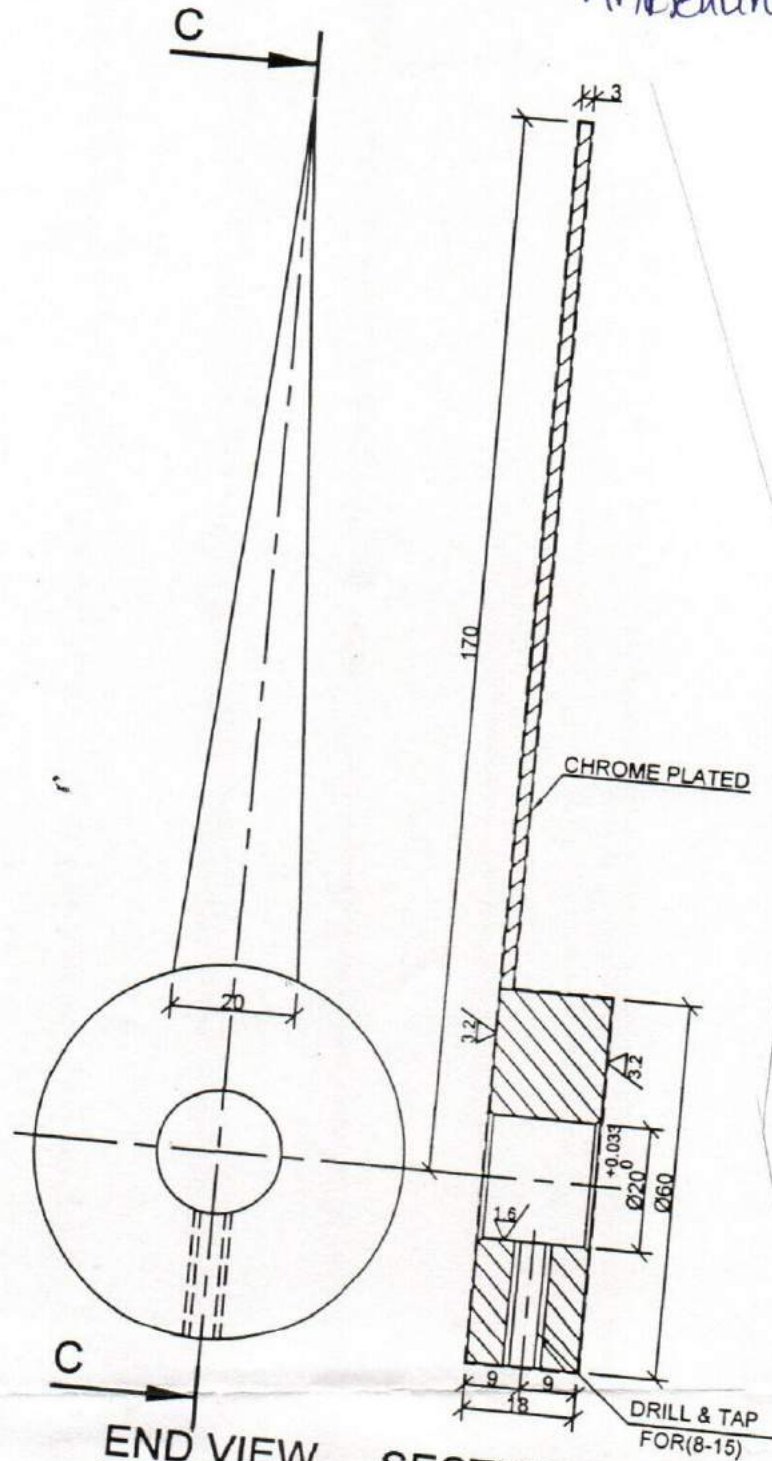

END VIEW      SECTION - CC  
INDICATOR NEEDLE (8-10)

TOTAL QTY REQD. = 03 (THREE) NOS.  
Note :- (8-15) - Grub screw M6 X 20 IS: 6094.  
10.9

35 T ROPE DRUM HOIST TO OPERATE  
RADIAL GATE FOR SPILL WAY  
OF GHATAKESWAR MULTIPURPOSE  
PROJECT. OCCL.

Annexure - XLVII

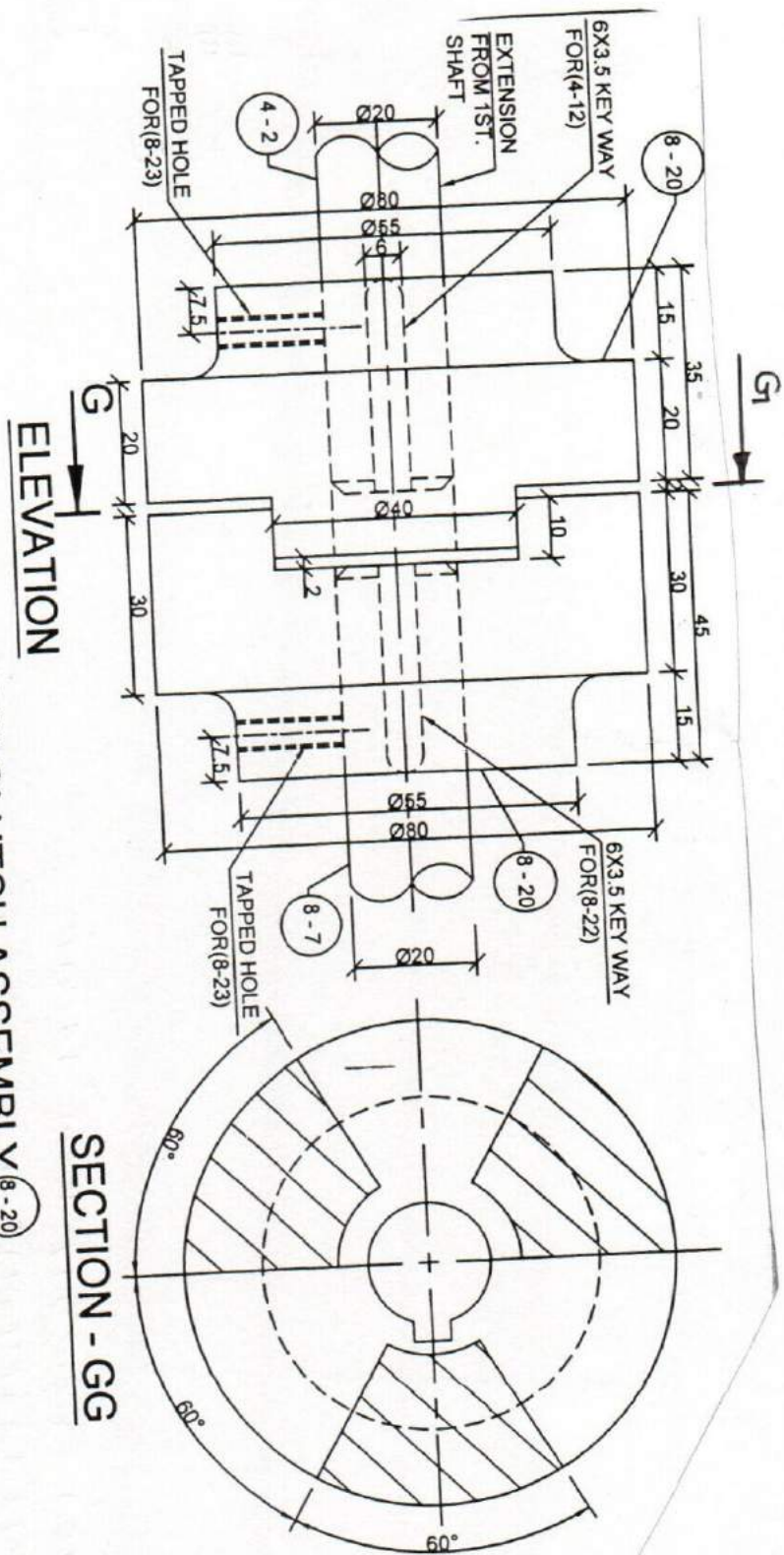

**JAW CLUTCH ASSEMBLY (8-20)**

TOTAL QTY REQD. = 03 (THREE) NOS.

Note: - (8-23) - Grub screw CMS X15 IS: 6094-10.9  
 (8-22) - Parallel key 6x3.5 IS: 2048-1983

3ST ROPE DRUM HOIST TO OPERATE  
 RADIAL GATE FOR SILLWAY OF  
 GHATAKESWAR MULTIPURPOSE PROJECT.  
 O.C.C.L.



Annexure - MILLI

12 X 4 KEY WAY SUITABLE FOR MOTOR SHAFT

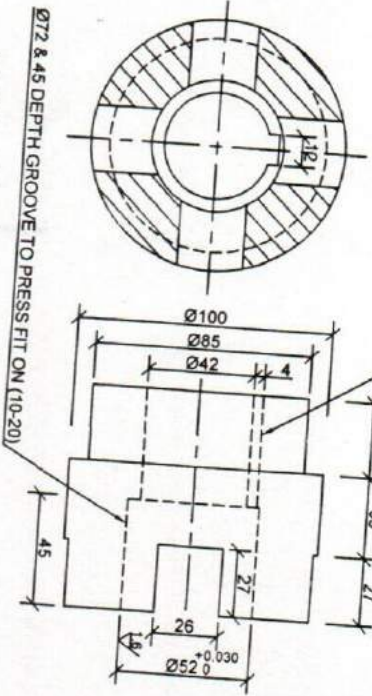

DOG CLUTCH (FIXED) (10-5)

TOTAL QTY REQD. = 03 (THREE) NOS.

10 X 4 KEY WAY FOR (10-22)

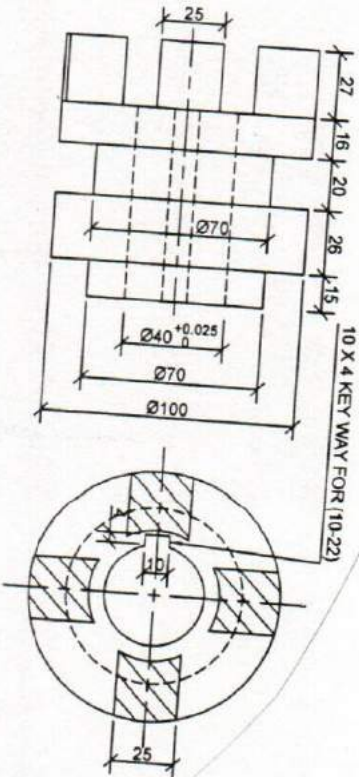

DOG CLUTCH (SLIDING) (10-4)

TOTAL QTY REQD. = 03 (THREE) NOS.

Note :- (10-22) - 10X10 - 224 long square key.

35 T ROPE DRUM HOIST TO OPERATE RADIAL GATE FOR SPILLWAY OF GWATAKESWAR MULTIPURPOSE PROJECT @CCL.

Answer - XEVEII

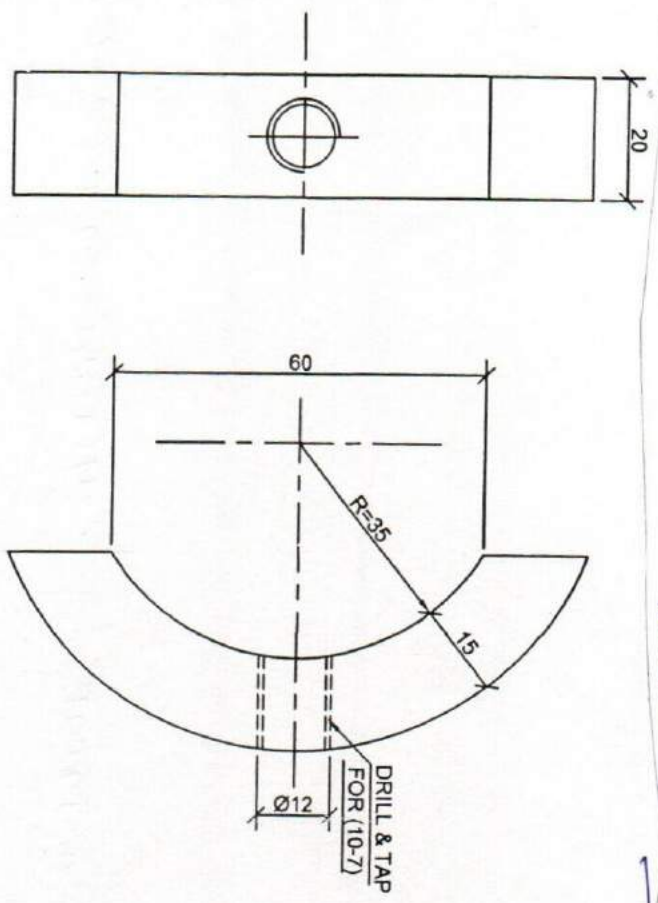

**SLIDER BUSH** (10-6)

MATERIAL - BRASS

TOTAL QTY REQD. = 06 (SIX) NOS.

Note: - (10-7) - Rim for slider bush.

35 T ROPE DRUM HOIST TO OPERATE  
RADIAL GATE FOR SILLONAY OF  
GHATAKESWAR MULTIPURPOSE PROJECT.  
OCCU.



Annexure - 21.1X

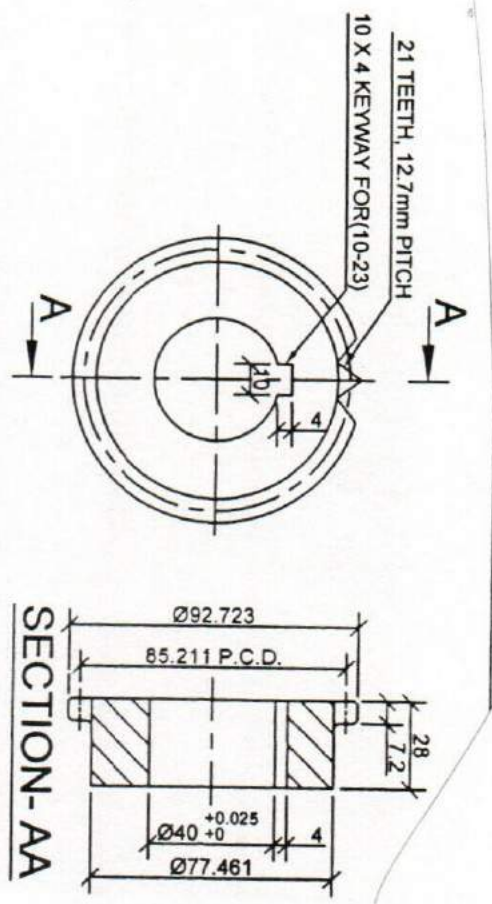

**CHAIN SPROCKET (DRIVING) (10-13)**

SPECIFICATION:-  
MATERIAL - CAST STEEL/STR STEEL  
PITCH - 12.7 FOR CHAIN 084 -1 OF IS:2403  
NOS. OF TEETH = 21

TOTAL QTY REQD. = 03 (THREE) NOS.

Note :- (10-23) - 10X10-28 long square key

35T ROPE DRUM HOIST TO OPERATE  
RADIAL GATE FOR SPILLWAY OF  
GHATAKESWAR MULTIPURPOSE  
PROJECT.  
OCCU.

Annexure - L

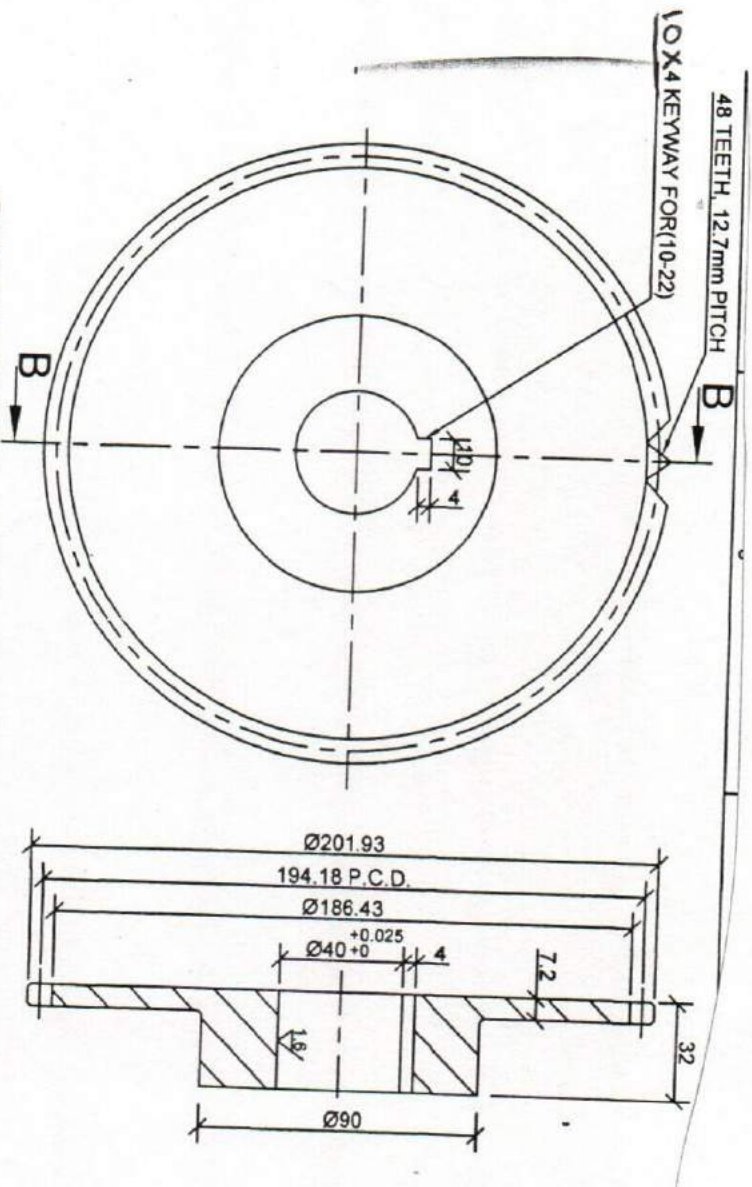

**CHAIN WHEEL (DRIVEN)** (10-14)  
SPECIFICATION :-  
MATERIAL - CAST STEEL/STR. STEEL  
PITCH - 12.7 FOR CHAIN 084 - 1 OF IS:2403  
NOS. OF TEETH = 48

**SECTION - BB**

TOTAL QTY REQD. = 03 (THREE) NOS.

Note:- (10-22) - 10x10-224 long square key.

35T ROPE DRUM HOIST TO OPERATE  
RADIAL GATE FOR SILLION OF GHAHAKESWAR  
MULTI PURPOSE PROJECT. OCC.