

ODISHA CONSTRUCTION CORPORATION LIMITED

(A GOVT. OF ODISHA UNDERTAKING)

RET SPILLWAY PROJECT

rQ. D oN/4, S.E. ,ynoloC CIWBhawanipatna ,Kalahandi-766001

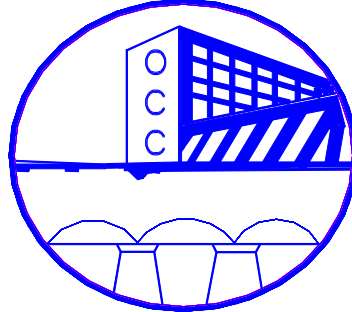

DESIGNED TO EXCEL

QUOTATION DOCUMENT

Quotation Call Notice No.OCC/ RSP/SM-II/ 01/20-21 dated. 17.11.2020

Name of work:

“Electrification to Seeds storage godown No-1, At-Bhawanipatna Dist- Kalahandi for Odisha State Seeds Corporation Limited.

(This Quotation document contains Twenty four(24) sheets including this cover page)

Sold to M/s /Sri /Smt:

TABLE OF CONTENTS

Sl. No.	Description	Pages	
		From	To
1.	Front Cover Page	1	1
2.	Table of contents	2	2
3.	Quotation Call Notice	3	4
4.	Particulars of payment of Quotation document cost (To be filled up by the Job Worker)	5	5
5.	EMD and document deposit particulars (To be filled up by the Job Worker)	6	6
6	Undertaking of Quotationer	7	7
7.	Certificate of relationship	8	8
8.	Special Terms and Conditions	9	9
9.	General Terms and Conditions	10	18
10.	Scope of work	19	19
11.	B.O.Q. & Percentage quoted form (To be filled up by the Job Worker)	20	22
12	Drawing sheets(two sheets)	22	24

Signature of the "Quotationer
With full name, date and seal

Senior Manager (Civil)
OCCL, Ret Spillway Project

**OFFICE OF THE OFFICE OF THE SENIOR MANAGER (CIVIL)
ODISHA CONSTRUCTION CORPORATION LIMITED**

(A GOVT. OF ODISHA UNDERTAKING)

RET SPILLWAY PROJECT

rQ. D oN/4, S.E. ,ynoloC CIWBhawanipatna ,Kalahandi-766001

QUOTATION CALL NOTICE NO.OCC/ RSP/SM-II/ 01/20-21 DATED. 17.11.2020.

1. On behalf of M/s. Odisha Construction Corporation Ltd, (“OCCL”), Senior Manager (Civil), Ret Spillway Project, Bhawanipatna invites %(Percentage) basis sealed Quotations from the interested reputed Electrical Contractor having (LT) license with relevant experience on L.T. erection, enlisted in OCCL and installation workfor the following works.

Sl. No.	Description of Items/works	Estimated Cost in Lakh	EMD 1(One)% of the estimated value	Cost of document + GST in	Period of work	Class of Quotationer
1	Electrification to Seeds storage godown No-1, At-Bhawanipatna Dist-Kalahandi for Odisha State Seeds Corporation Limited.	4.32	4,400.00	2240/-	One month	Electrical Contractor having LT Regd. / OCC enlisted Job worker

2. The Quotation documents may be purchased from the Office of the Senior Manager (Civil), Odisha Construction Corporation Ltd., Ret Spillway Project, Bhawanipatna during office hours from **18.11.2020to 25.11.2020** except Sundays and holidays (up to 1.00 PM of 25.11.2020)on payment of non-refundable cost of Quotation document as indicated in the table above in shape of Cash / Demand Draft drawn on any Nationalized / Scheduled Bank payable at Bhawanipatna only in favour of “M/s. Odisha Construction Corporation Ltd.”. The Quotation notice shall also be available on Corporation’s website at www.odishaconstruction.com. Interested Quotationers may obtain further information, if any, from the undersigned.
3. The Quotation must be accompanied with Earnest Money Deposit of the amount specified for the work in the table above in any one of the forms specified in the Quotation document and should be valid for 90 (ninety) days from the date of opening of Quotations.
4. The Quotations will be received in the Office of Senior Manager (Civil Odisha Construction Corporation Ltd., Ret Spillway Project, Bhawanipatna up to **2.00 PM** and will be opened on the same day i.e. **on 25.11.2020 at 3.00 PM** in the presence of the Quotationers or their authorized representative(s), if they so desires. If there will be a public holiday on the last date of sale of Quotation document and receipt & opening of the Quotations specified above, the Quotation document will be sold and

Signature of the “Quotationer
With full name, date and seal

Senior Manager (Civil)
OCCL, Ret Spillway Project

Quotations will be received and opened on the next working day at the same time and venue.

5. Intending Quotationers are required to furnish the following along with their Quotations.

- (i) Copy of valid enlistment certificate of M/s OCC Ltd.
 - (ii) Copy of valid LT license from ELBO / Electrical competent authorities.
 - (iii) Copy of valid GST registration issued by competent authorities.
 - (iv) Copy of PAN card
 - (v) Copy of document indicating residential address
 - (vi) Undertaking in prescribed format available in the Quotation document.
 - (vii) Details of Earnest Money Deposit (EMD) in prescribed format available in the Quotation document.
 - (viii) Complete Quotation documents duly filled-in and signed on each page by the Quotationer or his/their power of attorney holder with date, full name, designation and official seal.
 - (ix) EPF registration if any.
6. The authority reserves absolute right to accept or reject any or all Quotations without assigning any reason thereof.
7. The intending quotationer(s) is / are to quote their rates in the enclosed blank price schedule format
8. The successful quotationer shall have to execute the work as per scope of work, relevant drawings, technical specifications, terms and conditions of agreement.
9. Any dispute arising out of this Quotation or order thereof is to be settled in proper court under the jurisdiction of Odisha High Court.

For Odisha Construction Corporation Ltd.

Sd/-

SENIOR MANAGER (CIVIL)

Memo No. /OCC /RSP/SM-II, Dt. 17-11-2020

Copy submitted to the Managing Director, OCC Ltd., Unit-VIII, Gopabandhu Nagar, Bhubaneswar for favour of kind information and necessary action.

Sd/-

Memo No. /OCC / RSP/SM-II, Dt. 17-11-2020

SENIOR MANAGER (CIVIL)

Copy submitted to the General Manager (Civil), OCC Ltd., Southern Zone, Berhampur, Ganjam / Senior Manager (Civil) OCC Ltd, System Business Division for favour of kind information and wide circulation.

Sd/-

SENIOR MANAGER (CIVIL)

Memo No. /OCC / RSP/SM-II, Dt. 17-11-2020

Copy to Notice Board of OCC Ltd., Bhawanipatna

Sd/-

SENIOR MANAGER (CIVIL)

Signature of the "Quotationer
With full name, date and seal

Senior Manager (Civil)
OCCL, Ret Spillway Project

Particulars of Quotation document issue

ODISHA CONSTRUCTION CORPORATION LIMITED

(A GOVT. OF ODISHA UNDERTAKING)

RET SPILLWAY PROJECT

rQ. D oN/4, S.E. ,ynoloC CIWBhawanipatna ,Kalahandi-766001

Date of issue of Quotation document

Quotation Call Notice No. OCC/RSP/SM-II/ 01/20-21 DATED. 18.11.2020.

Issued in favour of :
(Full name & address)

Telephone No. – Land line :

Mobile :

Valid enlisted no of M/s OCC Ltd.:-:

Vide Money receipt No.:

Dated :

Issued by
(Stamp and signature of issuing officer)

Cost of Quotation paper : `...../- + GST @= `.....
(Non-refundable) (Rupees) only by hand /
& Postal / Courier charges of `100/- = `.....
(Rupees) only by
Registered Post /Speed Post / Courier

Signature of the "Quotationer
With full name, date and seal

Senior Manager (Civil)
OCCL, Ret Spillway Project

EMD and document deposit particulars

**DETAILS OF EARNEST MONEY DEPOSIT (EMD) AND DOCUMENTS SUBMITTED
ALONG WITH QUOTATION**

1. EMD amount
 _____ (Rupees _____) only vide
A/C Payee D.D. No. _____
Dated _____ issued by _____
Bank, _____ Branch _____

2. GST Clearance Certificate

3. P.A.N. card

4. Names of relations in O.C.C. Ltd.

5. Money receipt No. _____ Dated _____ issued
by _____ for ` _____ (Rupees
_____) only in support of
purchase of Quotation schedule.

6. Any other documents.

Full signature of "Quotationer" with date and seal.

UNDERTAKING OF QUOTATIONER

I / We Sri

(In case of the firm, the name of the proprietor / head of the firm along with the designation & name of firm should be mentioned)

S/O: Sri _____, Permanent resident of
Vill /Street: _____, P.O: _____,
P.S: _____
Via: _____, Dist: _____, State:

PIN: _____

declare that I / We have thoroughly gone through the Quotation document and I / We know the sites of works. I / We agree to work at rates quoted by me / us or at settled rates and abide by the terms and conditions of the Quotation document.

Full signature of "Quotationer" with date and seal
Present address for correspondence

Signature of the "Quotationer"
With full name, date and seal

Senior Manager (Civil)
OCCL, Ret Spillway Project

CERTIFICATE OF RELATIONSHIP

I/We hereby certify that I/We* am/ are* related/ not related* to any officer of Odisha Construction Corporation Ltd. of the rank of Manager & above and any officer of the rank of Assistant / Under Secretary and above of the Works Department, Govt. of Odisha I/We* am/are* aware that, if the facts subsequently proved to be false, my/our* contract will be rescinded with forfeiture of E.M.D and security deposit and I/We* shall be liable to make good the loss or damage resulting from such cancellation.

I/We also note that, non-submission of this certificate will render my / our Bid liable for rejection.

Signature of the Quotitioner/ Job worker

SPECIAL TERMS & CONDITIONS

- 1 The Job workers are required to inspect the site and satisfy themselves regarding availability of land for the work and other facilities for execution of same. It may be noted that, he is to complete the work within the time specified. No extension of time will be allowed in any account. If the Job worker fails to complete the work within the scheduled time or leaves the work in complete, he will have no claim on the work so executed and in this matter the decision of the Engineer-in-Charge of the Corporation is final & binding.
- 2 The quotation must be accompanied with the EMD and Additional Performance Security as specified in the quotation call notice failing which the quotation will not be considered.
- 3 The work has to be executed confirming to IS standards and specifications.
- 4 The rate quoted will be inclusive of all taxes, royalty duties and cess etc except GST. GST as per applicable to be paid extra by the corporation. The rates will be firm and binding during the entire period of execution and extension thereof. No price escalation will be paid to the job worker.
5. The contract price will be inclusive of all ancillary works /jobs e.g. approach road to work site, desilting, gangways, chutes, ramps, ladders, scaffolding and any other such works, which will not be measured but are necessary for carrying out the proposed construction. No extra payments will be made to the job worker for such ancillary works/jobs.
6. The price of the job worker will be inclusive of all finishing jobs and rectifications works as and when required. The defect liability period will be for a period of 1 year after the date of handing over. Successful completion and handing over on the part of the job worker will not resolve him from the responsibility of attending to all the required rectifications and maintenance of the system during the defect liability period.
7. The job worker will be fully responsible for the safety of the work, property and workmen. The job worker will provide proper insurance cover for the work and property against any damage due to accidents, construction, natural calamities or otherwise from the date of commencement till the end of defect liability period and also insurance cover against possible accidents and personal injuries to workers and workmen during the period of construction.
8. The job worker's rates will be inclusive of cost of all the materials & hire running charges of machinery which will be procured and utilized by him as per the directions of the Engineer-in-charge and adhering to the work programme. In case, any hire machinery/ material is procured / purchased by OCC Ltd. and the same is handed over to the job worker for utilization in the work, the cost of such material(s) inclusive of cost of transportation and handling charges thereof will be recovered / deducted from the bills / dues of the job worker as per approve rate of corporation. The cement & reinforcement to be supplied by corporation at one point of work site but storage & watch ward will be borne by the Job worker.
9. During execution of the work, if it is required to carry out any extra item of work not provided in the BOQ the same will be executed by the job worker as per the directions of the Engineer-in-charge. The item(s) of work will be paid to the Job worker at schedule of rate for actual execution and the same will be binding on the Job worker.

Signature of the "Quotationer
With full name, date and seal

Senior Manager (Civil)
OCCL, Ret Spillway Project

GENERAL TERMS AND CONDITIONS

1. DEFINITIONS

- (i) **“CORPORATION”** means **“ODISHA CONSTRUCTION CORPORATION LTD. (“OCCL” in short)**” with registered office at Unit-8, Gopabandhu Nagar, Bhubaneswar – 751 012 (Odisha) represented through its Managing Director or any other officer as designated by the “Corporation” from time to time.
- (ii) **“ENGINEER-IN-CHARGE”** means the engineer of the “Corporation” who will be in the charge of the work.
- (iii) **“JOB WORKER”** means the enlisted person/firm/organisation having men, machinery, materials etc. to execute the work satisfactorily as per scope indicated herein within stipulated period.
- (iv) **“CLIENT”** means the State Govt. or Central Govt. organization or any individual from whom “OCCL” has received the work for execution.

1. AGREEMENT

The “Job worker” shall enter into an agreement with the “Engineer-in-Charge” in the format on requisite value of stamp paper prescribed for the purpose by the “Corporation” within a stipulated period to be specified by the “Engineer-in-Charge” failing which the EMD and ISD shall be forfeited. The work may be awarded in favour of some other agency at the discretion of the “Corporation”.

3. RATE

The percentage rates quoted by the quotationer shall be valid for the full period of execution or till completion of work whichever is later. No escalation or price variation in whatsoever form shall be entertained.

The “Job worker” shall quote the rates percentage basis to complete the works as per specifications inclusive of all transportation, handling, loading, unloading, lift, delift, taxes, duties, levies, incidental expenses etc. that will be applicable on the work to be executed by him. No claim in this regard in whatsoever form shall be entertained.

4. PAYMENT TERMS

- (i) No advance, No price escalation and price adjustment shall be paid for the work. The rates shall remain firm throughout the agreement period.
- (ii) The payment to the “Job worker” shall be limited to the measurements taken and accepted by the client. The “Job worker” cannot raise any dispute over the measurements allowed by the “Engineer-in-Charge” for the purpose of payment.
- (iii) The Job worker will bear the full cost of rectification or replacement of works required as per direction of “Client” or “Engineer-in-Charge”.
- (iv) Any penalty levied by “Client” on “OCCL” due to delay in work will be borne by the “Job worker” in full, if the “Job worker” is responsible for delay.

5. INITIAL SECURITY DEPOSIT (ISD)

The “Job worker” shall deposit Initial Security Deposit (ISD) at the rate of 2(Two) % of the work/agreement value on receipt of letter of intent of work within a period of 15 days from the date

Signature of the “Quotationer
With full name, date and seal

Senior Manager (Civil)
OCCL, Ret Spillway Project

of issue but before execution of agreement. After receipt of the full ISD, the EMD received along with the quotation shall be returned.

If the quotationer desires, the EMD can be converted to ISD and the balance amount of ISD has to be deposited. If the "Job worker" fails to deposit such initial security within the stipulated date, the EMD of the "Job worker" shall be forfeited and the work may be awarded in favour of some other agency at the discretion of the "Corporation".

6. SECURITY DEPOSIT (SD)

The Security Deposit (SD) at the rate of 5(Five)% shall be deducted on the gross amount of each bill of the "Job worker". The security will be released after 12(Twelve) months of completion of the work or settlement of final bill of the "Job worker", whichever is later, if no defect in the work is noticed and material account as well as all disputes including compliance of labour rules, ESI rules etc. are settled.

7. ADDITIONAL SECURITY DEPOSIT

The "Engineer-in-Charge" may, if he feels it necessary can deduct and withhold from the bill of the "Job worker" a sum not exceeding 10% and not less than 5% of the gross value of work done as additional security deposit for the rectification of defective and/or unsatisfactory work.

The additional Security Deposit shall be deducted in addition to normal security deposit. Such defects shall be rectified by the "Job worker" within such period as the "Engineer-in-Charge" may fix-up and if the "Job worker" fails to rectify the defects within the specified period, this shall be rectified by the "Engineer-in-Charge" at the cost and risk of the "Job worker". The expenses so incurred in the rectification of the defective works and/or unsatisfactory work done by the "Job worker" shall be recovered from the bills or any other dues of the "Job worker" or otherwise as per law. In this connection, the decision of the "Engineer-in-Charge" shall be final and binding on the "Job worker". The additional security deposit shall be released in full, when the "Job worker" rectifies the defects in time at his cost.

8. WITH HELD AMOUNT FOR EPF, FPF AND ESI DUES

2(Two) % shall be deducted and kept withheld from R.A. bills of the "Job worker" towards EPF, FPF and ESI dues. If the "Job worker" produces either a clearance in support of deposit of EPF, FPF and ESI dues with the concerned authority within 3(Three) months from the end of each financial year then the above withheld amount shall be released. Otherwise, the "Corporation" shall deposit the same with Provident Fund Authority and ESI Authority. Defects, if any, shall be recovered from the "Job worker".

9. INCOME TAX, GST, CESS OTHER TAXES, DUTIES, LEVIES ETC.

(a) Income tax @ 1% to 2% or at the prevailing rate from time to time will be deducted from each bill of the "Job worker" and shall be deposited with Income Tax Authorities.

(b) T.D.S. on GST @ 2% (1% towards SGST + 1% towards CGST) to be deducted on basic value of R.A. bill & deposited with concern Dept. By Corporation.

(c) Cess @ 1% of the gross work bill shall be deducted from Job workers R/A bills & to be deposit with concern Dept..

(d) Any other taxes, duties, royalties, levies etc. as applicable from time to time shall also be deducted.

10. OPTIMUM USE OF MACHINERY, VEHICLES, EQUIPMENTS, TOOLS, TACKLES, CONSUMABLES AND STEEL MATERIALS

The "Job worker" shall ensure optimum utilisation of the plants, machinery, equipments, tools, tackles, consumables, cement, steel materials etc. and shall not create any hindrance for others. The decision of the "Engineer-in-Charge" regarding the optimum requirement shall be final and binding on the "Job worker".

11. RECORD OF MATERIALS, CONSUMABLES, MACHINERY, EQUIPMENTS, TOOLS, TACKLES ETC.

The "Job worker" shall be responsible for maintaining the data and complete records of issue and consumption of materials and consumables as well as record of plants, machinery, equipments, tools, tackles, cement, steel materials etc. issued to him by the owner and "Corporation". The materials, plants, machinery, equipments, tools, tackles cement, steel materials etc. shall be issued as per requirement and availability only.

The materials supplied by the "Corporation" will be received by the "Job worker" from the "Corporation" store on submission of indent by the "Engineer-in-Charge". Transportation of materials to site of work and storage at site are the responsibility of the "Job worker".

The "Job worker" will keep an accurate record of "Corporation" materials and furnish the consumption statement of such materials. The surplus materials, if any, are to be returned to the "Corporation" store at his cost failing which, the cost of excess materials will be recovered from the dues of the "Job worker" @ 5(Five) times the issue rate of "OCCL" or market rate, whichever is higher.

The materials, if and when supplied by the "Job worker", shall be of the best and suitable quality as per specifications stipulated in the technical specifications and subject to approval of "Engineer-in-Charge"/"Client", whose decisions, as regards quality of the materials, shall be final.

12. RETURN OF PLANTS, MACHINERY, EQUIPMENTS, TOOLS, TACKLES, MATERIALS, CONSUMABLES ETC.

The plants, machinery, equipments, tools, tackles, excess cement, excess steel materials, excess consumables etc. of the "Corporation" are to be returned by the "Job worker" in good working condition after completion of the work/termination of the contract by the "Corporation". The "Corporation" may hire plants, machinery, equipments, tools, tackles etc. from the owner as well as outside for use in work. The same are also to be returned by the "Job worker" in acceptable good working condition with original fittings after completion of the work/termination of the contract by the "Corporation".

Any damage to/ by the plants, machinery, equipments, tools, tackles etc. during use by the "Job worker" shall be booked to the "Job worker" for recovery from his bills.

The balance unused/excess cement, steel materials, balance consumables etc. of the "Corporation", if any, shall be returned by the "Job worker" in good condition at specified places as per direction of the "Engineer-in-Charge" failing which the cost at 5(Five) times the market rate shall be deducted from the "Job worker".

13. EMPTY CEMENT BAGS AND SCRAP STEEL MATERIALS/CUT PIECE RODS

The cost of empty cement bags against cement issued by "OCCL" shall be deducted by "OCCL" from the bills/dues of the "Job worker" @ Rs.3.75 (Rupees three and paisa Seventy Five) only per bag.

Signature of the "Quotationer"
With full name, date and seal

Senior Manager (Civil)
OCCL, Ret Spillway Project

The scrap steel materials/cut piece rods generated during execution of work out of steel materials issued by “OCCL” shall be the property of the “Corporation”. It is the responsibility of the “Job worker” to collect and stack them at proper location/locations as per direction of the “Engineer-in-Charge”. The “Job worker” shall be responsible for return of the same. An unaccounted loss of 0.5% shall be allowed. Balance has to be returned to the “Corporation”. In case of non-return of the same, the cost as decided by the “Engineer-in-Charge” shall be recovered from the “Job worker”.

14. ELECTRICITY

Electricity required for execution of work is to be arranged by the “Job worker” or the “Job worker” shall arrange generator for execution of works.

15. MEASUREMENT OF WORK

The quantity of work executed shall be measured and payment made once in a month or on completion of work or on termination of the agreement, when final measurement will be made and account will be adjusted accordingly. The decision of the “Engineer-in-Charge” regarding the rates, progress, measurement and quality of the work shall be final and binding on the “Job worker”.

16. INDIAN STANDARDS, DRAWINGS AND SPECIFICATIONS

The work shall be carried with due diligence and in a workman like manner in accordance with relevant Bureau of Indian Standard specifications on the basis of latest approved drawings and technical specifications supplied by “Corporation” in absence of which as per the direction of “Engineer-in-Charge”.

The technical specifications in the relevant agreement between the “Corporation” & owner and approved drawings & technical specifications issued by the owner & “Corporation” shall be the basis for execution of work under the agreement. In the absence of approved drawings and technical specifications, the direction of the “Engineer-in-Charge” shall be final and binding on the “Job worker”.

The “Job worker” shall make arrangements to take copies of the approved drawings from the office of the “Engineer-in-Charge” for reference during execution of work.

17. PAYMENT TO WORKMEN

The “Job worker” should maintain job register and payment rolls of their workmen and get those checked by the “Engineer-in-Charge” or his authorised representative from time to time. The payment to the workers/ supervisory staff shall be made by the “Job worker” in the presence of the owner and/or “Engineer-in-Charge” or his authorised representative. The paid pay roll register shall be signed by the “Engineer-in-Charge” or his authorised representative as a token of disbursement. The copies of paid pay roll shall be submitted to the “Engineer-in-Charge” within a period of 7(Seven) days from the date of payment failing which no further payment to the “Job worker” shall be released.

18. WORKMEN COMPENSATION

In case of any loss due to accident arising during/in connection with execution of the contract, the “Job worker” will pay compensation to his workmen. The “Job worker” will be fully responsible for his workmen as per workmen’s compensation act and labour laws in force during entire period of execution of contract. In case, the “Job worker” fails to do so, the “Corporation” may pay the same and recover the same from the bills/ dues of the “Job worker”.

19. INFORMATION OF WORKMEN

The “Job worker” will make his own arrangements for procurement of labour and shall furnish all information of workmen employed by him like name, father’s name, full permanent address, sex and age to the “Engineer-in-Charge” along with the pay.

20. STATUTORY REQUIREMENTS

The “Job worker” shall comply all statutory requirements applicable at site of work such as minimum wage act, labour act, factory act, workmen’s compensation act, provident fund rules, employee’s state insurance rules etc. A certificate to this effect shall be enclosed by the “Job worker” with each Running Account Bill for payment.

21. MINIMUM AGE OF WORKMEN

The “Job worker” shall not employ any person, who is below the age of 18(Eighteen) years or unfit for the quoted items. The “Engineer-in-Charge” shall have right to decide, whether any labour employed by the “Job worker” is below the age of 18(Eighteen) years or unfit and refuse to allow any labour, whom he decides to be below the age of 18 years or unfit for any other reason.

22. LABOUR LICENCE

The “Job worker” has to obtain valid labour licence and maintain all records at his own cost as per the conditions laid down in the labour rules in vogue and amended from time to time.

23. MINIMUM WAGE ACT

The “Job worker” shall pay wages of each labour at the rate not less than the wages as per Minimum Wages Act in force and as may be ammended from time to time. The “Engineer-in-Charge” has the right to enquire into and decide on any complaint of the labourers relating to non-payment or less payment of wages to them and his decision will be final and binding on the “Job worker”.

24. NON-PAYMENT OF DUES OF LABOURERS

If the “Job worker” fails to pay the dues of labourers engaged by him for this work in time, the same shall be paid by the “Engineer-in-Charge” directly to the deserving workers. The expenditure so incurred on account of non-payment or less payment shall be recovered from the bills or any other dues of the “Job worker”.

25. PROVIDENT FUND (PF)

Employees Provident Fund., wherever applicable, shall be payable by the “Job worker” as per the Provident Fund Rules in force and shall keep the “Corporation” indemnified for it. He should get the registration number for this from the Regional Provident Fund Commissioner, Odisha. He shall produce the records in support of payment of EPF/FPF dues to the “Engineer-in-Charge” for check and record by the “Engineer-in-Charge”.

26. EMPLOYEES STATE INSURANCE SCHEME (ESI)

The Employees State Insurance Scheme(ESI), wherever applicable, shall be payable by the “Job worker” as per the E.S.I. Rules in force and shall keep the “Corporation” indemnified for it. He should get the Registration Number for this from the E.S.I. Deptt., Odisha. He shall produce the records in support of payment of ESI dues to the “Engineer-in-Charge” for check and record.

27. **WORKMEN INSURANCE**

The workmen insurance shall be the responsibility of the “Job worker”. He shall produce the records in support of workmen insurance to the “Engineer-in-Charge” for check and record.

28. **HUTMENTS/TEMPORARY ACCOMMODATION**

The “Job worker” has to arrange hutments/temporary accommodation for his own labourers/ workmen at the work site at his own cost.

29. **IDLE LABOUR**

“OCCL” will not be held responsible for idle labourers of the “Job worker” for any reason, whatsoever and no claim on this account will be entertained.

30. **WORKING IN SHIFTS**

If necessary, the “Job worker” may be asked to work in two(2) or 3(three) shifts. Normally, the work shall be executed in shifts. The “Job worker” may, if required, have to engage the workmen on overtime to complete the work in scheduled time. The overtime cost shall be borne by the “Job worker”.

31. **CLAIMS AND LIABILITIES**

All claims/liabilities etc. arising out of Explosives act and labour laws shall be borne by the “Job worker” and he shall keep the “Corporation” indemnified against them and also in case of injuries or death of labourer(s) resulting from accidents during the execution of the work. In case the “Corporation” will have to pay for any such claims under Workmen’s Compensation Act, the same shall be adjusted from the pending bills/dues of the “Job worker” or shall be recovered otherwise as per law from him.

32. **SAFETY**

The “Job worker” should abide by the safety laws and rules of statutory bodies, “Corporation” and owner as per directions of “Engineer-in-Charge” and Safety Officers inspecting from time to time.

33. **WATCH AND WARD**

The “Job worker” shall arrange watch and ward and safety of the site of work, constructed structures, machinery, vehicles, equipments, tools, tackles, consumables, cement, steel materials etc. of the “Corporation” and owner at his own cost.

34. **AUTHORISED PERSON**

The “Job worker” may in writing authorise his power of attorney holder or any other person to draw materials, avail facilities, and attend measurements etc. during the course of execution of work. All liabilities created by the authorised person of the “Job worker” by way of loss of materials drawn, amenities availed, unpaid wages created etc. shall be considered as the liabilities of the “Job worker” and such liabilities shall be made good by the “Job worker” or it shall be recovered from the bill/payment due to him.

35. **SPLITTING UP WORK**

The authority reserves the right to split up the work amongst various “Job workers” and increase or decrease the quantity of work mentioned in the quotation document without assigning any reason thereof and no claim whatsoever will be entertained on this account. The quantity as per agreement may also increase or decrease as per actuals.

If “Corporation” desires, different agencies can be engaged at a single site of work for which each agency is to co-operate so that other agency does not face any difficulty in engagement of his machinery, equipments, vehicles etc.

36. BREACH OF CONTRACT

The ISD including EMD, SD and additional SD are liable to be forfeited in the event of breach of contract and the agreement shall be terminated. The dues of the “Corporation” including due of labourers/workmen and other statutory payable liabilities payable by the “Corporation” as principal employer shall be cleared by the “Job worker”. The decision of the “Engineer-in-Charge” in this regard shall be final and binding on the “Job worker”. The amount remaining as outstanding against the “Job worker” after adjustment of his dues shall be payable by him to “OCCL”. If necessary, legal action may be taken for recovery of the dues of the “Corporation” including labour and statutory dues to be cleared by the “Corporation” as principal employer and “OCCL” reserves the right to recover the payable amount from the “Job worker” from works done by his under any other organization or from his properties.

37. TERMINATION OF CONTRACT

The “Engineer-in-Charge” may put an end to the agreement at his option at any time due to (a) Bad workmanship (b) Dis-proportionate progress (c) Non-compliance of labour rules or (d) Any other reason. The decision of the “Engineer-in-Charge” is final in this respect and no claim on this account will be entertained. “OCCL” also reserves the right to take ex-parte measurements, if the “Job worker” does not co-operate in taking final measurements after termination of contract.

38. RESPONSIBILITY OF JOB WORKER

The work shall be completed by the “Job worker” in all respect within the stipulated period of completion and the responsibility of the “Job worker” shall cease only, when the items are fully accepted by the owner after erection at project site.

39. PROGRESS OF WORK AND PENALTY

The “Job worker” will achieve the desired progress as per programme.. If the “Job worker” fails to achieve the contracted quantity every month as per programme, penalty at the following rates shall be imposed.

Sl. No.	Failure percentage(%)	Penalty percentage(%)
(i)	Less than 10(Ten)%	1(One)% of value of defaulted quantity
(ii)	Above 10(Ten)% and upto 20(Twenty)%	2(Two)% of value of defaulted quantity
(iii)	Above 20(Twenty)% and upto 30(Thirty)%	5(Five)% of value of defaulted quantity
(iv)	Above 30(Thirty)%	To be asked to demobilise with penalty equivalent to 10(Ten)% of value of defaulted quantity. The “Engineer-in-Charge” will off-load the work and get the work done through any other agency or of its own at the risk and cost of the “Job worker”. No claim will be allowed to the “Job worker” in this regard.

40. REJECTION DUE TO BAD WORKMANSHIP

The rejection due to bad workmanship shall be charged to the “Job worker” at a cost of rejected items plus 20(Twenty) %.

Signature of the “Quotationer
With full name, date and seal

Senior Manager (Civil)
OCCL, Ret Spillway Project

41. TESTING OF WELDERS AND OTHER SKILLED/SEMI-SKILLED WORKMEN

The qualification test of welders and other skilled/semi-skilled workmen may be conducted at site by the “Engineer-in-Charge” and only qualified welders and other skilled/semi-skilled workmen shall be deployed for the work. The cost of testing shall be borne by the respective “Job worker”.

42. QUALITY ASSURANCE AND QUALITY CONTROL

Quality Assurance/Quality Control Plan shall be prepared before commencement of site activities and shall be followed maintaining stage-wise up-to-date record of the work.

43. SITE VISIT

The “Job worker”, interested to participate in the quotation, should visit the site of work and get himself acquainted with site conditions and quoted work before submitting the quotation.

44. DEVIATION OF PROVISIONS IN AGREEMENT

The “Job worker” will not vary or deviate from the provisions in the agreement without obtaining prior permission in writing from the “Corporation”.

45. RIGHT OF THE “CORPORATION”

The “Corporation” reserves the right to cancel a particular quotation call or all quotation calls without assigning any reason thereof. The items can be splitted among two or more quotationers at any stage. The offer of any quotationer or all may be cancelled without assigning any reason thereof. The requirement shown in any quotation call notice are only indicative and may vary.

46. APPROACH ROAD, HAUL ROAD ETC.

The approach road, haul road etc. if required, at site of work are to be constructed and maintained by the “Job worker” at his cost.

47. SUB-LETTING

The work under any agreement shall not be assigned or sublet to anybody by the “Job worker”. If the “Job worker” shall assign or sublet or attempt to do so, the “Engineer-in-Charge” shall terminate the agreement and shall get the work done through any other agency or of its own at the risk and cost of the “Job worker”. No claim will be allowed to the “Job worker” in this regard. “OCCL” reserves the right to have access also to units of the “Job worker” to verify, if works are actually executed by him.

48. EXECUTION OF EXTRA ITEMS AND EXTRA QUANTITIES

All extra items are to be executed by the “Job worker” at current schedule of rates. All extra quantities are to be executed at agreement rates. If required, the “Job worker” has to furnish the working analysis as per actual to arrive at the extra items rates.

49. FORCE MAJEURE:

Neither party shall be liable to the other for any loss or damage occasioned by or arising out of acts of God such as unprecedented flood, volcanic eruption, earthquake or other convulsion of nature and other acts such as but not restricted to invasion, the act of foreign countries, hostilities, or war-like operations before or after declaration of war, rebellion, military or unrobed power which prevent performance of the contract and which could not be foreseen or avoided by a prudent person.

Signature of the “Quotationer
With full name, date and seal

Senior Manager (Civil)
OCCL, Ret Spillway Project

JURISDICTION

For all liabilities created under the various contractual obligations/impositions under this agreement, the “Job worker” undertakes not to raise any dispute or litigations in connection there with and shall make all endeavors to resolve all disputes amicably through conciliation and in all such cases, the decision of the Managing Director, “OCCL” shall be final and binding on the “Corporation” as well as on the “Job worker” failing which all such disputes arising out of the agreement shall be subject to jurisdiction of Hon’ble High Court of Odisha at Cuttack and their subordinate courts at Bhubaneswar only. Both the parties agree by mutual consent that any dispute relating to this agreement is barred from arbitration.

Signature of the “Quotationer
With full name, date and seal

Senior Manager (Civil)
OCCL, Ret Spillway Project

SCOPE OF WORK FOR JOB-WORKER

- 1) The Quotationer has to supply all switch gears, contactors and reversible starters of reputed manufacturer like Havells, C & S, BCH & Simens or any other ISI marked.
- 2) The Quotationer has to supply the power cables of reputed make (Finolex / Havells / Polycab / any other reputed make) certificates as per IS code and as per enclosed price schedule.
- 3) All the materials will be inspected by Engineer-in-Charge / or his authorized representative before dispatch on prior intimation.

OFFICE OF THE SENIOR MANAGER (CIVIL)
ODISHA CONSTRUCTION CORPORATION LIMITED
 (A GOVT. OF ODISHA UNDERTAKING)
RET SPILLWAY PROJECT
rQ. D oN/4, S.E. ,ynoloC CIWBhawanipatnaidnahalaK ,-766001

BILL OF QUANTITY

Name of work: - Electrification to Seeds storage godown No-1, At-Bhawanipatna
 Dist- Kalahandi for Odisha State Seeds Corporation Limited.

SI. No.	Description of Items	Unit	Qty.	Rate	Amount
1	Surface wiring to light point /Fan point / Exhaust fan point / Call bell point with 1.5 Sq.mm FR PVC insulated single core multistrand copper conductor of ISI marked with 20mm dia non-metallic PVC flexible conduit with 5A.25 on MS box having front Bakelite cover of suitable size, MS box with 1.5sq.mm FR PVC insulated single core multistrand cooper conductor as earth wire including all accessories and connection (Make of wire Finolex / L&T / Anchor/Havelles/V-Guard/Great White/HPL)	Nos.	40.00	1528.00	61120.00
2	Recessed extra lead sub main wiring in 2 x 1.5 sq.mm + 1 x 1.5sq.mm PVC insulated single core multistrand copper conductor of ISI marked conforming to IS-694/1990 in the following mm dia non-metalic heavy duty flexible conduit 1.6 mm thick along with the following sq.mm FR PVC insulated single core multistrand copper conductor as earth wire as required (Make of wire – Finolex / L&T / Anchor/Havells/V-Guard/HPL)	Mtr.	250.00	132.95	33237.50
3	Supply and fixing of 5Amp plug with switch on existing board (Piano type)	Each	5.00	229.20	1146.00
4	Surface Submain wiring along with earth wire with the following sizes of PVC insulated single core multistrand copper conductor ISI marked conforming to IS-694/1990 in 20mm dia non metallic heavy duty flexible conduit 1.6 mm in recessed PVC conduit as required (make of wire Finolex / L&T/ Anchor/Havells/V-Guard/Great white/Mescab/HPL)				
a	2 x 2.5 sq mm + 1 X 1.5 sqmm	Mtr	350.00	139.8	48930.00

Signature of the "Quotationer
 With full name, date and seal

Senior Manager (Civil)
 OCCL, Ret Spillway Project

b	2 x 4 sqmm + 1 x 1.5 sqmm	Mtr	200.00	163.9	32780.00
5	Supply and fixing of following piano type switch/socket ISI marked on line existing switch board / cover including connections etc as required (make Anchor/Conal/Havells/Great white)				
a	A B holder	Each	14.00	30.85	431.90
b	Supply and fixing of porcelain base kit kat (Make-Anchor / Havells)				
6	100 Amp kit kat	Each	3.00	700.00	2100.00
7	Supply , Installation ,testing and commissioning of main switches (IS-13940 part-3/1993) of following capacity on existing surface / wall mounting and completed with HRC fuse , links, interconnections,earthing etc as required as per direction of Engineer-in-charge (Make-Seimens/HPL/Anchor/L&T/Havells/C&S/ RK)				
a	63 Amp ICTPN main switch on MS angle frame	Each	1.00	4000.00	4000.00
8	.Supply and fixing of Earthing with G.I earth pipe 3 mtr long 40mm dia ISI marked including accessories and providing masonry enclosure with cover plate having locking arrangement and watering pipe etc with charcoal and salt as required				
a	Standard earthing as per Govt. Specification	Each	4.00	2192.50	8770.00
9	Supply and fixing of following way single pole and neutral sheet steel MCB distribution board 250V on surface/recess complete with tinned copper bus bar, neutral bus bar,din bar detachable gland plate interconnections phosphalized and powder painted including earthing etc as required (but without MCB / RCCB isolator) make HPL/Havells/Legrand/L&T/C&S				
a	4 way double door	Each	4.00	1280.10	5120.40
10	Supply and fixing of 6 Amp to 32A rating 240V "B" series MCB suitable for lighting and other loads of the following poles in the existing MCB DB ISI marked compete with connections testing and commissioning etc (Make-HPL/Havells/Legrand/L&T/C&S)				
a	6 Amp rating to 32 Amp (SP) MCB	Each	16.00	80.62	1289.92
11	Supply and fixing 50 watt LED Flood light fitting (Make Havells/ Philips/Bajaj/Crompton/ Syska)	Each	20.00	8850.00	177000.00

12	Supply and fixing of 63 Amp copper TPN bus bar with suitable sheet metal encloser on MS angle frame with proper grouting on wall including all connections	Each	1.00	4700.00	4700.00
13	Supply and fixing of Exhaust fan 300 mm Heavy duty(Make-Havells/ Crompton/Bajaj)	Each	6.00	4177.20	25063.2
14	Supply and trenching of PVC armored cables ISI marked (Make-Havells/ Polycab/KEI/Mescab)				
a	10sq mm 4 core	Mtr	55.00	405.15	22283.25
15	Fixing charges Exhaust fan with making of hole on wall and all arrangement and connections	Each	6.00	154.00	924.00
16	S/F of No 8 cu wire as earth continuity	Mtr	30.00	90.00	2700.00
	Total 16 (Sixteen Item)				431596.17
				Or Say	431596.00

N.B. GST will be paid extra @ 12% or as per applicable on quoted amount

	Fillup Percentage	✓ Mark
A	My/ Our Quoted rate is % (In Word) Less than Tender value.	<input type="checkbox"/>
B	My/ Our Quoted rate is % (In Word) Excess than Tender value.	<input type="checkbox"/>
C	My/ Our Quoted rate is at par the Tender value	<input type="checkbox"/>

N.B.:- Percentage should be mentioned up to two decimal only both in figure & word in appropriate box & put ✓ mark in the box provided at right side.

Number of Correction.- _____

Number Overwriting: - _____

Signature & Seal of the Contractor/ Job worker

Signature of the "Quotationer
With full name, date and seal

Senior Manager (Civil)
OCCL, Ret Spillway Project

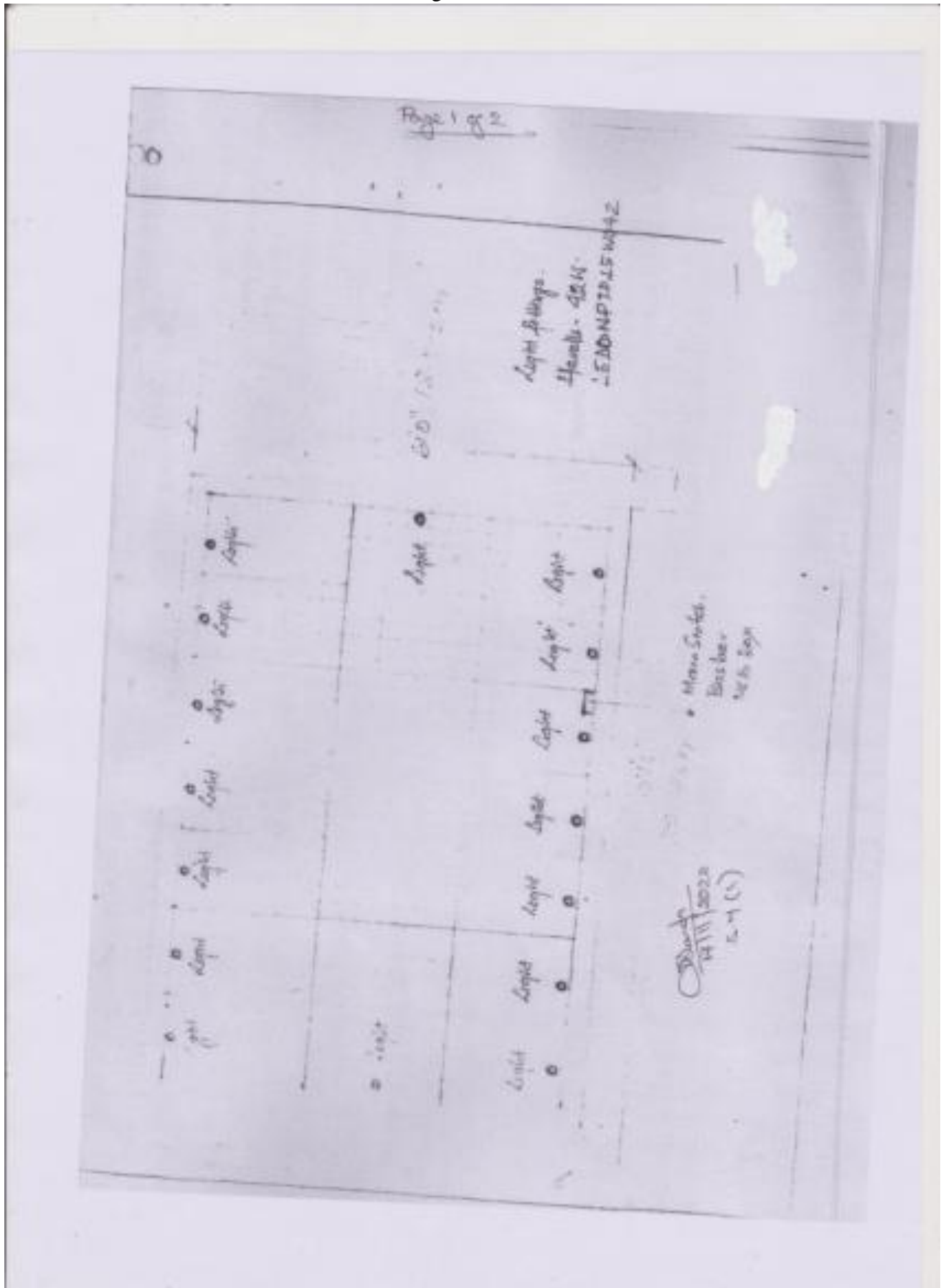

Signature of the "Quotationer"
With full name, date and seal

Senior Manager (Civil)
OCCL, Ret Spillway Project



Signature of the "Quotationer"
With full name, date and seal

Senior Manager (Civil)
OCCL, Ret Spillway Project

Signature of the "Quotationer"
With full name, date and seal

Senior Manager (Civil)
OCCL, Ret Spillway Project